

Public Involvement Handout

**Wood Co Line – WIS 97
McGivern Creek Bridge
Existing Structure: B-37-0042
Proposed Structure: B-37-0496
County T, Marathon County**

Project ID: 6667-01-00 (70)



Handout date: July 2025

Thank you for your interest in this project. We look forward to your feedback.

Purpose of handout

The Marathon County Highway Department and the Wisconsin Department of Transportation (WisDOT) are in the process of developing plans to replace the County T bridge over McGivern Creek.

The purpose of this handout is to provide information regarding the proposed improvements, describe the potential impacts it would have on the community, and offer an opportunity for public comment.

Public input/comments

Your comments assist us in developing a project that will serve the needs of the traveling public, as well as the needs of the local community and are welcomed and appreciated throughout the design process. Included at the end of this handout is a comment form that may be used for written comments regarding the proposed improvements. You are encouraged to fill out this form and return using the common form attached. Comments may also be submitted via email or phone to the contact listed below.

Project location

The project is located on County T in the town of McMillan north of Sawyer Road.

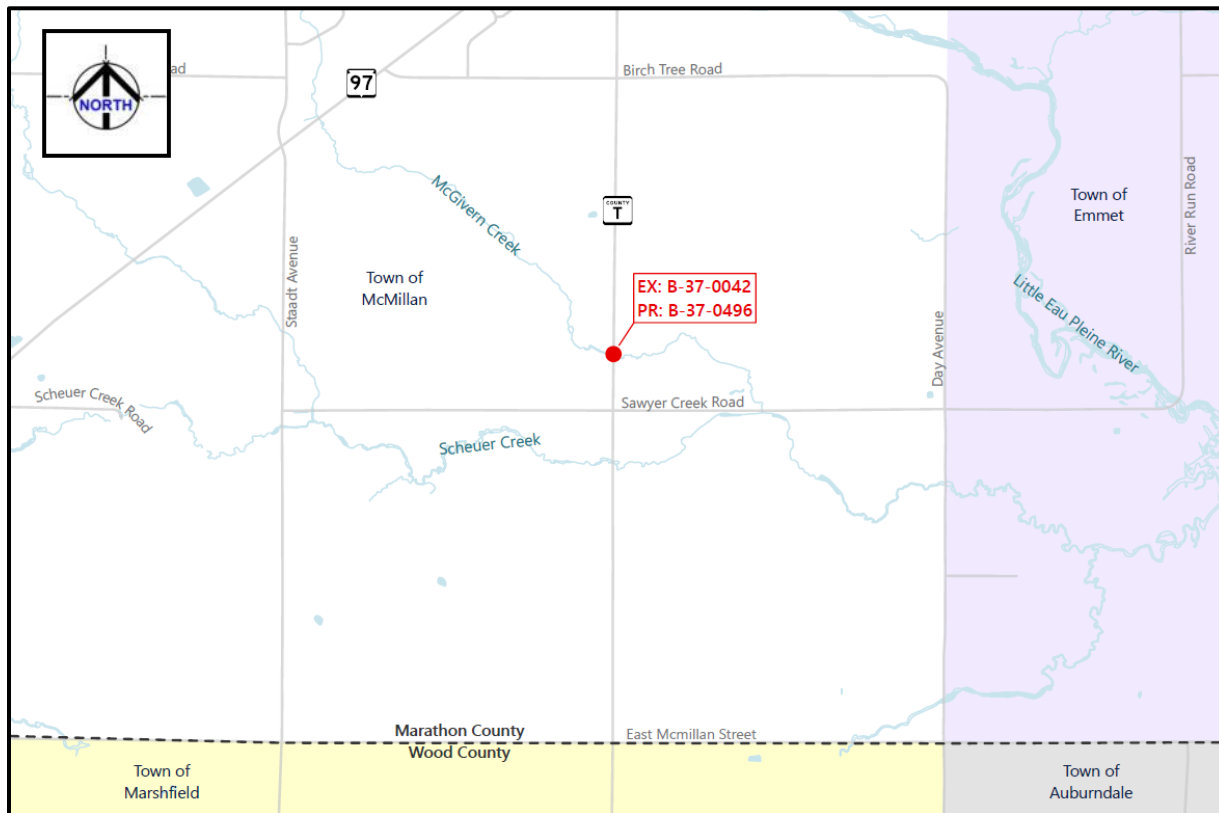

Project Location

Project purpose and need

The existing single span bridge (B-37-0042) was constructed in 1957, and the deck was overlaid with asphaltic material in 1975 and 2005.

The bridge is deteriorated throughout the structure with cracking and spalling (breaking) concrete throughout the deck including delamination on the deck edges (exposed steel), the timber abutments are showing signs of decay at the ground and waterline, and the wing walls are separating.

The existing bridge railing does not meet modern safety standards (snag curb is present).

The existing bridge has reached the end of its useful service life and cannot be economically rehabilitated.



Existing Bridge

Proposed improvements

The project is programmed as a bridge replacement project. Marathon County has received federal funding through WisDOT to replace the bridge. The Marathon County Highway Department is administering the design process.

Proposed improvements include:

- Construction of a single-span concrete slab span bridge that is approximately 39-feet long.
- Replacement of guardrails on roadway approaches to meet current standards.
- Reconstruction of approximately 110-feet of roadway approaches and shouldering replacement within the limits of new guardrail.
- New right of way and temporary easements are required to replace the bridge.

See preliminary plan of proposed improvements at the end of this handout.

Traffic impacts

- Construction is currently scheduled for 2027.
- Work will occur after June 15 due to in-water working restrictions.
- The bridge will be closed for up to three months.
- Local access to property owners and emergency services will be maintained along County T.

The County T detour will be posted along WIS 97 to County AAA to County H. See the map on the following page.

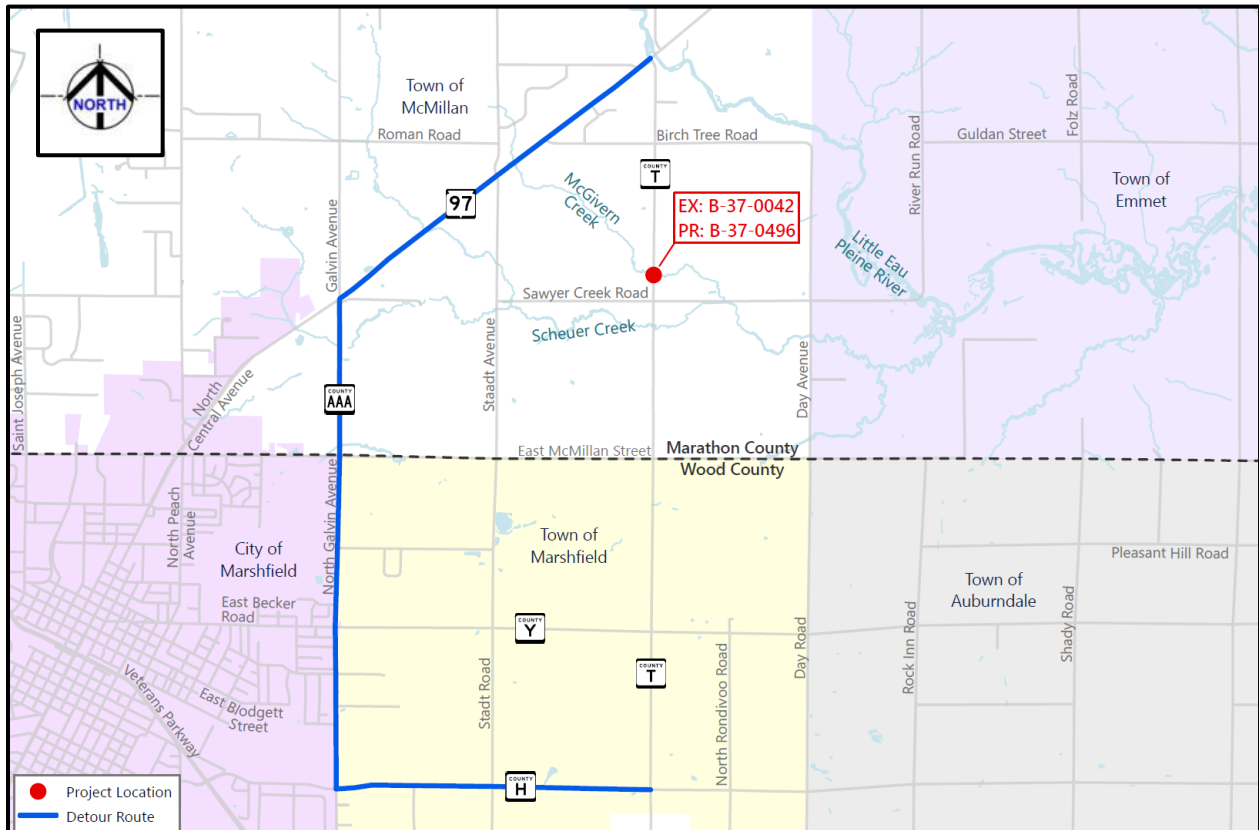

Detour Route Map

Real estate impacts

Narrow strips of additional right of way will be required for this project. This will include areas of permanent (fee) and temporary (temporary limited easement) land acquisitions to accommodate the blending of slopes on the roadway approaches and matching driveways.

Estimated right of way impacts are shown on the preliminary plans above. Marathon County expects to begin real estate acquisitions in late 2025.

A landowner rights brochure is available for property owners directly impacted.

Schedule

- Initial data collection and design development – spring 2025
- Preliminary plans – Spring 2025
- Local officials meeting – June 23, 2025
- Public involvement comment period – July/August 2025
- Environmental document – fall 2025
- Right of way acquisition – winter 2025 to summer 2026
- Final plans – August 1, 2026
- Construction – summer 2027 (June to August anticipated)

Public input/comments

Please submit comments using one of the following methods so that we receive them by **August 22, 2025**, to be considered during design.

1. Fill out the comment form attached to this document and mail to the designer.
2. Email comments or questions to the contact listed below.
3. Call the contact below.

Project contact

James Griesbach
Highway Commissioner
Marathon County Highway Department
james.griesbach@marathoncounty.gov
(715) 261-1801

Stephanie Christensen, PE
Project Manager
EMCS, Inc. (designer)
schristensen@emcsinc.com
(715) 318-9017

Fold here

Place
Stamp
Here

Stephanie Christensen
EMCS, Inc.
327 North 17th Avenue, Suite 304
Wausau, WI 54401

To mail, fold here and tape.

**MCGIVERN CREEK
BRIDGE REPLACEMENT**
 PROJECT ID 6667-01-00 (70)
 WOOD COUNTY LINE - WIS 97
 EXISTING: B-37-0042
 PROPOSED: B-37-0496
 COUNTY T
 MARATHON COUNTY



REV 2025

EXISTING RIGHT-OF-WAY
 PROPOSED RIGHT-OF-WAY
 PROPOSED TEMPORARY EASEMENT
 PROPERTY LINE
 GRADING LIMITS
 NEW PAVEMENT
 NEW BRIDGE

AERIAL PHOTO: MARATHON COUNTY 2020

MICHAEL BRONSON

TOWN OF MCMILLAN

KATHY & CHRISTOPHER FUCHS

KATHY & CHRISTOPHER FUCHS

BEGIN PAVEMENT
CONSTRUCTION

REPLACE CULVERT

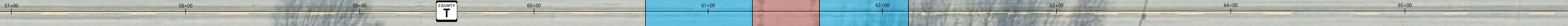

REPLACE CULVERT

END PAVEMENT
CONSTRUCTION

REPLACE CULVERT

WILLIAM & RITA WEIGEL

JEFFRY GURLER

REDFOOT INCOME TRUST
RONALD ROTHFUSZ

MCGIVERN CREEK