

OFFICIAL NOTICE & AGENDA
of a Meeting of the County Forest
Citizens' Advisory Subcommittee of the
Marathon County Board of Supervisors

COUNTY OF MARATHON
Wausau, WI 54403

A meeting of the County Forest Citizens' Advisory Subcommittee will be held at 518 S 7TH Avenue, **Rm. 089**, Wausau, WI, 54401, at **6:00pm** on **March 18, 2026**.

Members: Mike Lane (chair), Marcell Wieloch (vice-chair), John Burke, Gary Weiland, Susan Haug, Dale Heil, Paul Klocko, Greg Klos, Carmen Engelman, Taylor Dorsey, John Lauer

The meeting site identified above will be open to the public. Persons wishing to attend the meeting by phone may call into the telephone conference beginning five (5) minutes prior to the start time indicated above using the following number: Phone Number: 1-408-418-9388 Access Code: **2491 168 3051** Meeting Password: **2geC6T8HECW** Please Note: If you are prompted to provide an "Attendee Identification Number" enter the # sign. No other number is required to participate in the telephone conference. PLEASE PUT YOUR PHONE ON MUTE!

A G E N D A

- I. Minutes
 - A. Approve the Minutes of December 17, 2025, Meeting
- II. New Business
 - A. 2025 County Forest Division Annual Report
 - B. 2025 Year in Review and 2025 PRF Department Work Plan
 - C. Forestry Division Expense/Revenue Reports
 - D. 2026 Spring Timber Sales Advertised for Purchase
 - E. Parks, Recreation and Forestry Law Enforcement Annual Report
 - F. County Deer Advisory Council Meeting
 - G. Ahlstrom-Munksjo's Mosinee Mill Partial Closure
 - H. Member Items.
- III. Old Business
 - A. Winter Recreational Program Update
 - B. WCFA License Plate Available
 - C. Big Eau Pleine Archery Hunt Harvest Report
 - D. ATV/UTV Trail Maintenance for 2026
 - E. Update on the Knowles-Nelson Stewardship Program
- IV. 2026 Remaining Meeting Dates – June 17, September 16, and December 16
- V. Adjourn

Any person planning to attend this meeting who needs some type of special accommodation in order to participate should call the County Clerk's Office at 261-1500 or e-mail countyclerk@co.marathon.wi.us one business day before the meeting.

ATTN: News Department
Daily Herald and other news media

THIS NOTICE POSTED AT COURTHOUSE

| | | | |
|-------------------|---------------|-------|-------|
| Emailed/Faxed by: | Winnie Parker | Date: | _____ |
| Date: | March 9, 2026 | Time: | _____ |
| Time: | 12:00 p.m. | By: | _____ |

Members present: Mike Lane, John Lauer, Susan Haug, Gary Weiland, John Burke

Via Webex: Paul Klocko, Carmen Engleman

Members Absent Excused: Dale Heil, Greg Klos, Marcell Wieloch, Taylor Dorsey

Wausau and Marathon County Parks, Rec, and Forestry Dept. staff present: Tom Lovlien - Forest Administrator, Joe Tucker - County Forester, Jamie Polley - Parks, Recreation, and Forestry Director

The meeting was called to order at 6:00 pm by Chairman Lane.

I. Minutes

A. **Motion** by Weiland to approve December 17, 2025, minutes. Motion **carried** unanimously 7-0.

II. New Business

A. 2026 County Forest Work Plan – Lovlien gave an overview of the 2026 County Forest Work Plan. See Agenda Packet for complete work plan.

B. 2025 Fall Timber Sale Results – Lovlien gave the 2025 Fall Timber Sale Results for the September 29th bid opening. Only one bid was awarded to Smola Enterprises, 8-25; all the rest were denied for bidding under advertised value, which by law the department is not allowed to sell. On October 23 a second bid opening was held after it was advertised per county ordinance, and Beyer Enterprises was awarded tract 9-25. Tract 5-25 was sold to Jacobs at the appraised value. The two Leather Camp sales did not sell this year.

C. 2026 Parks, Recreation, and Forest Department Budget – Polley gave an overview of the 2026 Parks, Recreation, and Forest Department Budget.

D. Winter Recreation Program Update – Lovlien presented the Winter Recreation Program Update – January 10, the Ski race is back. On February 5-8 is the Special Olympics. 5K run returning this summer. The CWOC is coming back for the bike race June 5-6. The Trek Bike Race is coming back June 11-14, and Wausau 24 is coming back July 22-26. There will be two cross country races September 1-3. Ragnar is scheduled to return September 14-20.

E. Nine Mile Forest Winter Events – Lovlien presented the Nine Mile Forest Winter Events – Nine Mile is currently open for cross country skiing, fat tire biking, and snow shoeing. The Mountain Bay snowmobile trail going from Shawano County all the way to the Kelly Club is open.

F. Confirmed Oak Wilt Pocket in Nine Mile Forest along Cross-country Ski Trail – Lovlien confirmed an Oak Wilt pocket in Nine Mile Forest along Cross-country Ski Trail on R about one hundred feet from the ski trail edge. To contain the Oak Wilt, the oaks in that area will be Girdled and killed, probably in June of 2026.

G. Update on Reauthorization of the Knowles-Nelson Stewardship Program – There is a two-year extension proposed for the Knowles-Nelson Stewardship Program that does not seem to be getting any traction in the legislature. Marathon County has taken advantage of the Knowles-Nelson Stewardship Program for six county forest properties equaling almost one million dollars.

H. Bitzke Birdwalk Repairs Schedule for 2026 – Bitzke Birdwalk repairs scheduled for 2026 are updating signage, observation deck repairs, some replacing of board walks, bridge work, and adding rock7 to keep it safe for all users.

I. Tilleda Chip Mill Purchased by Logging Co-op – A logging co-op called Timber Professionals Cooperation Enterprises, the first of its kind in the country, made up of loggers and truckers, purchased a mill in Tilleda, WI for \$418,000. The Wisconsin County Forest Association contributed \$5000 from their funds to help pay for the purchase to open another small market in the area. They are currently producing pulp for Ahlstrom, and they hope to grow by adding more products in the future.

J. Member Items – Marathon County Member Items: Saturday, the Bird Club is participating in the Audubon Bird Club Bird Count. Brad Mroczenski coordinates snow dog training every year. The new mechanic, once hired, should also be trained as well. Nordic is no longer coordinating ski lessons this year. The registration and coaches are already in place; a coordinator is still needed. Joe Tucker is going to be making a map that indicates all the different trails and their intersections along with QR codes. In the event of an emergency, people can be reached in a timely manner. Tucker will coordinate trail updates with CWOCC. There are ATV trail maintenance questions regarding Burma Trail now that the Mid-Wisconsin Trail Blazers are no longer going to maintain this trail. A meeting is being set up with the Eau Pleine River Rats in the interim to continue maintenance until a long-term solution can be resolved.

III. Old Business

A. 2025 Ragnar Trail Wisconsin Update and Future Events – In 2024, Ragnar had 1,649 participants and in 2025 they had 1,785 participants. They have been sent a new three-year contract which requires Ragnar to pay a larger amount upfront.

B. 2025 Gun Deer Harvest and Activity in County Forest – 2025 Gun Deer Harvest and Activity in County Forest saw a 1.12% decline in license sales statewide and 1% decline in harvest.

C. Big Eau Pleine Park Archery Hunt – Big Eau Pleine Park Archery Hunt opened November 15 and goes through January 4. There has not been any reporting as to how many deer have been harvested.

D. 2026 Likely Timber Sale Harvest at Nine Mile – It would be helpful for Tom Lovlien or Joe Tucker to attend a CWOCC meeting in the spring to help educate the members on forestry practices and remind them that Nine Mile is a Forestry Unit and not a park. Also let them know that there will be a 2026 Timber Sale Harvest at Nine Mile likely this spring or summer.

IV. 2026 Tentative Meeting Dates – March 18, June 17, September 16, and December 16, 2026

V. Adjourn

A. Motion to adjourn by Wieloch. Motion **carried** unanimously 7-0. Meeting adjourned at 7:30 pm.

Thomas Lovlien - Secretary

Wausau and Marathon County Parks, Recreation, and Forestry Department

2025 County Forest Division Annual Report

January 1, 2025 - December 31, 2025

Program Highlights:

- Net timber sale revenue to Marathon County of \$398,342.92.
- Total net revenue for the Forestry Division program was \$471,534.00 and expenses were \$330,677.00.
- Repaid \$93,342.92 of the \$110,000.00 loan for the ice arena upgrades. Remaining is scheduled to be paid back in 2026.
- Practiced sustainable forestry on 966 acres on the Marathon County Forest. This is based on closed out sales with DNR in 2025.
- Continued research on the possibility of harvesting clay off County Forest lands for use at the Solid Waste Department landfill.
- Completed a day long County forest tour for several members of the Forestry/Recreation Committee, additional County Board members and members of the public.
- Completed a third-party Sustainable Forest Initiative (SFI) Certification field audit that showed County Forest management meets all standards.
- Received 692.50 hours of WDNR technical and field assistance in completing work on the Marathon County Forest.
- Continued research on the possibility of entering the carbon market, however there were limited opportunities in 2025.
- Continued participation as a member of the Wisconsin County Forests Association Forest Legislative/Certification and other Committees.
- Implemented the 15-year County Forest Comprehensive Land Use Plan 2021-2035 adopted by the County Board and Department of Natural Resources.
- Continued participation in the County Forest Administrator grant program that funds one-half the salary and fringe benefits of the Forest Administrator position.
- Regulated uses at Nine Mile County Forest Recreation Area to allow all user groups to have safe and quality recreation experiences.

Land Holdings:

Acreage in 2025:

| | |
|-------------------------------------------|---------------|
| County Forest - Regular County Forest Law | 30,082.53 |
| County Forest - Special County Forest Law | <u>631.77</u> |
| Total County Forest | 30,714.30 |

Other Land Holdings:

| | |
|--------------------------------|--------------|
| Parking & road access | 8.59 |
| McMillan Marsh Lease (DNR) | 1,661.40 |
| Under water, island & wetlands | 192.74 |
| Railroad ROW/Snowmobile Trail | <u>85.04</u> |
| Total Other Lands | 2,027.77 |

Total Lands Managed: 32,662.07 Acres

Timber Management, Cultural Projects, and Reforestation:

Timber Sales:

Timber sales generated 18,037 pulpwood cords and 806,000 board feet of logs worth \$569,061.31 unaudited) in 2025. The following is a list of the gross value of timber cut from the forest over the past 10 years:

| | | | |
|------|--------------|------|--------------|
| 2016 | \$531,022.66 | 2021 | \$653,057.25 |
| 2017 | \$347,274.04 | 2022 | \$790,142.87 |
| 2018 | \$714,895.21 | 2023 | \$495,763.54 |
| 2019 | \$845,383.37 | 2024 | \$785,262.85 |
| 2020 | \$528,411.64 | 2025 | \$569,061.31 |

Marathon County Forest
Timber Sales Annual Gross Revenue – Cut and Hauled

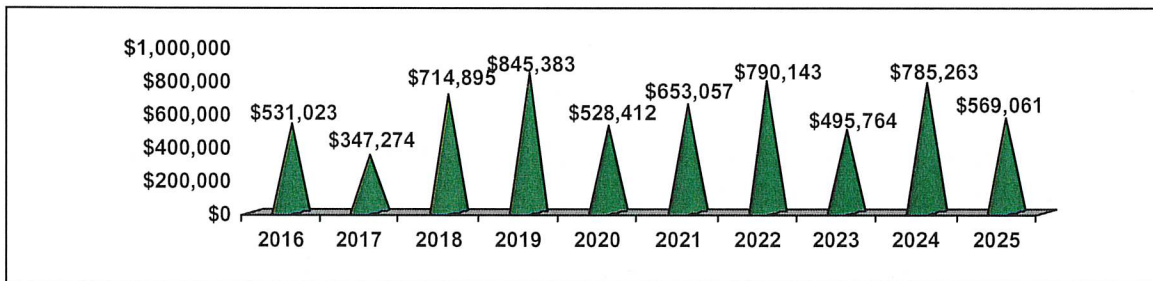

Other Timber Sale Data:

New sales – 9 were established on 619 acres with 11,144.59 cords appraised at \$305,625.00.

Marathon County Forest**Timber Sales Annual Sold Value**

1. Sold sales – 7 of 9 advertised sales were sold on 508 acres in 2025 for a bid value of \$310,779.75.

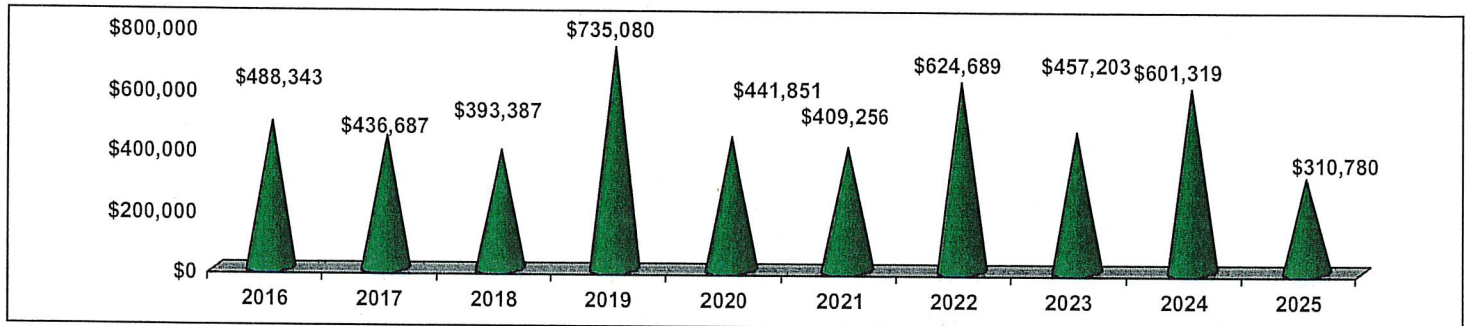

2. Uncompleted timber contracts on County Forest lands – 17 on 1328 acres with 32,163 cord equivalents worth \$877,024.39.
3. Uncompleted timber contracts on County Park Lands – 1 on 79 acres with 1375 cord equivalents worth \$53,180.00.
4. Cut volume reports filed with DNR (form 2460):
 - Final reports – 14 sales worth \$887,197.32.
 - Partial reports - 0 sales worth \$0.
5. Severance paid to DNR on interest free loans \$177,439.46.
6. Severance Tax Escrow for Town payments (10% of gross receipts) \$56,906.13.
7. Firewood permits – 8 permits were issued worth \$240.00.
8. New sale establishment – evaluated 638 acres for potential sale (established 619 acres).
9. Forest reconnaissance – updated 2464 forested acres, 39 non-forested acres.
10. Administered 17 different timber sales throughout the year on County Forest lands.
11. Administered a 14-acre Solid Waste Department timber sale.
12. Completed a forest type inventory of all remaining Solid Waste Department lands that haven't been harvested in previous years' timber sales.

Cultural Projects:

1. Classified forest habitat types on 112 acres for inclusion in our GIS database.
2. Monitored for additional oak wilt areas in Nine Mile and Kronenwetter Forest Units.
3. One new pocket of oak trees infected with oak wilt fungus was identified. Treatment and removal of these trees will occur at Nine Mile in the spring of 2026. Monitoring for new pockets infected with the fungus will continue to occur.
4. Scarified approximately 25 acres of the forest floor to prepare the site for seedling germination at Burma Road Forest Unit using DNR heavy equipment.
5. Treated multiple small areas of invasive species on County Forest lands.
6. Completed deer browse surveys at Big Eau Pleine County Park. This will continue in 2026 and beyond.
7. Completed deer browse surveys on 57 acres of the Marathon County Forest.
8. Assisted Park Operations on garlic mustard treatment at Big Eau Pleine Park.
9. Treated garlic mustard areas at Burma Road Forest Unit.

Reforestation:

1. No planting was needed in 2025 as all stands were fully stocked and growing well.

Road, Trail, and Facility Construction and Maintenance:

1. APHIS trapped 15 beavers and removed 15 total dams at problem locations in the county forest. This does not include beaver removed by APHIS utilizing the DNR Cooperative agreement.
2. Replaced 2 culverts at Kronenwetter Forest Unit and added granite at problem locations.
3. Completed an inventory of culverts with GPS location and condition at Ringle Forest Unit that will be used to determine maintenance and replacement schedules.
4. Added granite and breaker rock to improve a section of trail in Nine Mile Forest Unit for an upcoming spring 2026 timber sale.
5. Improved and widened a trail along a narrow corner in Kronenwetter Forest Unit used for logging access.
6. Brushed approximately 5 miles of roads and trails in the Bern, Burma and Nine Mile Forest Units.
7. Placed approximately 75 yards of granite and breaker rock in the Nine Mile Forest Unit along the snowmobile and ski trails to fix erosion issues.
8. Completed repairs to dikes and water control structures from muskrat and beaver damage.
9. Reconstructed several segments of Nine Mile ski trails to improve drainage and level the surface including repairs to several sections due to heavy use and erosion.
10. Performed normal maintenance on 190 miles of forest roads and trails.
11. Graded and placed material on several sections of the Burma Road ATV trails to prevent erosion.
12. Inspected County Forest boundaries to control encroaching land uses.
13. Repaired gates on roads and trails that access the County Forest.
14. Repaired deer exclusion fences at Big Eau Pleine Park. These were installed to collect data on deer browsing.

Administration:

1. Continued the utilization of the DNR forestry reconnaissance program (WisFIRS).
2. Collaborated with the Central Wisconsin Off-Road Cycling Coalition on summer mountain biking and winter fat tire biking and monitored the responsibilities of CWOCC and the County as outlined in the 2024-1019 maintenance agreement.
3. Developed policy and implemented principals of Forest Certification - Sustainable Forestry Initiative (SFI) on the Marathon County Forest.
4. Participated in several Wisconsin County Forests Association committee meetings to prioritize Legislative action items in the next 2027-2029 biennial State Budget.
5. Continued research on carbon credit markets and how enrolling may net additional revenue for Marathon County. Research may continue in 2026.
6. Implemented the County Forest Comprehensive Land Use Plan 2021-2035.
7. Located and assisted in the purchase of approximately 139 cords of firewood for campers for use at the County Park campgrounds.
8. Our Recreational Deputies along with assistance from the County Forester confiscated a total of thirteen illegal tree stands. They investigated complaints of vehicle, vandalism, illegal dumping, and criminal activities, issuing two ordinance violations and numerous warnings. At Nine Mile Forest Unit, Deputies conducted patrols checking for cross-country skiing and mountain bike passes also issued multiple warnings. Completed an additional 197 regular patrols at the forest units.
9. Issued four ATV/UTV disabled person access permits to people with disabilities for County Forest access.
10. Held quarterly meetings with the Forest Citizen's Advisory Subcommittee to discuss forestry and recreation issues.

Wildlife and Fisheries Management:

In cooperation with the Wisconsin Department of Natural Resources:

1. Maintained 17 flowages. Drawdowns of several flowages will occur in 2026 to create better habitat and provide food for waterfowl.
2. An initial meeting was held between the PRF Department staff and WDNR Wildlife Biologist to discuss future flowage management maintenance and costs associated as the flowage structures are beginning to fail. More meetings will be held in 2026 to determine specific responsibilities.
3. Mowed forest openings, Nine Mile and Harrison-Hewitt Forest Unit flowage dikes and the Bitzke Bird Walk trail.
4. Mowed most forest unit trails that are suitable for mowing.
5. Several forest openings in the forest units were mowed. Mowing will continue on openings in 2026 at the same time as the forest trails.
6. Poor winter conditions prevented shearing of tag alder to create habitat for grouse, woodcock, and other early successional species. Due to a change in DNR priorities no shearing will occur in 2026.
7. Removed cattails in front of the water control structure at Bern Forest Unit utilizing Federal Emergency Management Agency (FEMA) funding. Removal of additional cattail masses will likely continue in 2026 and beyond however funding will need to be appropriated as FEMA dollars will be all used up.
8. Seeded 70 lbs. of wild rice in flowages at the Harrison-Hewitt Forest Unit.
9. Testified in favor of additional antlerless tags to the County Deer Advisory Council (CDAC) to reduce the deer population in areas of County Forests with tree regeneration problems.
10. An engineer completed a required DNR 10-Year inspection on the Bern Dam the summer of 2023. The DNR concurrence letter on maintenance was finally received in June 2025 and several required maintenance items were completed by PRF staff and WDNR Wildlife. Ducks Unlimited agreed to set a staff gauge and benchmark in 2026. This will complete the required maintenance.

Recreation:

Nine Mile County Forest Cross Country Ski Trails:

The 2024-2025 ski season opened on February 5, 2025, and closed for the season on February 27, 2025. It was once again one of the shortest seasons on record as minimal snow fell and record warm temperatures. The Wausau Nordic Ski Club did not offer free adult ski lessons on Tuesday evenings in January because of the short season. The Snekkevik ski race, Badger State Games, Stomp the Swamp Snowshoe, Special Olympics and the Winter Triathlon race were not held in 2025. A total of 952 daily and 142 annual ski passes were sold. Additionally, 164 daily and 12 annual snowshoe passes were sold with revenues totaling \$22,764.76.

Ski Trail, Snowshoe and Bike Trail Maintenance at Nine Mile Forest Unit:

1. Brushing of all trails is ongoing, and the efforts of the volunteers are greatly appreciated.
2. Volunteers from the Nordic Ski Club sponsored workdays in October. They performed tasks such as rock picking, lifting trees and brushing trails.
3. Trail signs were inspected, damaged trail signs replaced, and some new signage was added. This work will continue in 2026 as the signage is evaluated and updated.
4. Additional winter fat tire biking signs were installed to help users follow the trail.

Mountain Biking at Nine Mile Forest Unit:

The 2025 summer mountain bike season opened at noon on May 1, 2025. The bike trails closed as scheduled on October 15. The 2024-2025 winter bike trails opened January 8, 2025, and closed on February 24, 2025. There were three Mountain Bike events held at Nine Mile in 2025: The Wisconsin Off Road Race Series (TREK), Wausau 24, and the Iron Bull Adventure Challenge with \$20,254.97 in revenue. A total of 687 summer daily passes, 336 summer annual passes and 76 yearly annual bike passes were sold in 2025. Winter fat tire bike season totaled 29 daily, and 44 annual passes sold.

Total receipts associated with all mountain biking in 2025 totaled \$20,986.82. Central Wisconsin Off-Road Cycling Coalition continues to be a great partner in maintaining the trail system. Volunteers donate many hours of their time to maintain the single-track trails.

Other Recreation:

1. Four cross country running races were held at Nine Mile in 2025 with \$1,720.00 in revenue.
2. The Ragnar Relay Series running race was again a popular venue at Nine Mile with 200 standard, 17 ultra, 42 black loop and 11 sprint-teams totaling 1,785 participants and \$23,932.90 in revenue.
3. Issued 18 undesignated camping permits for county forests in 2025 resulting in \$426.60 in revenue.
4. The number of people using all County Forest Units continues to increase. Activities such as hiking, dog walking, berry picking, and horseback riding are growing.

Recreational GIS Mapping:

1. Created six maps to go along with the access permits for landowners crossing County Forest to access their private lands.
2. Created several Nine Mile Forest Recreational trail maps.
3. Created several boat landing maps for the Park Division.
4. Created a Big Eau Pleine map identifying areas infected with garlic mustard.

Snowmobile Trails:

1. Trails were open for a total of 10 days during the 2024-2025 season. Looking back 30 years, the seasonal average has been just under 45 days.
2. Seven local snowmobile clubs' contract with Marathon County to groom, sign, brush and perform other work related to maintaining the trail system on County Forest property.
3. Clubs are responsible for signing the trails to DNR specifications as well as meeting any requirements set forth by the Parks, Recreation and Forestry Department and WCFA standards.
4. A new trail map was printed for the 2025-2026 season. Marathon County saw several reroutes and trail changes that necessitated a new county map. The Marathon County Snowmobile Advisory Council funds the map through ad sales. A discount was given to former advertisers from the last map printed due to the lack of snow in previous seasons.
5. Printed trail maps are made available at numerous locations throughout Marathon County.
6. Marathon County snowmobile clubs continue to receive financial assistance for trail maintenance from the Snowmobile and ATV Aids Programs through grants administered by the Parks, Recreation and Forestry Department and disbursed by the DNR.
7. The snow and trail conditions hotline will continue to be used in the 2025-2026 season and moving forward. A recording is now available as an option on the Parks, Recreation and Forestry Department phone tree. This was due to numerous requests by the public and local businesses. The message will be updated by the Motorized Recreation Coordinator to keep the public up to date on conditions and any trail closures. This recording provides an overview of the trail conditions, a more extensive trail report is found on the Marathon County website.
8. Current trail conditions are also updated by the Parks, Recreation and Forestry Department on the Marathon County website, on Facebook and the Travel Wisconsin website.
9. The Snowmobile Automated Reporting System (SNARS) became mandatory for all snowmobile clubs statewide with the 2017-2018 season. SNARS is a computer program that was developed to improve the accurate and timely reporting of County trail maintenance expenses and other data to the DNR.

10. The Global Positioning System (GPS) requirement in all groomers became mandatory by the 2021-22 season. This was a requirement by DNR and the Governor's Snowmobile Council. All 28 of the clubs in Marathon County are online with the GPS units. The system was implemented for greater accuracy of trail mileage and to track trail grooming.

Burma Forest ATV/UTV Trails:

1. Summer trails were maintained using part of the \$20,750.00 of State ATV/UTV trail maintenance funds. The club continued to maintain trails at a high standard during the past season.
2. The Mid-Wisconsin Trailblazers ATV Club, through a contract with Marathon County, is responsible for the routine maintenance of 11 miles of summer ATV/UTV trails.

Public Outreach/Professional Development:

1. Forest Administrator served as a member of the Wisconsin County Forests Association Legislative/Certification, Personnel, Budget, Dues and Bylaws and Roads Committees.
2. Attended several in-person and virtual Marathon County, Society of American Foresters, Wisconsin County Forests Association and Forest Certification training sessions.
3. County Forester completed Marathon County training programs including active listening, power of contagiousness and de-escalation for non-law enforcement training.
4. Attended the Imagine 2025 staff enrichment training.
5. Analyzed plant samples for insect and disease problems.
6. Interviewed by media on forestry related issues.
7. Created interpretive displays to educate the public about the benefits of sustainable forest management.

Budget Summaries (available upon request)

Forest Resources:

County Forest Program
 County Forest Administrator
 County Forest Road Aids
 County Conservation Aids
 FEMA Cattail Removal
 Sustainable Forestry
 Segregated Land
 Wildlife Habitat
 Forestry State Aid
 Knowles-Nelson Stewardship

Debt Redemption:

General Debt - Aid to County Forest

Recreation:

Burma Trail ATV 24-25
 Cross-Country Ski Trails
 General Fund - Snowmobile Coordinator
 Snowmobile Grant 24-25



County Small Projects

- Marathon Park Fence Repairs (Sections)
- SunnyVale concession updates
- SunnyVale dugout and score booth upgrades
- BEP main roadway sealant
- Bluegill Bay boat launch asphalt
- DEC group campground well
- BEP campsite upgrades
- DEC manager campin update

City CIP Projects

- Memorial Park roads and parking lots
- Reinstall refurbished modular skate park ramps
- Address 10th St retaining wall

County CIP Projects

- Marathon Park Splash Pad
- Lulu B Jacobs Park reestablishment
- Install Restrooms at Rib Falls and DEC

Financial Sustainability Plan



Plans/Grants to Complete

- County CORP Update
- Rib Falls Master Plan
- AED/Save Station Grant

City Small Projects

- Kaiser Slide Restoration
- Riverlife NE Park Sign
- Isle of the Ferns Limestone Trail
- 3M trail reconstruction
- Pool feature repairs/replacements
- Replace concrete under Pleasant View shelter
- Surface restoration of Forest Park Tennis Court/Pickleball

Urban Forestry

- Treat, remove & plant ash trees
- Manage UF Grant

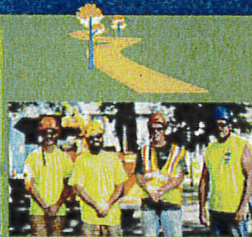

Install 2 additional AED Save Stations

County Forestry Work Plan



- Administer 17 timber sales on 1411 acres
- Apply herbicide to newly planted red pine trees on 60 acres
- Establish and advertise 600-625 acres of timber for sale
- Rebuild retaining walls at Duane Corbin Shooting Range
- Complete improvements at Bitzke Bird Walk Nature Trail

Enhanced/New Recreation Programs

Secure Field Sponsors Peoples Sports Complex

Other Projects

- Install plaque at Athletic Park ADA parking
- Continue Barker Stewart Island Vegetation
- County Materials 3rd grading/seeding of Rib Falls
- Riverlife Concession Stand Lease
- Long-term plan for County Ice Arena

Admin office long-term location



Parks, Recreation
& Forestry

2025 Year in Review



CITY PARK PROGRAMS & PROJECTS

- COMPLETED THE CONSTRUCTION OF THE SKATE PARK
- INSTALLED CAMERA SYSTEM AT ATHLETIC PARK
- UPDATED THE ATHLETIC PARK CLUBHOUSE TO SERVE BASEBALL AND SOFTBALL
- REPAIRED A LARGE WATER BREAK IN THE BROCKMEYER PARK RESTROOMS
- INSTALLED NEW PECKHAM WAY SIGNAGE ON RIVER EDGE TRAIL
- INSTALL LOUVERED FENCE AT RIVERLIFE CONCESSION STAND TO PROMOTE EFFICIENT HEATING/COOLING
- SECURED SHORT TERM LEASE WITH PHO ZONE FOR SUMMER RIVERLIFE CONCESSION STAND OPERATIONS
- INSTALLED AN ACTUATOR ON THE 400 BLOCK FOUNTAIN
- 23,338 BOULEVARD TREES, REMOVED 370 ASH TREES, CHEMICALLY TREATED 791 ASH TREES AS PART OF THE 15 YEAR EMERALD ASH BORER MANAGEMENT PLAN
- PLANTED 480 TREES, REMOVED 400 NON-ASH TREES, PRUNED 5,500 TREES
- GRANTED \$100,000 TO PRIVATE ASH TREE REMOVALS AND PLANTED 415 TREES WITH A WIDNR GRANT.
- COORDINATED AND SUPPORTED ARBOR DAY CELEBRATION AND OTHER COMMUNITY PLANTING PROJECTS INCLUDING FRUIT ORCHARD PLANTINGS AT CITY PARKS PLANTING 22 TREES
- REPLACED THE STONE CAP AND TUCKPOINTED WALLS AT STEWART PARK
- DEDICATED THE STEWART PARK STAGE TO MADAM KARKAR
- MODIFIED THE TRAFFIC PATTERN AND FIXES PONDING ISSUES AT SYLVAN TUBING HILL
- WESTVIEW TERRACE PARK: CELEBRATED EARTH DAY BY PLANTING 22 FRUIT TREES
- 2 ROUNDS OF GOAT INVASIVE VEGETATION MANAGEMENT AT BARKER STEWART ISLAND
- OFFERED 200 SWIM LESSON CLASSES FOR 662 STUDENTS ENROLLED THROUGHOUT THE SUMMER.
- PROVIDED TENNIS LESSONS TO 80 PARTICIPANTS
- CONTINUE TO ADD NEW ADOPT-A-PARK MEMBERS TOTALING 8 ADOPTERS.
- HOSTED OUR SECOND DOWNTOWN TRICK OR TREAT IN PARTNERSHIP WITH THE RIVER DISTRICT
- COMPLETED THE PARKING LOT ADJACENT TO ATHLETIC PARK FOR ACCESSIBLE PARKING
- FINALIZED USE AGREEMENT FOR THE NEW COLLEGIATE SOFTBALL CLUB - WAUSAU IGNITE UTILIZING ATHLETIC PARK
- HUNG 10 SELF WATERING FLOWER BASKETS AND MAINTAINED FLOWERS AT 40 LOCATIONS

COUNTY PARK/FOREST PROGRAMS & PROJECTS

- HOSTED COUNTY FOREST TOUR FOR COUNTY BOARD AND OTHERS
- DEMOLITION AND INITIAL INSTALLATION OF NEW SPLASH PAD
- INSTALLED MAT SYSTEM IN RINK 2 AND UPDATED REFRIGERATION ROOM OF ICE ARENA
- SUCCESSFULLY PARTNERED WITH THE FAIR TO PROVIDE FAIR OPERATIONS
- NEW PLAYGROUND EQUIPMENT INSTALLED AT BIG RAPIDS PARK AND RIB FALLS PARK
- ICE ARENA FEASIBILITY STUDY AND ECONOMIC IMPACT STUDY PRESENTED TO COUNTY EXEC COMM
- BROUGHT IN \$7781 IN NEW REVENUE FROM OFFERING SWIM LESSONS DURING THE SUMMER AT NCHC
- CONTINUED WATER EXERCISE CLASS YEAR-ROUND AT NCHC TOTALING \$7,008 IN REVENUE
- \$1,500 SPONSORSHIP SECURED FROM KIWANIS FOR EASTER EGG HUNT
- OUTDOOR ADVENTURE CAMP INCREASED FROM 20 KIDS IN 2024 TO 27 KIDS IN 2025
- SECURED \$3,500 OF SPONSORSHIPS TO THE 51ST CHILDREN'S FESTIVAL
- CHEROKEE PARK RESTROOM INSTALLATION WAS COMPLETED
- NINE MILE SEPTIC SYSTEM REPLACED, PELLET BOILER LINES REPLACED, NEW ROOF, FASCIA AND SOFFIT ON CHALET, RENOVATED RESTROOMS FOR MEET ADA REQUIREMENTS
- FINALIZED INSTALLATION FOR NEW DUMP STATION AT DELLS OF EAU CLAIRE PARK
- HELD 3RD ARCHERY DEER HUNT AT BIG EAU PLEINE PARK
- COUNTY MATERIALS ADVANCED RECLAMATION WORK AT RIB FALLS PARK, COMPLETING ANOTHER ROUND OF GRADING AND SEEDING. EFFORTS WILL CONTINUE TOWARD FINAL CLOSURE OF THE MINING PERMIT.
- EXPANDED RECREATION OFFERINGS BY TAKING OVER THE SUMMER YOUTH SOCCER LEAGUE AND LAUNCHING A NEW SUMMER ADVENTURE PROGRAM. CORE PROGRAMMING CONTINUES TO INCLUDE THE SUMMER PICKLEBALL LEAGUE, WINTER BROOMBALL, SWIMMING LESSONS, WATER EXERCISE, AND THURSDAY MOVIES IN THE PARK.

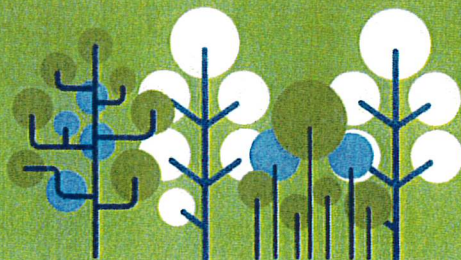

CAMPING

Camping is the Department's
3rd Largest Revenue Source
Gross Revenue \$312,134

1.5% 

Increase in Revenue Over 2024
Season Gross Revenue

2016-2025 FORESTRY DIVISION EXPENSE/REVENUE REPORT

| Year | Gross Timber Sold Amount | Net Timber Sold Amount | Acres | Timber Revenue Even-Flow Budget | Net Timber Revenue Actual ¹ | Other Revenue ² | Total Revenue | Expenses ³ | Program Net |
|--------|-----------------------------------|---------------------------------|-------|------------------------------------------|----------------------------------------------|-------------------------------|------------------|-----------------------|-------------|
| 2016 | \$488,343 | \$341,840 | 666 | \$245,000 | \$371,716 | \$58,385 | \$430,101 | \$341,930 | \$88,171 |
| 2017 | \$436,687 | \$305,681 | 520 | \$245,000 | \$243,092 | \$60,606 | \$303,698 | \$343,106 | (\$39,408) |
| 2018 | \$393,387 | \$275,371 | 709 | \$245,000 | \$500,427 | \$58,068 | \$558,495 | \$359,452 | \$199,043 |
| 2019 | \$735,080 | \$514,556 | 644 | \$245,000 | \$591,768 | \$59,779 | \$651,547 | \$354,742 | \$296,805 |
| 2020 | \$441,851 | \$309,296 | 662 | \$245,000 | \$369,888 | \$63,308 | \$433,196 | \$359,929 | \$73,267 |
| 2021 | \$409,256 | \$286,479 | 633 | \$245,000 | \$457,140 | \$77,932 | \$535,072 | \$344,560 | \$190,512 |
| 2022 | \$624,869 | \$437,409 | 623 | \$275,000 | \$553,124 | \$74,727 | \$627,851 | \$378,857 | \$248,994 |
| 2023 | \$457,203 | \$320,042 | 587 | \$305,000 | \$347,034 | \$96,107 | \$443,142 | \$333,679 | \$109,463 |
| 2024 | \$601,319 | \$427,916 | 596 | \$305,000 | \$549,684 | \$72,730 | \$622,054 | \$325,183 | \$296,871 |
| 2025 | \$310,780 | \$217,546 | 508 | \$305,000 | \$398,343 | \$73,191 | \$471,534 | \$330,677 | \$140,857 |
| TOTALS | \$4,898,775 | \$3,436,136 | 6148 | \$2,660,000 | \$4,382,216 | \$694,833 | \$5,076,690 | \$3,472,115 | \$1,604,575 |

¹ Revenue to Marathon County after 20% payment to State for loans and 10% payment to townships

² Includes County Forest Administrator grant, firewood permits, camping fees, bond recovery and misc. revenues

³ Includes all personnel and operating expenses

2004-2025 FORESTRY DIVISION EXPENSE/REVENUE REPORT

| Year | Gross Timber Sold Amount | Net Timber Sold Amount | Acres | Timber Revenue Even-Flow Budget | Net Timber Revenue Actual ¹ | Other Revenue ² | Total Revenue | Expenses ³ | Program Net |
|--------|-----------------------------------|---------------------------------|-------|------------------------------------------|----------------------------------------------|-------------------------------|------------------|-----------------------|-------------|
| 2004 | \$495,726 | \$347,008 | 796 | \$190,000 | \$203,189 | \$44,886 | \$248,075 | \$312,769 | (\$64,694) |
| 2005 | \$459,350 | \$321,545 | 605 | \$190,000 | \$240,115 | \$47,289 | \$287,404 | \$296,549 | (\$9,145) |
| 2006 | \$275,111 | \$192,578 | 586 | \$190,000 | \$356,346 | \$50,841 | \$407,187 | \$327,691 | \$79,496 |
| 2007 | \$344,274 | \$240,992 | 707 | \$213,000 | \$514,204 | \$54,656 | \$568,860 | \$345,131 | \$223,729 |
| 2008 | \$318,189 | \$222,732 | 641 | \$213,000 | \$339,896 | \$53,529 | \$393,425 | \$322,621 | \$70,804 |
| 2009 | \$321,155 | \$224,809 | 619 | \$213,000 | \$203,327 | \$55,849 | \$259,176 | \$350,989 | (\$91,813) |
| 2010 | \$411,312 | \$287,918 | 622 | \$213,000 | \$368,270 | \$56,986 | \$425,256 | \$344,442 | \$80,814 |
| 2011 | \$374,005 | \$261,804 | 551 | \$213,000 | \$293,943 | \$60,870 | \$354,813 | \$357,721 | (\$2,908) |
| 2012 | \$356,678 | \$249,675 | 548 | \$213,000 | \$226,203 | \$57,170 | \$283,373 | \$346,272 | (\$62,899) |
| 2013 | \$298,173 | \$208,721 | 543 | \$213,000 | \$333,986 | \$53,239 | \$387,225 | \$308,336 | \$78,889 |
| 2014 | \$716,996 | \$501,897 | 578 | \$213,000 | \$170,006 | \$98,093 | \$268,099 | \$342,956 | (\$74,857) |
| 2015 | \$531,420 | \$371,994 | 596 | \$245,000 | \$46,457 | \$57,908 | \$104,365 | \$345,387 | (\$241,022) |
| 2016 | \$488,343 | \$341,840 | 666 | \$245,000 | \$371,716 | \$58,385 | \$430,101 | \$341,930 | \$88,171 |
| 2017 | \$436,687 | \$305,681 | 520 | \$245,000 | \$243,092 | \$60,606 | \$303,698 | \$343,106 | (\$39,408) |
| 2018 | \$393,387 | \$275,371 | 709 | \$245,000 | \$500,427 | \$58,068 | \$558,495 | \$359,452 | \$199,043 |
| 2019 | \$735,080 | \$514,556 | 644 | \$245,000 | \$591,768 | \$59,779 | \$651,547 | \$354,742 | \$296,805 |
| 2020 | \$441,851 | \$309,296 | 662 | \$245,000 | \$369,888 | \$63,308 | \$433,196 | \$359,929 | \$73,267 |
| 2021 | \$409,256 | \$286,479 | 633 | \$245,000 | \$457,140 | \$77,932 | \$535,072 | \$344,560 | \$190,512 |
| 2022 | \$624,869 | \$437,409 | 623 | \$275,000 | \$553,124 | \$74,727 | \$627,851 | \$378,857 | \$248,994 |
| 2023 | \$457,203 | \$320,042 | 587 | \$305,000 | \$347,034 | \$96,107 | \$443,142 | \$333,679 | \$109,463 |
| 2024 | \$601,319 | \$427,916 | 596 | \$305,000 | \$549,684 | \$72,730 | \$622,054 | \$325,183 | \$296,871 |
| 2025 | \$310,780 | \$217,546 | 508 | \$305,000 | \$398,343 | \$73,191 | \$471,534 | \$330,677 | \$140,857 |
| TOTALS | \$9,801,164 | \$6,867,809 | 13540 | \$5,179,000 | \$7,678,158 | \$1,386,149 | \$9,063,948 | \$7,472,979 | \$1,590,969 |

¹ Revenue to Marathon County after 20% payment to State for loans and 10% payment to townships

² Includes County Forest Administrator grant, firewood permits, bond recovery and misc. revenues

³ Includes all personnel and operating expenses

MARATHON COUNTY TIMBER SALE
Leathercamp Forest Unit – March 2026

TRACT # 06-25 “Red Pants”

| ESTIMATED VOLUMES | | |
|--------------------------|----------------------------|-------------------|
| SPECIES | PULPWOOD (TONS) | LOGS (MBF) |
| Aspen | 2,375 | - |
| Mixed Hardwood | 170* | - |
| Basswood | 60 | - |
| Tops/Biomass | 780 | - |

Location: NWNW, NENW, NWNE, and SWNW 1/4 of Section 13 T26N R8E, Town of Guenther

Size: 56 Acres

Seasonal Time Frame: Dec. 1st – March 15th

Contract Length: Contract must be completed by June 30, 2029.

*Approximately 66% Red Maple, 22% Black Cherry, 5% Ash, 5% Paper Birch and 2% Elm

TICKET/MILL SCALE SALE

Cutting Regulations:

Aspen coppice (56 acres in 3 blocks) – Cut all stems greater than 1” DBH up to blue and red paint lines. Also, do not cut any red oak or green mark trees within the cutting area or red or blue border trees.

Roads/Trails/Decking Areas: Forestry Division must approve new roads, trails, skid routes and decking areas. All roads and trails shall be returned to their original condition. Keep all trails free of slash at all times.

Slash/Wildlife/Other: 16’8” maximum forest product length. All tops shall be lopped and scattered to lie within 24 inches of the ground. Maximum stump height shall not exceed the stump diameter, except for stumps less than 10,” which shall not exceed 10.” Do not cut snags unless they pose a safety risk to harvesting operations. Do not cut wildlife/cavity trees marked with an orange “W.”

Utilization: Sawlogs - 10 inch or larger diameter inside bark (DIB) on the small end, at least 50% sound
Pulpwood - One or more sticks to a 4-inch diameter inside bark (DIB) on the small end
Tops/Biomass - Minimum utilization to a 2-inch diameter inside bark (DIB) on the small end

The bidder must sign and return our contract and a performance bond of at least 25% of the contract value within 15 days of being awarded the bid or the bidder will forfeit the bid bond in its entirety.

Tract 6-25

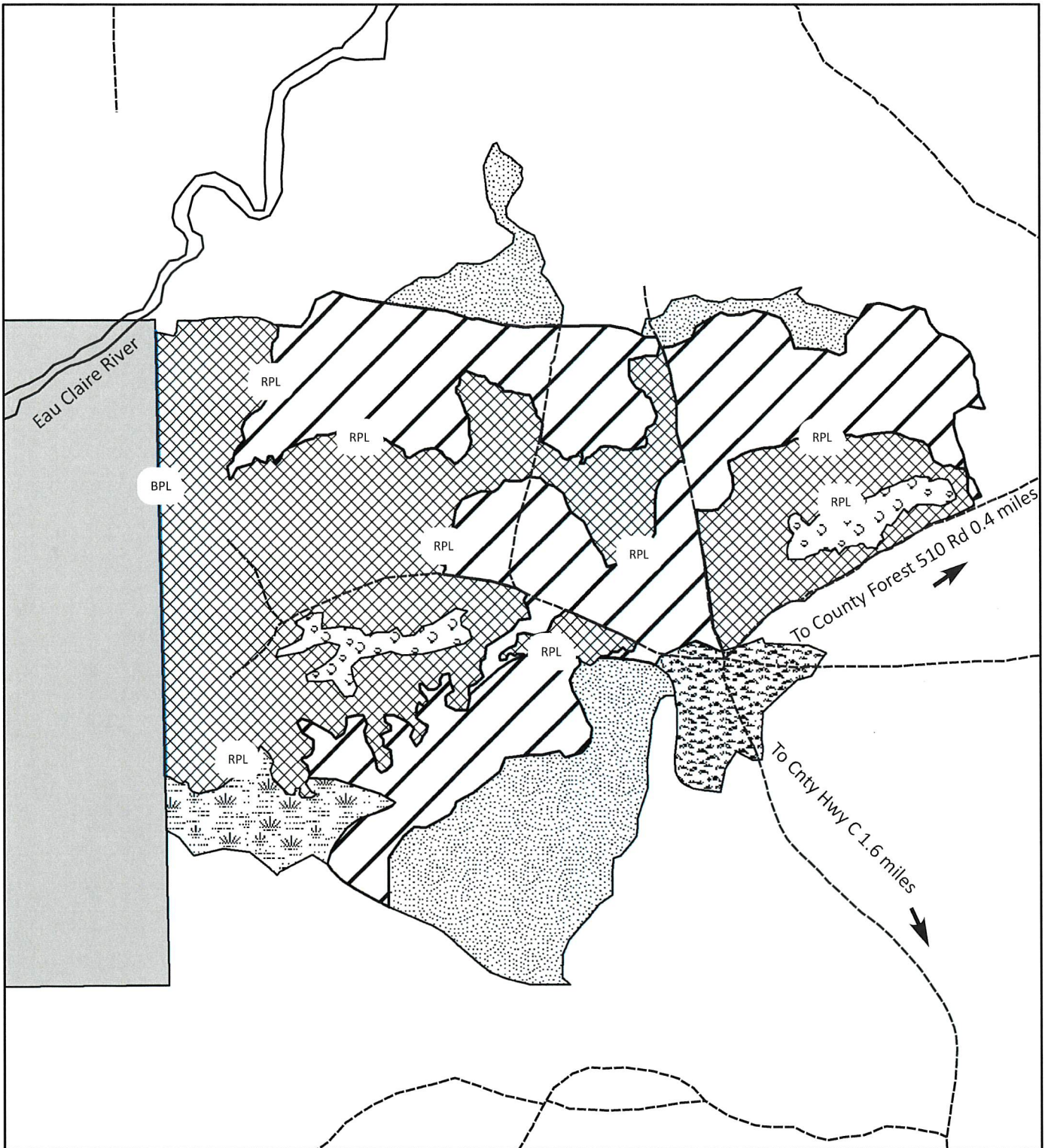

Legend

- | | | |
|------------------------------------------------------------------------------------------------------|--------------------------------------------------------------------------------------------------------|------------------------------------------------------------------------------------------------------|
|  Aspen Coppice |  Aspen Poles |  Grass and Shrubs |
|  Heavy Blowdown |  Hardwood Sawtimber |  Private Lands |
|  Blowdown and Wet |  Tag Alder | |

RPL or BPL - Red or Blue paint line



MARATHON COUNTY TIMBER SALE
Leather Camp Forest Unit – September 2025

Tract # 07-25 “Green Sleeve”

| ESTIMATED VOLUMES | | |
|--------------------------|----------------------------|-------------------|
| SPECIES | PULPWOOD (TONS) | LOGS (MBF) |
| Aspen | 2200 | - |
| Mixed Hardwood | *430 | - |
| Red Maple | - | 4.0 |
| Ash | - | **2.0 |
| Biomass (Optional) | 900 | - |
| | | |
| | | |
| | | |

Location: Section 13, T.26N.-R.08E. (Town of Guenther)

Size: 55 Acres

Seasonal Time Frame: December 1- March 15

Contract Length: Contract must be completed by June 30, 2029.

TICKET/MILL SCALE SALE

*Approximately 74% Red Maple, 11% Ash, 4% Cherry, 4% Elm, 4% Birch, 3% All Other Hardwood

**Includes < 1.0 MBF All Other Hardwood Logs

Cutting Regulations:

Aspen Coppice (55 acres in 2 blocks) – Cut all trees 1 inch and greater up to red paint lines and blue paint lines, except oak, conifer, and trees marked with green paint. Do not cut trees marked with blue or red paint.

Roads/Trails/Decking Areas: Forestry Division must approve new roads, trails, skid routes and decking areas. All roads and trails shall be returned to their original condition.

Slash/Wildlife/Other: All tops shall be lopped and scattered to lie within 24 inches of the ground. Maximum stump height shall not exceed the stump diameter, except for stumps less than 10,” which shall not exceed 10.” Do not cut snags unless they pose a safety risk to harvesting operations. All trails shall be free of slash at all times. No biomass harvesting within 50 feet of red paint line adjacent to stream (see map for location). County Forester will flag 50 foot buffer.

Utilization: Sawlogs - 10 inch or larger diameter inside bark (DIB) on the small end, at least 50% sound

Pulpwood - One or more sticks to a 4-inch diameter inside bark (DIB) on the small end



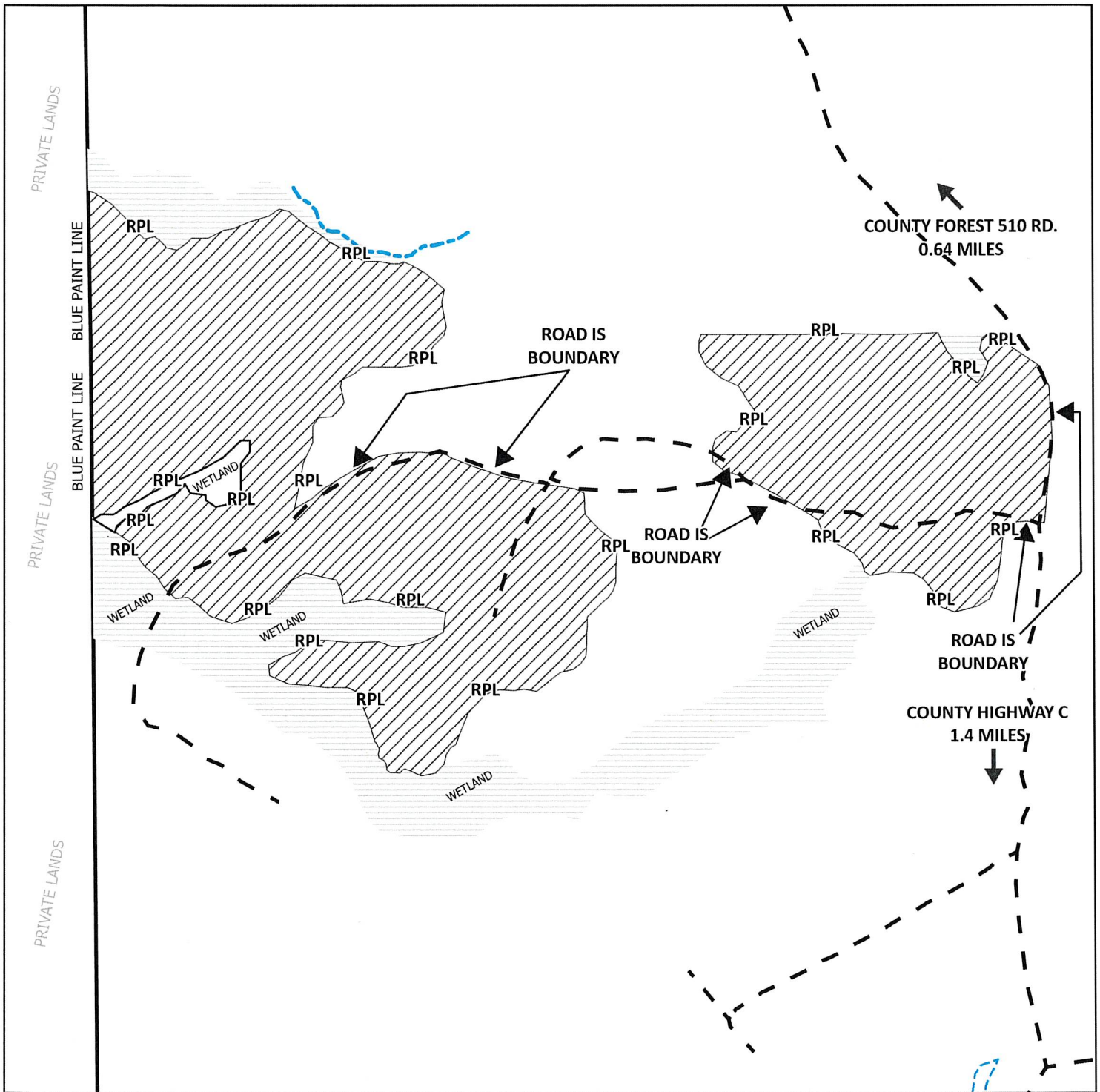

Tops/Biomass - Minimum utilization to a 2-inch diameter inside bark (DIB) on the small end

The bidder must sign and return our contract and a performance bond of at least 25% of the contract value within 15 days of being awarded the bid or the bidder will forfeit the bid bond in its entirety.

Tract 7-25



Legend

-  Aspen Coppice
-  Aspen GTR
- RPL Red Paint Line
-  Woods Road
-  Streams

MARATHON COUNTY TIMBER SALE
Burma Forest Unit – March 2026

TRACT # 01-26 “Lonely Raptor”

| ESTIMATED VOLUMES | | |
|--------------------------|----------------------------|-------------------|
| SPECIES | PULPWOOD (TONS) | LOGS (MBF) |
| Mixed Hardwood | 1,500* | - |
| Oak, Red | 330 | 32 |
| Hickory | 270 | 5 |
| Basswood | 100 | 14 |
| Aspen | 35 | - |
| Maple, Sugar | - | 49 |
| Maple, Red | - | 18 |
| Ash | - | 45 |
| Tops/Biomass | 700 | - |

Location: SWNW, NWSW, SWSW & SESW Section 16, SENE, NENE, NESE & SESE Section 17 and NENW, NWNE, SENW & SWNE Section 21 all in T27N R6E, Town of Mosinee

Size: 92 Acres

Seasonal Time Frame: July 15th – March 15th (oak wilt)

Contract Length: Contract must be completed by June 30, 2029.

*Approximately 55% Sugar Maple, 29% Ash, 13% Red Maple and 2% Black cherry, elm and birch

TICKET/MILL SCALE SALE

Cutting Regulations:

Hardwood selection (45 acres in 3 blocks) – Cut all trees marked with orange paint up to blue paint lines. Do not cut any blue marked trees.

Hardwood shelterwood (47 acres) – Cut all trees greater than 1” DBH up to red marked trees except for green marked trees. Do not cut any red marked trees.

Roads/Trails/Decking Areas: Forestry Division must approve new roads, trails, skid routes and decking areas. All roads and trails shall be returned to their original condition. Keep all trails free of slash at all times.

Slash/Wildlife/Other: 16’8” maximum forest product length. All tops shall be lopped and scattered to lie within 24 inches of the ground. Maximum stump height shall not exceed the stump diameter, except for stumps less than 10,” which shall not exceed 10.” Do not cut snags unless they pose a safety risk to harvesting operations. Do not cut wildlife/cavity trees marked with an orange “W.”

Utilization: Sawlogs - 10 inch or larger diameter inside bark (DIB) on the small end, at least 50% sound
Pulpwood - One or more sticks to a 4-inch diameter inside bark (DIB) on the small end
Tops/Biomass - Minimum utilization to a 2-inch diameter inside bark (DIB) on the small end

The bidder must sign and return our contract and a performance bond of at least 25% of the contract value within 15 days of being awarded the bid or the bidder will forfeit the bid bond in its entirety.

Tract 1-26

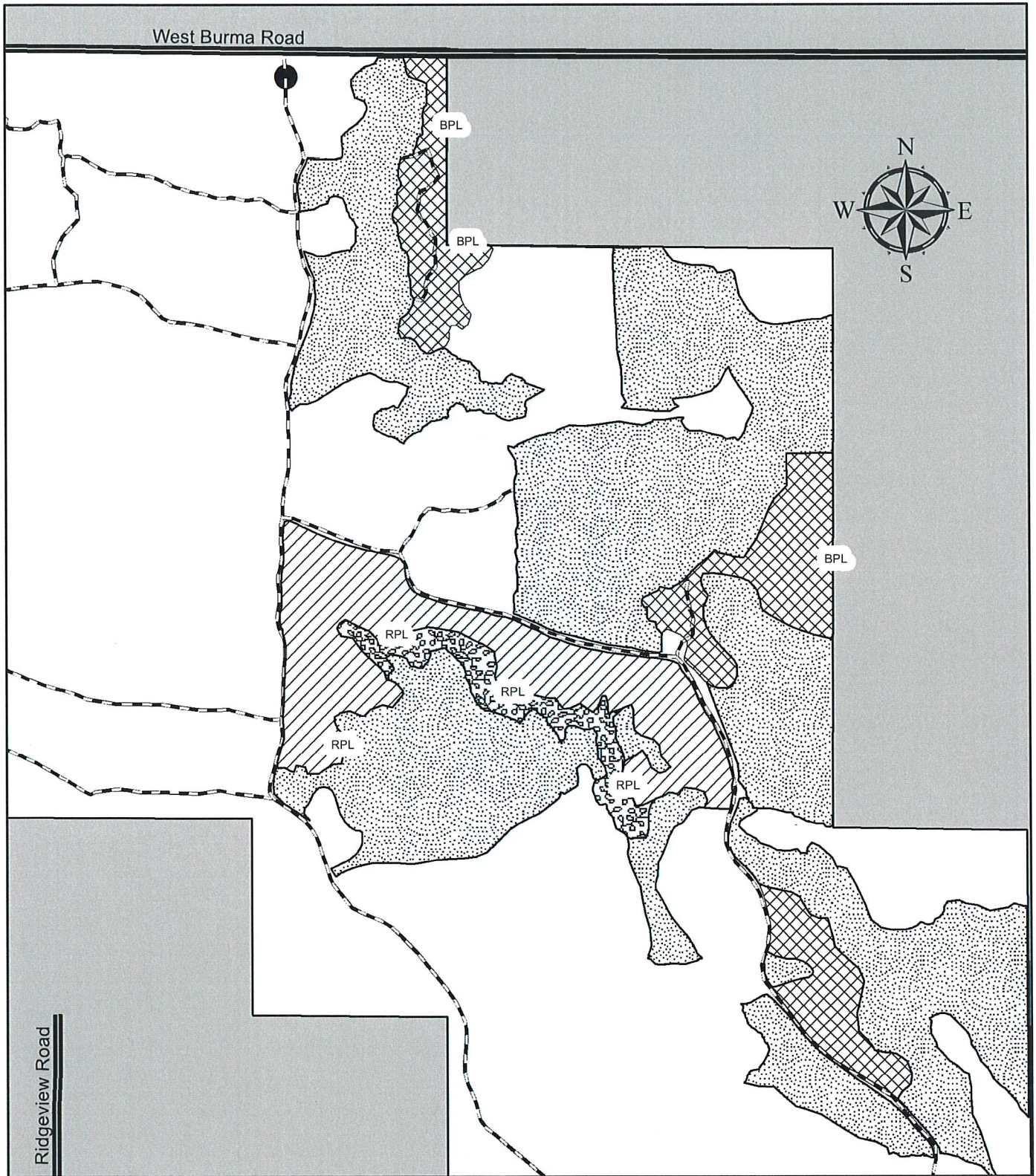

Legend

- | | | | | |
|-------------------------------------------------------------------------------------|-------------------------------|-------------------------------------------------------------------------------------|---------------|-------------------------------------|
|  | Hardwood selection harvest |  | Gravel_Trails | RPL or BPL - Red or Blue paint line |
|  | Hardwood shelterwood thinning |  | Private Lands | |
|  | Aspen saplings or poles |  | Parking Lots | |
|  | Oak saplings | | | |
- 0 470 940 1,880 2,820
 Feet

MARATHON COUNTY TIMBER SALE
Nine Mile Forest Unit – March 2026

Tract # 02-26 “Angry Birds”

| ESTIMATED VOLUMES | | |
|--------------------------|----------------------------|-------------------|
| SPECIES | PULPWOOD (TONS) | LOGS (MBF) |
| Red Pine | 1650 | *65.0 |
| Jack Pine | **150 | |
| Aspen | ***210 | |
| | | |
| Biomass (Optional) | NOT OFFERED | |

Location: Sections 32 & 33, T.28N.-R.7E. (Town of Rib Mountain)

Size: 79 Acres

Seasonal Time Frame: June 1-March 31 (if dry can start in May)

Contract Length: Contract must be completed by June 30, 2028

*Includes all other conifer logs

**Includes less than 2% all other conifer

***Includes less than 2% all other hardwood

TICKET/MILL SCALE SALE

Cutting Regulations:

Area 1: Red Pine Plantation-First Thinning (51 acres in 6 blocks) – Cut all rows designated with two orange dots for equipment access AND all orange marked trees in between equipment access rows. Cut all trees marked with green paint for additional access.

Area 2: Red Pine Plantation-Second & Third Thinning (25 acres in 3 blocks) – Cut all trees marked with orange paint.

Area 3: Aspen Coppice (3 acres in 1 block) – Cut all trees 1 inch and greater except for oak and conifer.

Roads/Trails/Decking Areas: Forestry Division must approve new roads, trails, skid routes and decking areas. All trails shall be free of slash at all times. All roads and trails shall be returned to their original condition. No decking of wood along County Forest 707 Road. June 1-Sept. 1 all pine must be hauled within 3 weeks of cutting.

Slash/Wildlife/Other: 16’ 8” maximum forest product length, except for utility poles. All tops shall be lopped and scattered to lie within 24 inches of the ground. Maximum stump height shall not exceed the stump diameter, except for stumps less than 10,” which shall not exceed 10.” Do not cut snags unless they pose a safety risk to harvesting operations. Cut snags that are within 100 feet of trails. If snowmobile trails are “open,” the contractor will work with the department to try and leave snow on the trail. Heterobasidion treatment required for all conifer by the end of each workday from April 1-November 30 and may be required from December 1-March 30 if abnormally warm for an extended period to be determined by Marathon County Forest representative.

Utilization: Sawlogs - 10 inch or larger diameter inside bark (DIB) on the small end, at least 50% sound
Pulpwood - One or more sticks to a 4-inch diameter inside bark (DIB) on the small end

The bidder must sign and return our contract and a performance bond of at least 25% of the contract value within 15 days of being awarded the bid or the bidder will forfeit the bid bond in its entirety.

TRACT 02-26

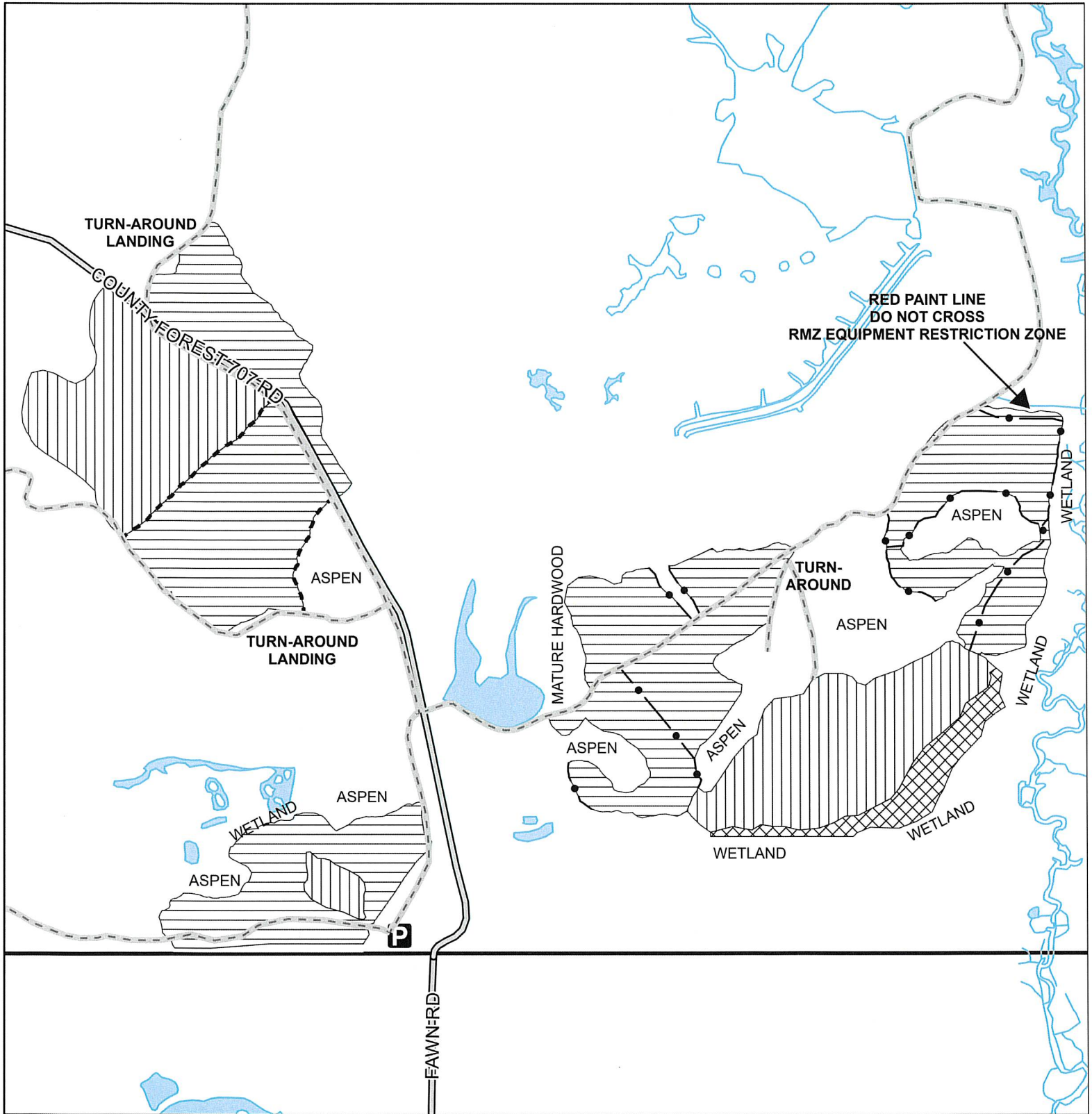

Legend

| | |
|----------------------------------------|-------------------------------------------|
| Area 1: Red Pine-First Thinning | New Skid Trails (Cut Green Painted Trees) |
| Area 2: Red Pine-Second/Third Thinning | Streams |
| Area 3: Aspen Coppice | Lakes/Ponds |
| Woods Road | Parking Lots |
| Skid Trails | |

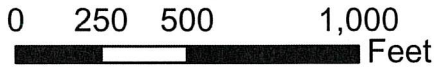

MARATHON COUNTY TIMBER SALE
Kronenwetter Forest Unit – March 2026

Tract # 03-26 “New Oak”

| ESTIMATED VOLUMES | | |
|-----------------------------------|----------------------------|-------------------|
| SPECIES | PULPWOOD (TONS) | LOGS (MBF) |
| Red Oak | 625 | 84.0 |
| Mixed Hardwood | **170 | *1.0 |
| Aspen | 550 | |
| Tops/Biomass (NOT OFFERED) | | - |

Location: Sections 13, 23 & 24, T.27N.-R.8E.
(Village of Kronenwetter)

Size: 48 Acres

Seasonal Time Frame: July 16 – March 15

Contract Length: Contract must be completed by June 30, 2029.

*Includes ALL other hardwood logs

** Approximately 60% Red Maple, 22% White Birch, 16% Ash & 2% all other hardwood

TICKET/MILL SCALE SALE

Cutting Regulations:

Area 1 – Oak Overstory Removal (29 acres in 2 blocks) – Cut all merchantable Red Oak up to red paint lines and blue paint lines. Do not cut trees marked with two green painted hashes.

Area 2 – Aspen Coppice (19 acres in 1 block) – Cut all trees one inch and greater up to red paint lines. Do not cut trees marked with green paint and within green paint lines.

Interior red paint lines separate Areas 1 & 2.

Roads/Trails/Decking Areas: Forestry Division must approve new roads, trails, skid routes, and decking areas. All trails shall be free of slash at all times. All roads and trails shall be returned to their original condition.

Slash/Wildlife/Other: 16’8” maximum forest product length. All tops shall be lopped and scattered to lie within 24 inches of the ground. Maximum stump height shall not exceed the stump diameter, except for stumps less than 10,” which shall not exceed 10.” Do not cut wildlife/cavity trees marked with a green “W.” Do not cut snags unless they pose a safety risk to harvesting operations. Cut snags that are within 100 feet of trails. If snowmobile trails are “open,” the contractor will work with the department to try and leave snow on the trail.

Utilization: Sawlogs - 10 inch or larger diameter inside bark (DIB) on the small end, at least 50% sound



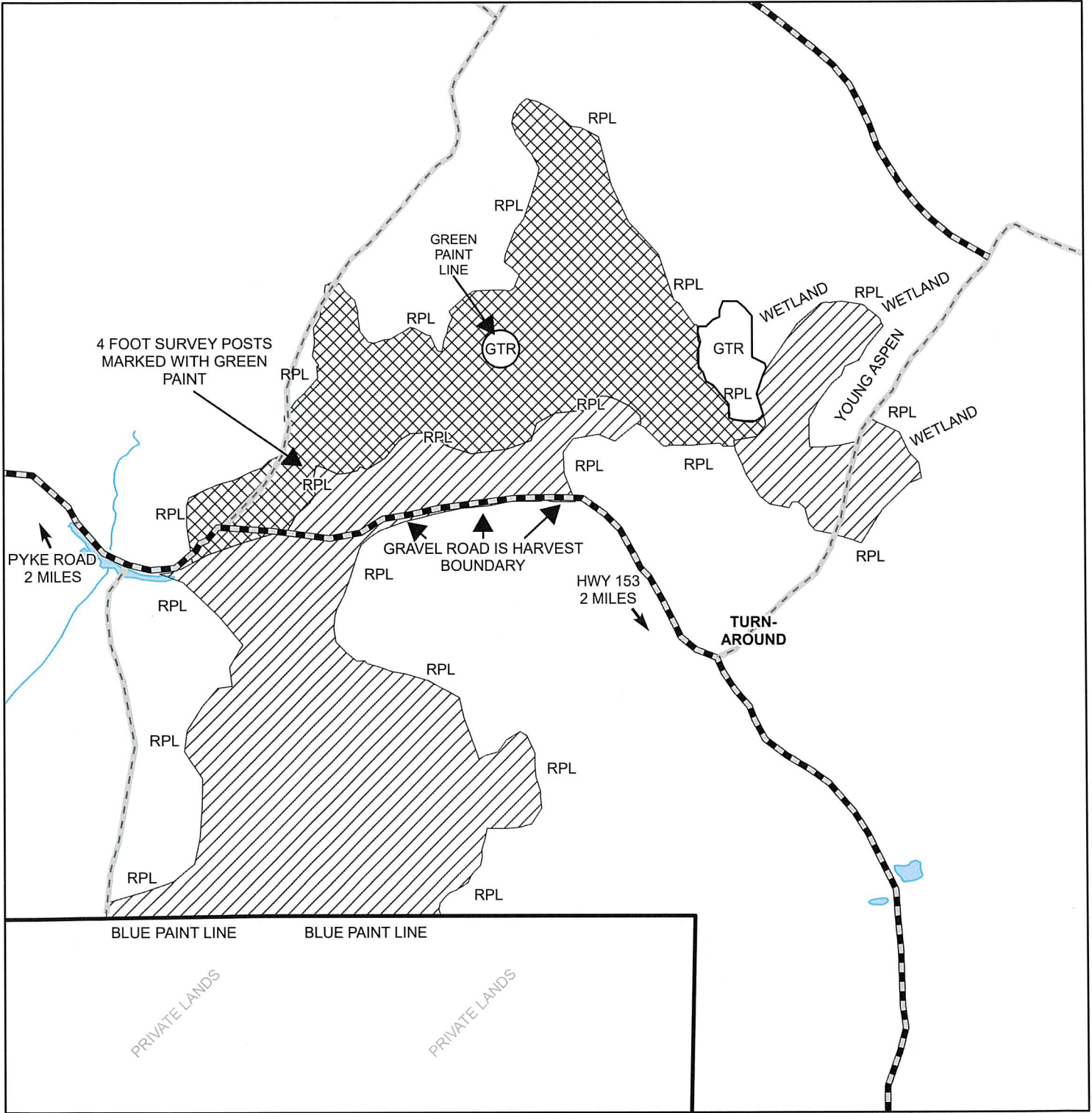

Pulpwood - One or more sticks to a 4-inch diameter inside bark (DIB) on the small end

The bidder must sign and return our contract and a performance bond of at least 25% of the contract value within 15 days of being awarded the bid or the bidder will forfeit the bid bond in its entirety.

TRACT 03-26



Legend

| | |
|-------------------------------------------------------------------------------------------------------------------|------------------------------------------------------------------------------------------------|
|  Area 1: Oak Overstory Removal |  Woods Road |
|  Area 2: Aspen Coppice |  Streams |
|  Gravel Roads | RPL Red Paint Line |

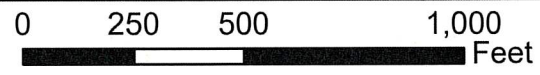

MARATHON COUNTY TIMBER SALE
Elderon Forest Unit – March 2026

TRACT # 04-26 “Happy Forester”

| ESTIMATED VOLUMES | | |
|-------------------|--------------------|------------|
| SPECIES | PULPWOOD (TONS) | LOGS (MBF) |
| Pine, Red | 45* | 99 |
| Mixed Hardwood | 90** | - |
| Tops/Biomass | N.A. | - |

Location: NESW, SESW, NWSE, and SWSE 1/4 of Section 20 T27N R10E

Size: 22 Acres

Seasonal Time Frame: June 1st – March 15th (possible May 1st if conditions allow)

Contract Length: Contract must be completed by June 30, 2029.

*Includes approximately 10 tons of balsam fir

**Includes approximately 10 tons of aspen

TICKET/MILL SCALE SALE

Cutting Regulations:

Pine thinning (22 acres in 2 blocks) – Cut all trees marked with orange paint.

Roads/Trails/Decking Areas: Forestry Division must approve new roads, trails, skid routes and decking areas. All roads and trails shall be returned to their original condition. Keep all trails free of slash at all times.

Slash/Wildlife/Other: 16’8” maximum forest product length. All tops shall be lopped and scattered to lie within 24 inches of the ground. Maximum stump height shall not exceed the stump diameter, except for stumps less than 10,” which shall not exceed 10.” Do not cut snags unless they pose a safety risk to harvesting operations. Do not cut wildlife/cavity trees marked with an orange “W.”



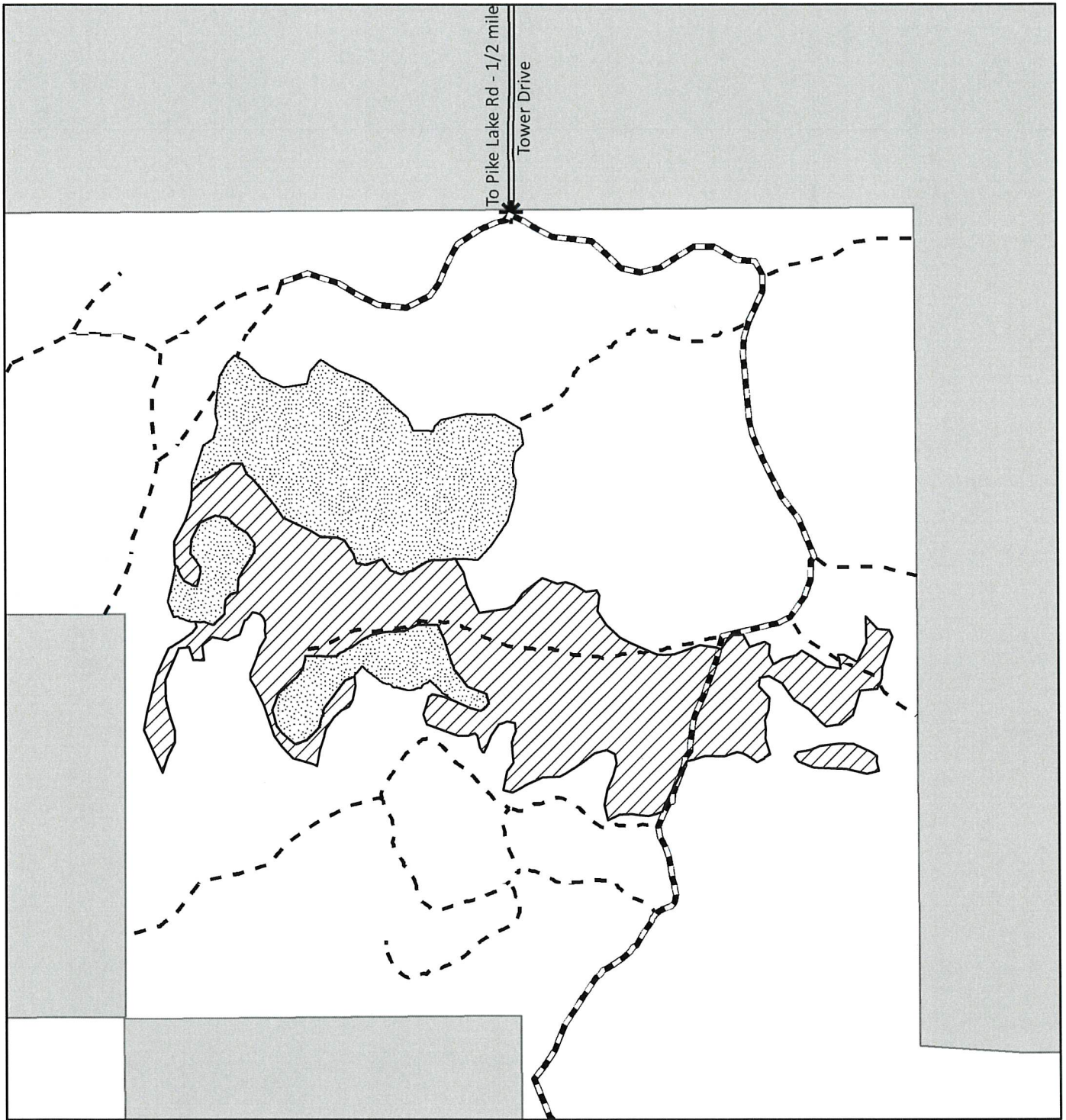

Utilization: Sawlogs - 10 inch or larger diameter inside bark (DIB) on the small end, at least 50% sound
Pulpwood - One or more sticks to a 4-inch diameter inside bark (DIB) on the small end
Tops/Biomass - Minimum utilization to a 2-inch diameter inside bark (DIB) on the small end

The bidder must sign and return our contract and a performance bond of at least 25% of the contract value within 15 days of being awarded the bid or the bidder will forfeit the bid bond in its entirety.

Tract 4-26



Legend

-  Red Pine Thinning
-  Aspen saplings or poles
-  Gravel_Trails
-  Forestry Trails
-  Parking Lots



MARATHON COUNTY TIMBER SALE
Ringle Forest Unit – March 2026

TRACT # 05-26 “Hidden Pine”

| ESTIMATED VOLUMES | | |
|-----------------------------------|----------------------------|-------------------|
| SPECIES | PULPWOOD (TONS) | LOGS (MBF) |
| Red Oak | 470 | 37.0 |
| Red Maple | | **42.0 |
| Mixed Hardwood | *950 | |
| White Spruce | 150 | 16.0 |
| Red Pine | 50 | 5.0 |
| Tops/Biomass (NOT OFFERED) | | |

Location: Section 6, T.27N.-R.9E. (Town of Reid)

Size: 66 Acres

Seasonal Time Frame: July 16 – March 15

Contract Length: Contract must be completed by June 30, 2029.

TICKET/MILL SCALE SALE

*Approximately 95% Red Maple, 3% ash, 2% all other hardwood

**Includes less than 1.0 MBF all other hardwood logs

Cutting Regulations:

Area 1 – Red Oak Thinning/Shelterwood (45 acres in 4 blocks) – Cut all trees marked with orange paint.

Area 2 – Red Maple Coppice (16 acres in 2 blocks) – Cut trees one inch and greater except for oak. Minimize damage to oak saplings.

Area 3 – White Spruce Clear-Cut (5 acres in 1 block) – Cut all merchantable White Spruce. Minimize damage to hardwood regeneration by falling trees within the path of travel and minimizing the number of paths. Area 3 shall not be operated in until Area 1 and Area 2 are 100% completed due to Buckthorn.

Purple paint lines separate cutting areas.

Roads/Trails/Decking Areas: Forestry Division must approve new roads, trails, skid routes and decking areas. All roads and trails shall be returned to their original condition. All trails shall be free of slash at all times.

Slash/Wildlife/Other: 16’8” maximum forest product length. All tops shall be lopped and scattered to lie within 24 inches of the ground. Maximum stump height shall not exceed the stump diameter, except for stumps less than 10,” which shall not exceed 10.” Do not cut snags unless they pose a safety risk to harvesting operations. Cut snags that are within 100 feet of trails. Do not cut wildlife/cavity trees marked with an orange “W.”

Utilization: Sawlogs - 10 inch or larger diameter inside bark (DIB) on the small end, at least 50% sound
Pulpwood - One or more sticks to a 4-inch diameter inside bark (DIB) on the small end

The bidder must sign and return our contract and a performance bond of at least 25% of the contract value within 15 days of being awarded the bid or the bidder will forfeit the bid bond in its entirety.

TRACT 05-26

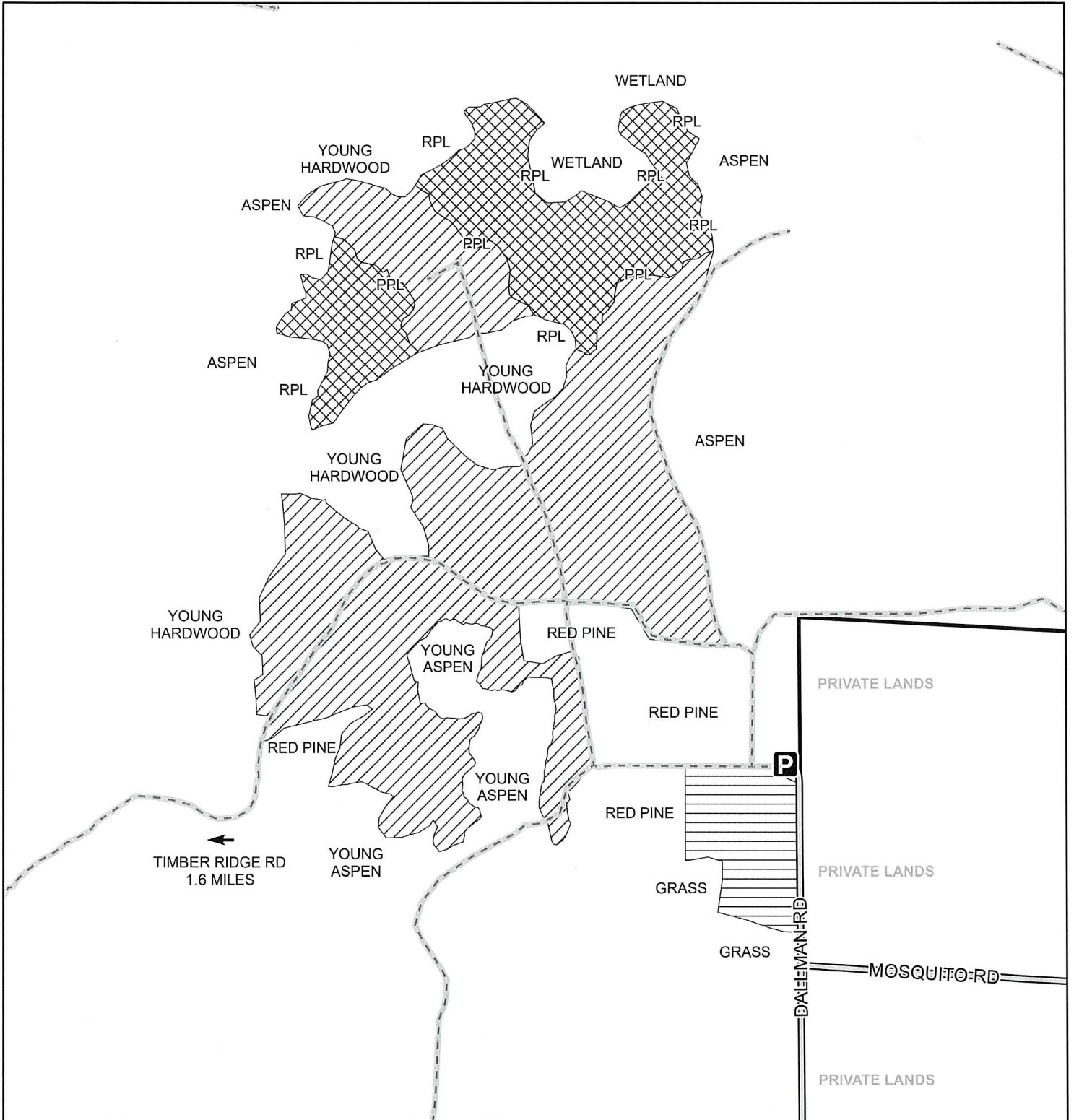

| Legend | |
|--------------------------------------|-----------------------|
| Parking Lots | RPL Red Paint Line |
| Woods Road | PPL Purple Paint Line |
| Area 1: Red Oak Thinning/Shelterwood | |
| Area 2: Red Maple Coppice | |
| Area 3: White Spruce Clear-Cut | |

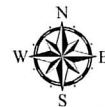
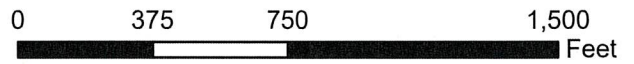

Parks, Recreation & Forestry Law Enforcement Annual Report (01/01/2025-12/31/2025)

Parks:

Patrols: Times where Mike, Tyler or Brian entered a park without being called there for a specific complaint. This does not include other sheriff's deputies checking out at the parks during their shifts. Numbers are from the Sheriff's CAD System. They indicate the number of times we check out at a specific park for a Patrol.

Patrol can vary widely from driving through the parking lots and checking passes, to foot patrols through the park. They can be 15 minutes or hours in length.

These are also only the times we actually physically checked out at a park, there are also times we are at various parks and do not check out. The times we do not check out are usually very quick patrols where there it is discovered there are very few people at the park. (Only 0-2 vehicle's in lot, etc.)

Criminal Complaints: Times where Mike, Tyler or Brian entered a park after being called by either the parks department or a witness for a specific complaint or issue. This does not include other sheriff's deputies being dispatched to parks when Mike, Tyler or Brian are unavailable.

Complaints can vary on types of complaints. Majority of complaints are for camping registration violations, noise complaints, and littering complaints. Others include, complaints of entering prohibited areas, pay tube break-ins, domestic animal violations, and wild animal complaints.

| Patrols | |
|----------------------|------------|
| Marathon Park: | 44 |
| DC Everest: | 12 |
| Bluegill: | 65 |
| Big Eau Pleine: | 79 |
| Dells of Eau Claire: | 19 |
| Sunnyvale: | 57 |
| Rib Falls: | 15 |
| Mission Lake: | 17 |
| Ashley: | 2 |
| Big Rapids: | 7 |
| Cherokee: | 5 |
| Amco: | 4 |
| Brokaw: | 3 |
| Gilbert: | 0 |
| Memorial: | 0 |
| Oak Island: | 1 |
| Schofield: | 5 |
| <i>Total:</i> | <i>335</i> |

| Criminal Complaints | |
|----------------------------|-----------|
| Marathon Park: | 4 |
| DC Everest: | 4 |
| Bluegill: | 7 |
| Big Eau Pleine: | 4 |
| Dells of Eau Claire: | 2 |
| Sunnyvale: | 1 |
| Rib Falls: | 1 |
| Mission Lake: | 3 |
| Ashley: | 0 |
| Big Rapids: | 1 |
| Cherokee: | 0 |
| Amco: | 0 |
| Brokaw: | 3 |
| <i>Total:</i> | <i>30</i> |

Citations and Warnings: Number of times a person was issued a citation or written warning for a Parks ordinance violations. This does not include verbal warnings which makes up the vast majority of enforcement means and are not able to be tallied. This does not include State Criminal Charges, or State Citations. This also does not include Violation Notices issued.

| Citations | Written Warnings |
|-------------------------------|-------------------------------|
| Deface, Remove, Destroy: 0 | Littering, Dumping, Refuse: 0 |
| Fail to Pay Fee: 21 | Enter Prohibited Area: 1 |
| Vehicle Violations: 1 | Animal Violations: 0 |
| Littering, Dumping, Refuse: 3 | Vehicle Violations: 1 |
| Animal Violations: 0 | Soliciting: 0 |
| Camping Violations: 4 | <i>Total: 2</i> |
| Obstructing Officer: 0 | |
| <i>Total: 29</i> | |

Criminal Charges and Arrests: Number of times a person had criminal charges brought against them or was arrested for a criminal offense by Mike, Tyler or Brian for a violation at a park or during a recreational motor vehicle patrol. This does not include other arrests made by deputies at a park, if any occurred. This also does not include arrests made by Mike, Tyler or Brian for non-park related complaints.

| Criminal Charges | |
|------------------------------|----------|
| Warrant Arrests: | 0 |
| OWI Related Arrests: | 0 |
| Check Fraud: | 1 |
| Lewd Behavior: | 0 |
| Criminal Damage to Property: | 0 |
| <i>Total:</i> | <i>1</i> |

Forestry:

Patrols and Complaints: Times Mike, Tyler or Brian were at a Forest Unit for either a complaint called in by Forestry Staff or citizen, or a general patrol.

Patrols and Complaints

| | |
|---------------------|----|
| Vehicle Violations: | 1 |
| XC Ski Patrols: | 34 |
| Vandalism: | 2 |
| Misc. Criminal: | 19 |
| Illegal Dumping: | 12 |
| Lost Hiker/Hunter: | 1 |
| <i>Total:</i> | 69 |

Patrols

| | |
|------------------|-----|
| Nine Mile: | 137 |
| Burma: | 22 |
| Ringle: | 18 |
| Kronenwetter: | 2 |
| Leathercamp: | 5 |
| Wisconsin River: | 5 |
| Harrison Hewitt: | 5 |
| Bern Wetland: | 3 |
| <i>Total:</i> | 197 |

Tree Stand/Trail Camera Enforcement

| | |
|--------------------|----|
| Monitoring: | 2 |
| Tree Stands/Camera | |
| Confiscated: | 13 |
| Boat Confiscated: | 0 |
| No Stand Located: | 5 |
| Citations: | 0 |
| <i>Total:</i> | 20 |

Citations: Times Mike, Tyler, or Brian issued a citation for violations of Forestry Ordinance. This does not include violations notices issued.

Citations

| | |
|---------------------|---|
| Vehicle Violations: | 1 |
| Abandoned Vehicle: | 1 |
| Misc: | 0 |
| <i>Total:</i> | 2 |

Recreation Motor Vehicle Patrols:

Hours, Citations, and Warnings submitted to DNR for recreational motor vehicle patrols. Snowmobile data is from 2024-2025 snowmobile season and from December 2025 as the trails had opened early for this season. Boat Data is taken from the 2025 season. ATV data is for patrols from May 2025 – December 2025, due to DNR considering any patrols prior to May as 2024 data. These hours at the total hours from all deputies working the grants.

| Type | Hours | Citations | Warnings |
|---------------|--------|-----------|----------|
| Snowmobile: | 211 | 6 | 13 |
| Boat: | 244.5 | 3 | 13 |
| ATV: | 1087.5 | 19 | 31 |
| <i>Total:</i> | 1543 | 28 | 57 |



February 25, 2026

Dear Valued Supplier,

We are reaching out to share an important update about our operations. Today, Ahlstrom announced that it will close its pulp mill and idle its M2, and M3 paper machines at our Mosinee plant in Wisconsin.

The M3 paper machine and pulp mill will cease operations on June 30, 2026. The M2 paper machine will close on September 30, 2026. Operations will continue on M1 and M4 paper machines.

The difficult decision to cease operations on these older assets was made after much discussion and evaluation. We are focused on aligning resources to where they are most effective, so we will be investing in the remaining M1 and M4 paper machines with more modern technologies. These investments will allow us to create a more agile and sustainable Mosinee mill for the future.

Our Thilmany mill will continue its full scope of operations. We value our working relationship, and we consider your partnership vitally important to our success today and in the future. As we navigate this next phase of our business, it is our priority to work closely with you to develop a mutual transition plan.

We understand the impact this news may have on your business. We are committed to transparent and ongoing communication to ensure the best outcomes. We will contact you directly in the next few days to establish next steps.

Kind Regards,

Christel Laatsch

Christel Laatsch
Head of Procurement, Directs

Travis Zydzik

Travis Zydzik
Regional Category Manager, Directs

SUPPORT COUNTY FORESTS!

Remember to purchase your special license plate today!



**INVEST IN
FORESTS
INVEST IN
THE FUTURE**

