

INDEX OF SHEETS

SHEET NO. 1	TITLE
SHEET NO. 1	TYPICAL CROSS SECTIONS
SHEET NO. 1	ESTIMATE OF QUANTITIES
SHEET NO. -	MISCELLANEOUS QUANTITIES
SHEET NO. -	RIGHT OF WAY PLAT
SHEET NO. 2-6	PLAN AND PROFILE STA. 0+00 TO STA. 262+43
SHEET NO. -	STANDARD DETAILS
SHEET NO. -	DRAINAGE STRUCTURES
SHEET NO. -	CROSS SECTIONS

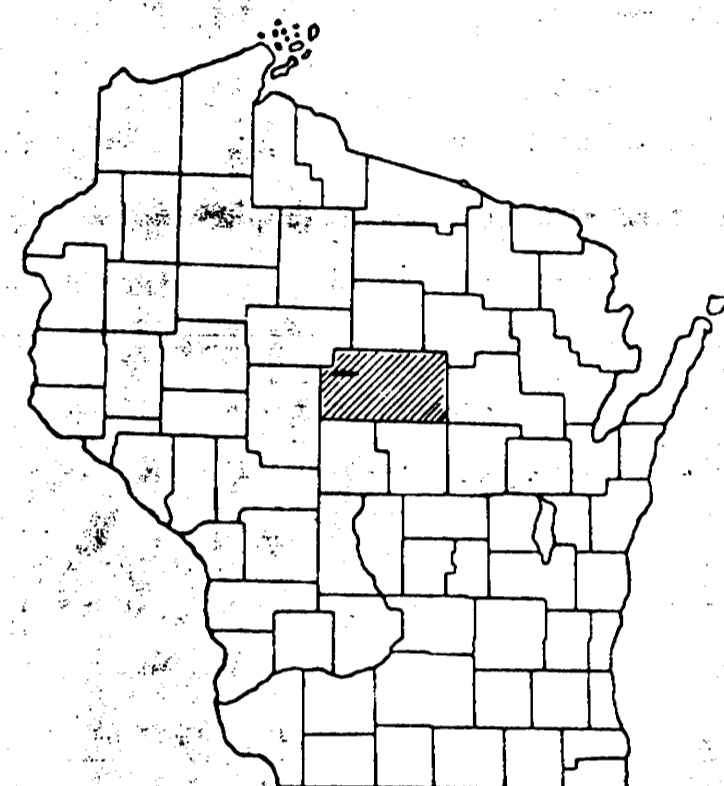

THIS PROJECT IS TO BE EXECUTED UNDER THE STANDARD SPECIFICATIONS FOR ROAD AND BRIDGE CONSTRUCTION OF THE HIGHWAY COMMISSION OF WISCONSIN- EDITION OF 1951. SUBMITTED FOR APPROVAL... FEDERAL AID REQUIRED CONTRACT PROVISIONS APPROVED NOV. 8, 1948 AND SPECIAL PROVISIONS AS ATTACHED TO PROPOSALS

ESTIMATE OF QUANTITIES

CONTRACT NO.	ITEM NO.	QUANTITY	UNIT	ITEM
2	2313-1	58650	SQ. YD.	BITUMINOUS ROAD MIX SURFACE
2	2313-3	90000	GAL.	BITUMINOUS MATERIAL FOR SURFACE COURSE
1	2313-2	4600	C.Y.	AGGREGATES FOR BITUMINOUS ROAD MIX SURFACE

STATE HIGHWAY COMMISSION OF WISCONSIN

PLAN AND PROFILE OF PROPOSED
C.T.H. "E" -- S.T.H. 97
MARATHON COUNTY
PROJECT S017 (2)

PLAN 1 IN. = 200 FT.
PROFILE HOR. 1 IN. = 200 FT. VERT. 1 IN. = 20 FT.

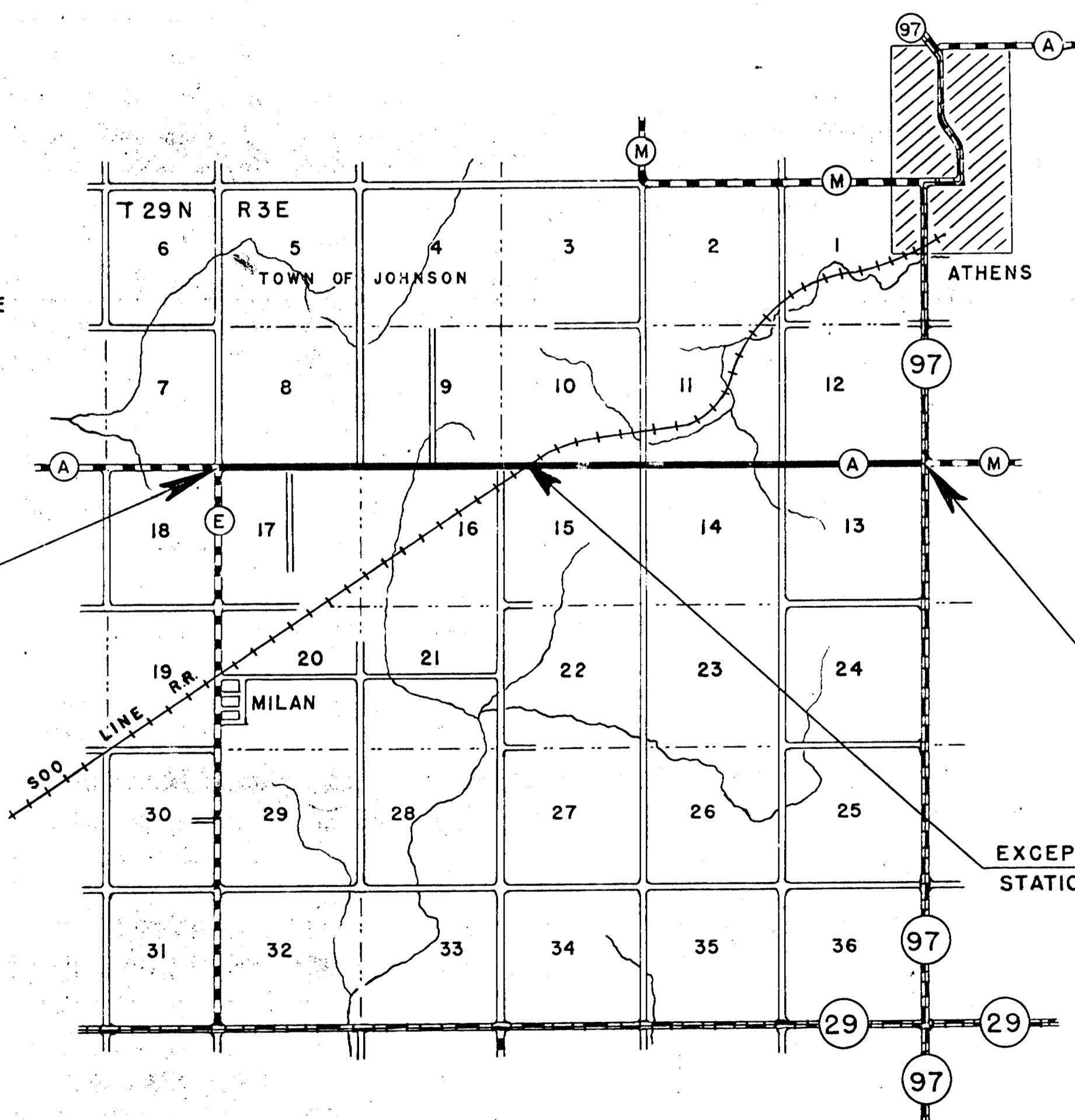
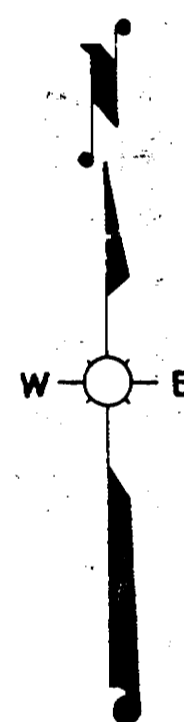

LAYOUT

SCALE 1 MILE

TOTAL NET LENGTH OF CENTERLINE = 4.966 MI.

BEGINNING OF PROJECT S017(2)
STATION 0+00 = STATION 353+27 END PROJECT S017(4)

END OF PROJECT S017(2)
STATION 262+43

EXCEPTION TO NET LENGTH
STATION 111+91.5 TO STATION 112+14.5

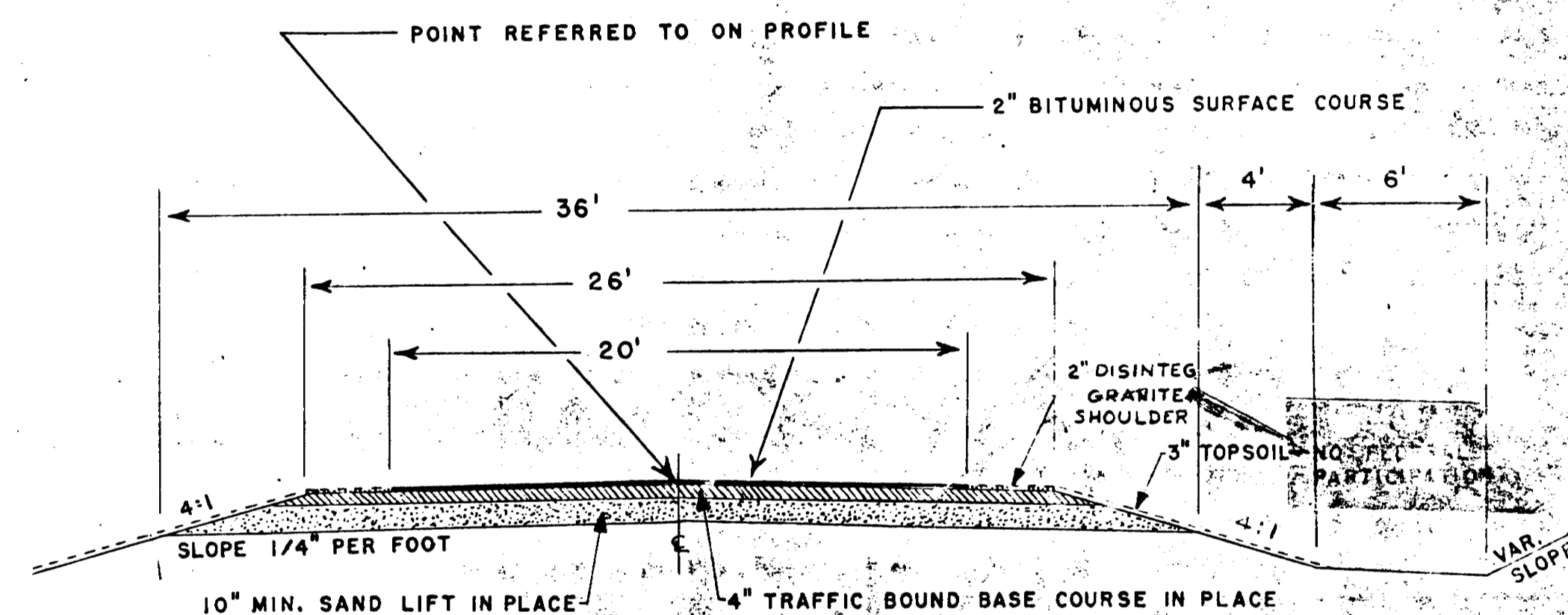

TYPICAL SECTION

CONVENTIONAL SIGNS

STATE LINE	-----	CULVERTS IN PLACE	-----
COUNTY LINE	-----	CULVERTS REQUIRED	-----
TOWNSHIP OR RANGE LINE	-----	DROP INLET	-----
SECTION LINE	-----	POWER POLE	-----
NEW RIGHT OF WAY LINE	-----	TELEPHONE OR TELEGRAPH POLE	-----
PRESENT RIGHT OF WAY LINE	-----	RIGHT OF WAY MARKERS	-----
WIRE FENCE	WOVEN	REFERENCE STAKE FOR HUBS ONLY	-----
	BARBED	MARSH	-----
LOT LINE	-----	HEDGE	-----
CORPORATE OR CITY LIMITS	-----	TREES	-----
PROPERTY LINE	-----	GROUND ELEVATION	DATUM LINE
TRAVELED WAY OR P.E.	-----	GRADE ELEVATION	DATUM LINE
RAILROADS	-----		
BASE OR SURVEY LINE	-----		

STATE HIGHWAY COMMISSION OF WISCONSIN MADISON, WIS.	FEDERAL WORKS AGENCY PUBLIC ROADS ADMINISTRATION
SURVEYOR: C.E.C. NOTE BOOK DIVISION COMPUTER: C.E.C. M.O. CHECKER DIVISION CHECKER: R.J.R. CORRECT	RECOMMENDED FOR APPROVAL:
CORRECT: DATE 2/14/51 <i>W. Hanson</i> DIVISION ENGINEER	DISTRICT ENGINEER PUBLIC ROADS ADMINISTRATION FEDERAL WORKS AGENCY
RECOMMENDED FOR APPROVAL: DATE 2/14/51 <i>A. D. Huber</i> CONSTRUCTION ENGINEER	APPROVED:
APPROVED: DATE 2/14/51 <i>E. C. Roemer</i> STATE HIGHWAY ENGINEER	COMMISSIONER PUBLIC ROADS ADMINISTRATION FEDERAL WORKS AGENCY

FED. ROAD DIST. NO.	STATE	FED. AID PROJ. NO.	SHEET NO.	TOTAL SHEETS
4	WIS.	S017(2)	2	6

DIVISION JOB NO. _____

BENCH MARKS				
1	0 29	SPIKE IN P. POLE	100 R	527.60
2	11 00	" T "	30 R	521.10
3	42 27	" P "	30 L	506.60
4	51 82	" T "	30 R	496.80

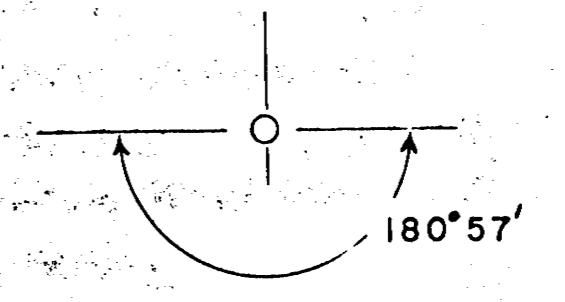
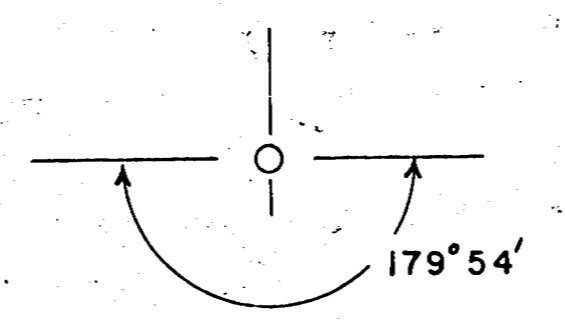
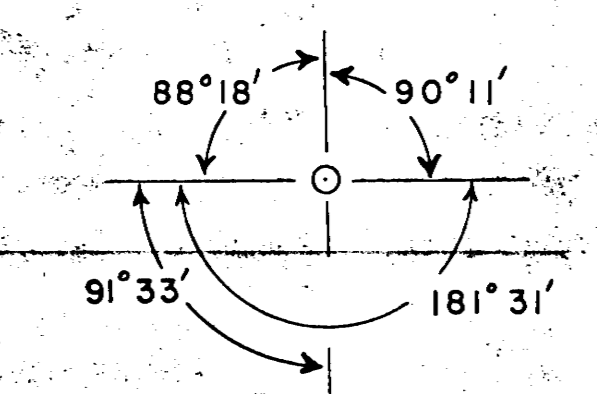

DATE: L-5
 BY: C.E.C.
 SURVEYED: _____
 PLOTTED: _____
 CHECKED: _____
 NOTE BOOK NO.: _____
 RT. OF WAY CHECKED: _____

DATE: L-5
 BY: C.E.C.
 PROFILE SURVEYED: _____
 PLOTTED: _____
 CHECKED: _____
 NOTE BOOK NO.: _____
 STRUCTURE NOTATIONS CHKD: _____

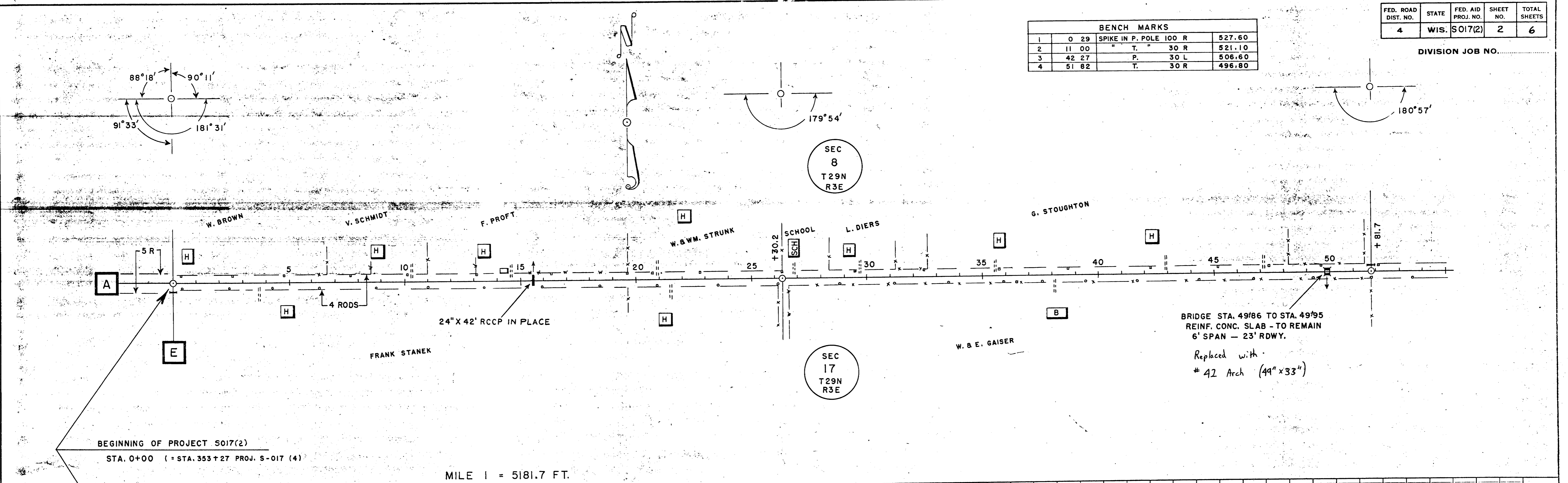

BEGINNING OF PROJECT S017(2)
 STA. 0+00 (= STA. 353+27 PROJ. S-017 (4))

MILE 1 = 5181.7 FT.

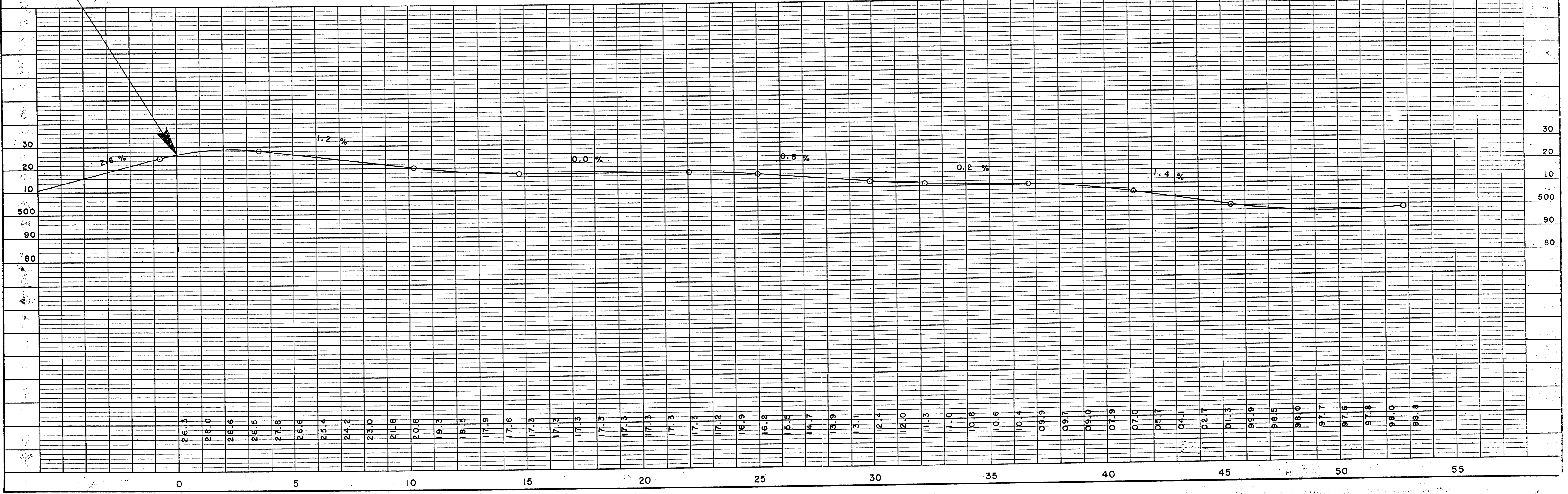

PLAN
 SURVEYED -
 PLOTTED -
 CHECKED -
 NOTE BOOK
 RT. OF WAY CHECKED
 NO.

PROFILE
 SURVEYED -
 GRADES CHECKED -
 NOTE BOOK
 B. M.'S. NOTED
 STRUCTURE NOTATIONS CHECKED
 NO.

FED. ROAD DIST. NO.	STATE	FED. AID PROJ. NO.	SHEET NO.	TOTAL SHEETS
4	WIS.	SO17(2)	3	6

BENCH MARKS			
4	51 82	SPIKE IN T. POLE 30 R	496.80
5	79 42	" P. " 30 L	494.65
6	104 38	" P. " 30 L	502.11

DIVISION JOB NO.

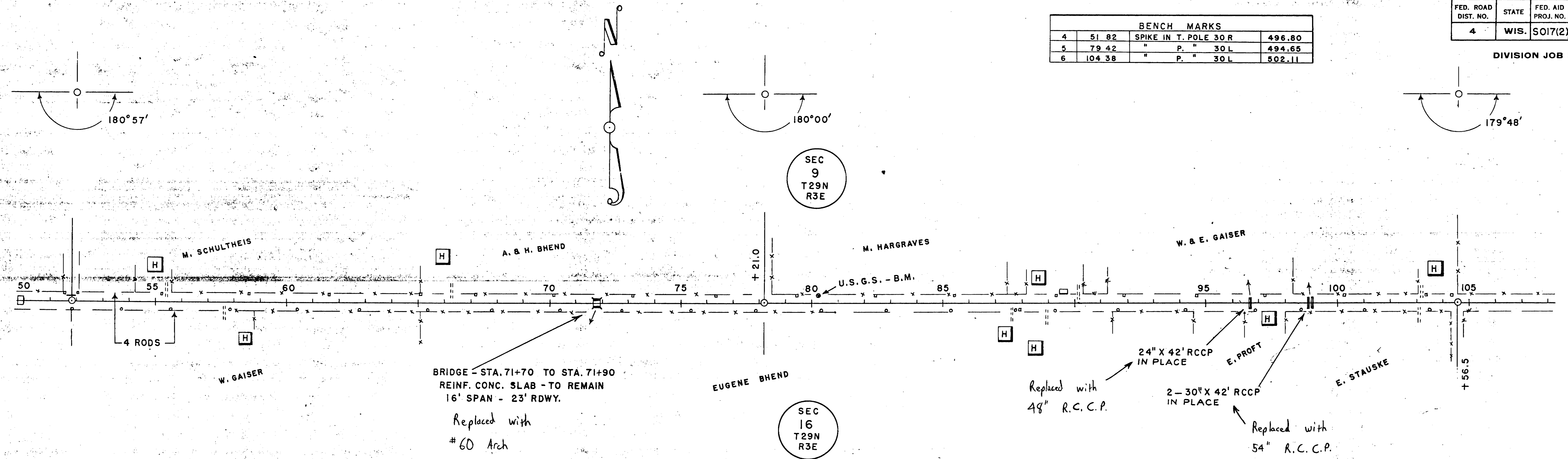

MILE 2 = 5274.8 FT.

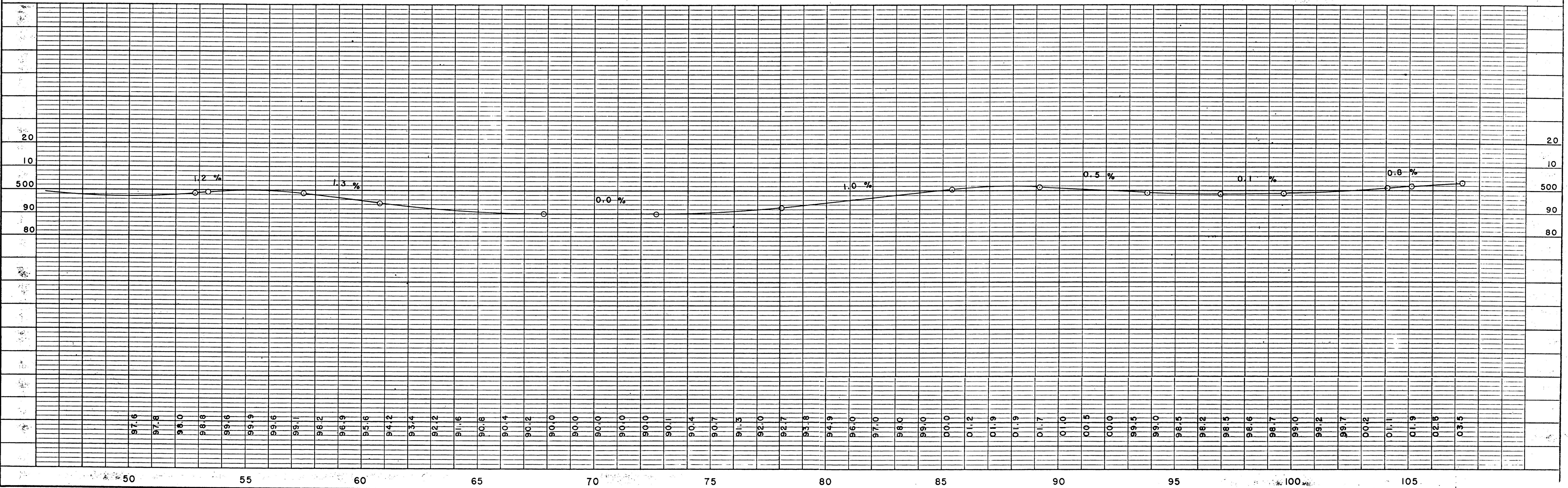

FED. ROAD DIST. NO.	STATE	FED. AID PROJ. NO.	SHEET NO.	TOTAL SHEETS
4	WIS.	SO17(2)	4	6

BENCH MARKS				
6	104+38	SPIKE IN P. POLE	30' L	502.11
7	143+29	" " T. "	30' R	522.82
8	157+95	" " T. "	30' R	498.66

DIVISION JOB NO.

PLAN
 SURVEYED BY C. E. C.
 NOTE BOOK NO. ...
 ALIGNMENT CHECKED ...
 RT. OF WAY CHECKED ...

PROFILE
 SURVEYED BY C. E. C.
 NOTE BOOK NO. ...
 GRADES CHECKED ...
 B. M.S. NOTED ...
 STRUCTURE NOTATIONS CHKD. ...

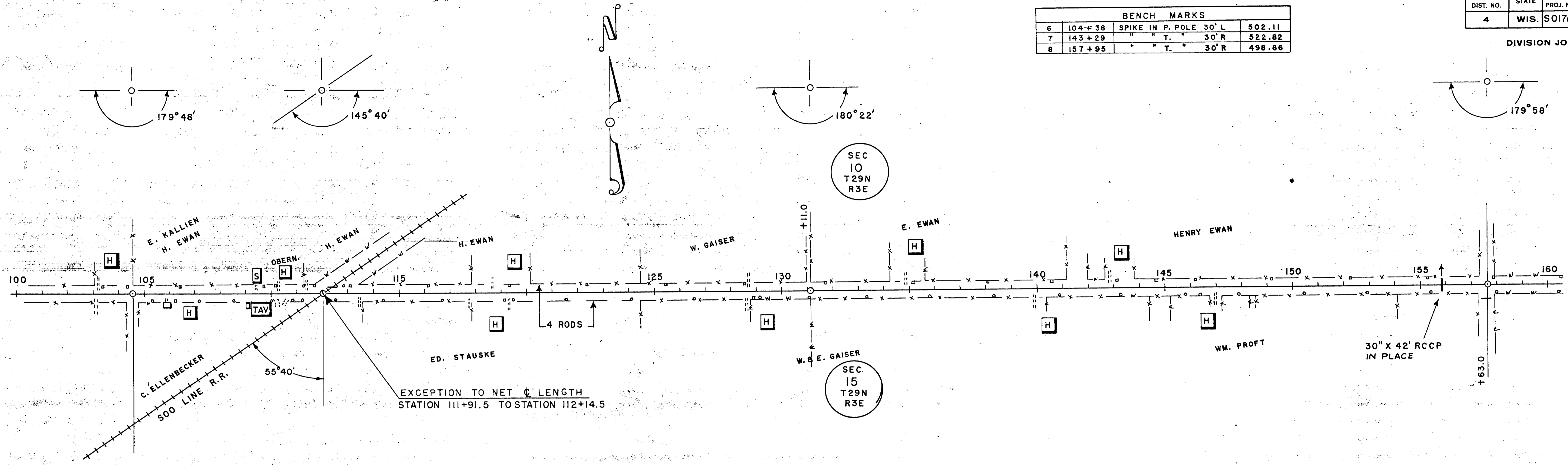

MILE 3 = 5283.5 FT.

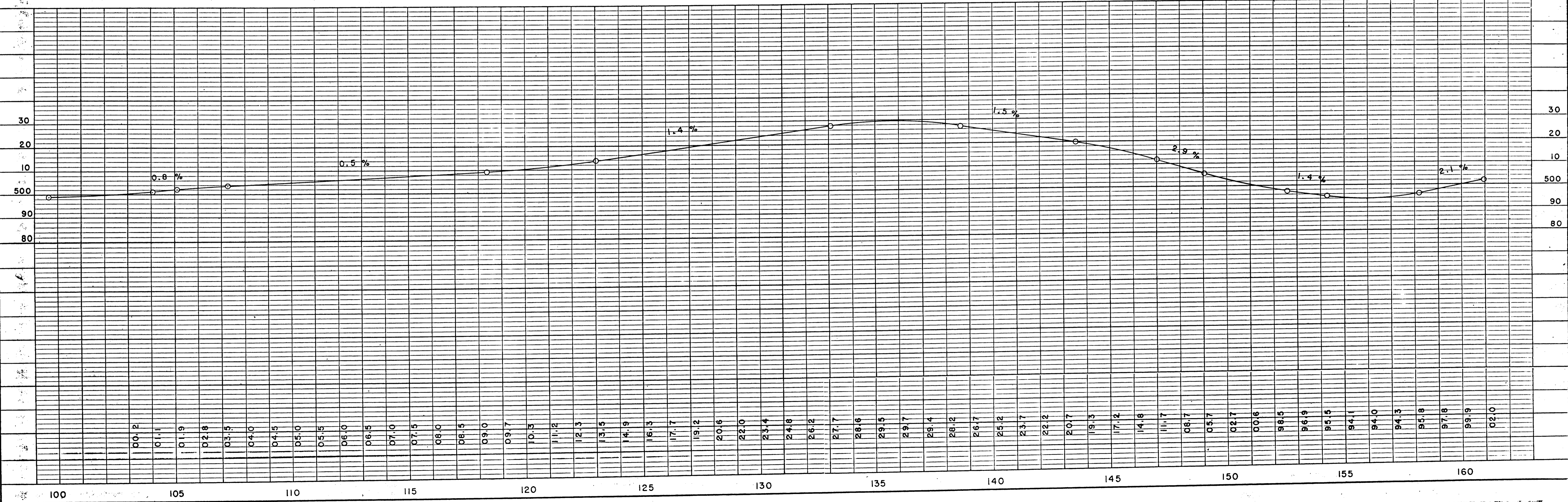

DATE: L-51
 BY: C. E. C.
 CHECKED: C. E. C.
 NO.:

DATE: L-51
 BY: C. E. C.
 CHECKED: C. E. C.
 NO.:

FED. ROAD DIST. NO.	STATE	FED. AID PROJ. NO.	SHEET NO.	TOTAL SHEETS
4	WIS.	SO17(2)	5	6

BENCH MARKS			
8	157 + 95	SPIKE IN T. POLE 30' R	498.66
9	175 + 56	" " P. " 30' L	504.34

DIVISION JOB NO.

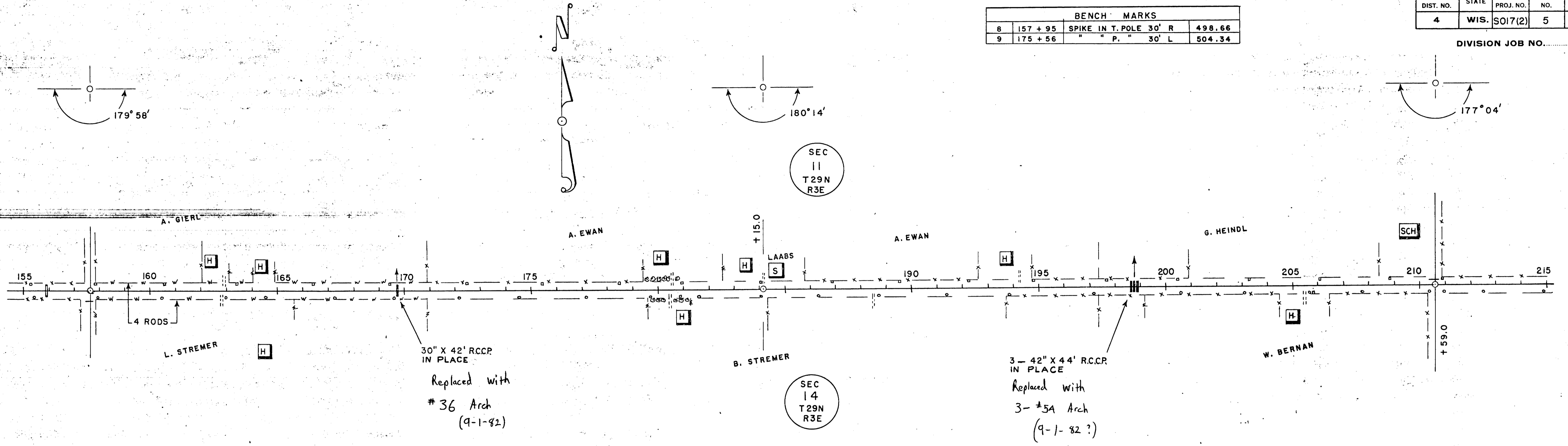

MILE 4 = 5296.0 FT.

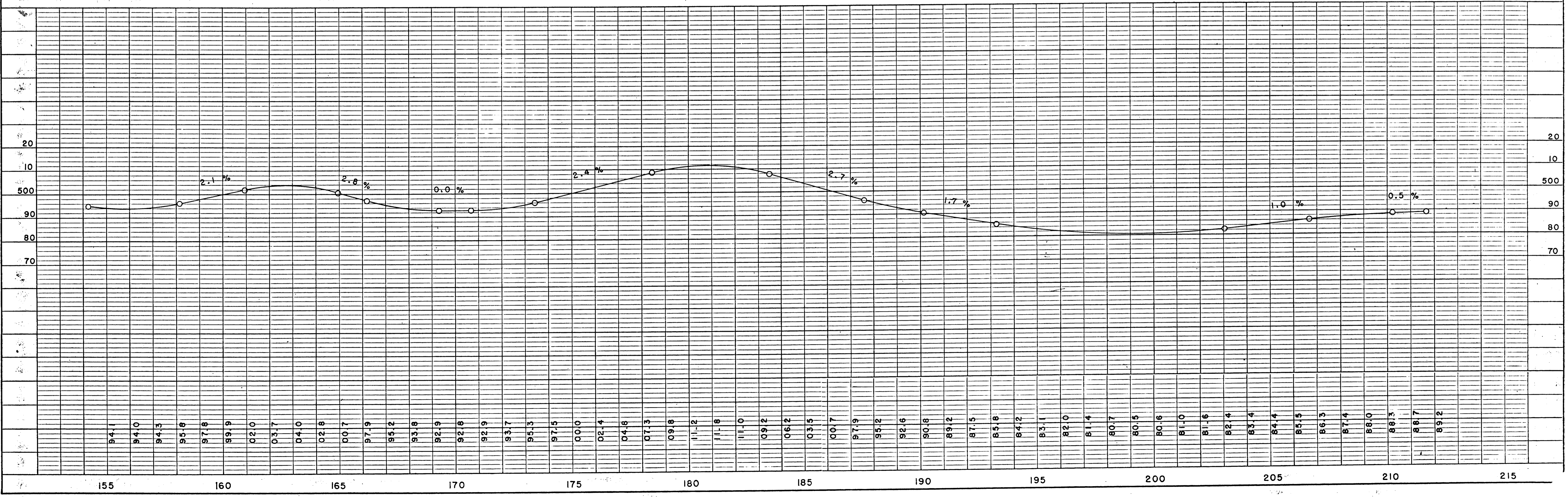

DATE: 1-51
 PLAN
 SURVEYED
 PLOTTED
 NOTE BOOK GRABBS CHECKED
 ALIGNMENT CHECKED
 RT. OF WAY CHECKED
 NO.:

DATE: 1-51
 PROFILE
 SURVEYED
 PLOTTED
 NOTE BOOK GRABBS CHECKED
 STRUCTURE NOTATIONS CHKD.
 NO.:

BENCH MARKS			
10	224 + 60	SPIKE IN 30' ELM 40' R	501.40
11	247 + 85	" " T. POLE 30' R	512.56
12	262 + 02	" " P. " 30' L	514.24

FED. ROAD DIST. NO.	STATE	FED. AID PROJ. NO.	SHEET NO.	TOTAL SHEETS
4	WIS.	5017(2)	6	6

DIVISION JOB NO. _____

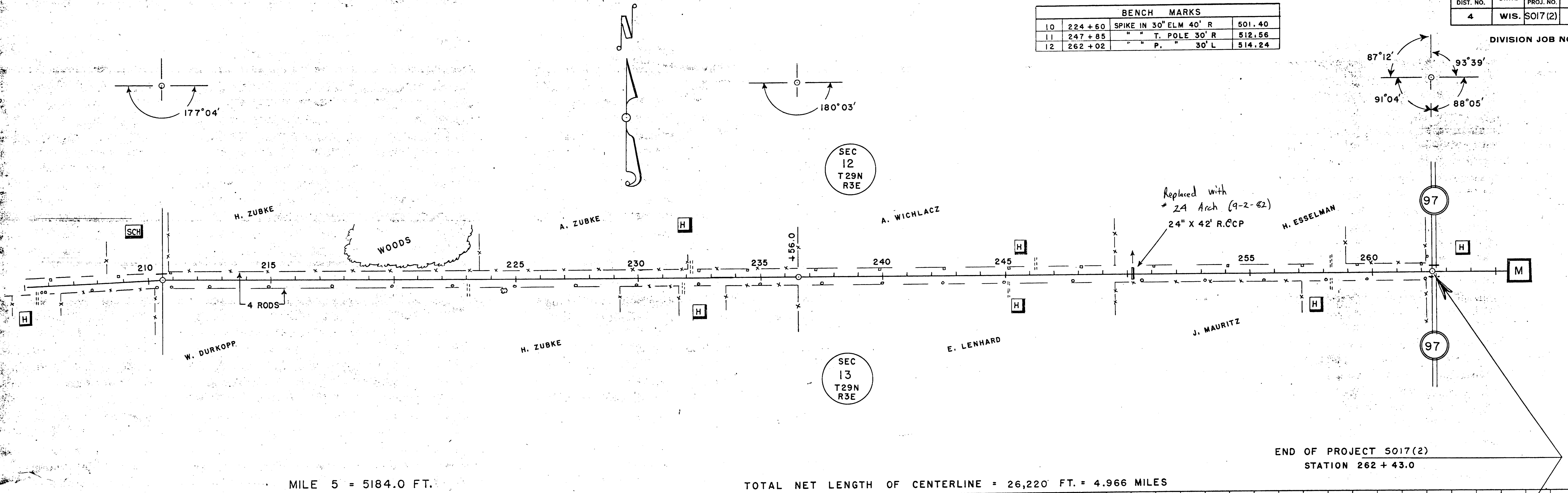

MILE 5 = 5184.0 FT.

TOTAL NET LENGTH OF CENTERLINE = 26,220 FT. = 4.966 MILES

END OF PROJECT 5017(2)
 STATION 262 + 43.0

