

INDEX OF SHEETS

- SHEET NO. 1 TITLE
- SHEET NO. 1 TYPICAL CROSS SECTIONS
- SHEET NO. 1 ESTIMATE OF QUANTITIES
- SHEET NO. - MISCELLANEOUS QUANTITIES
- SHEET NO. - RIGHT OF WAY PLAT
- SHEET NO. 2-6 PLAN AND PROFILE STA. 0+00 TO STA. 262+43
- SHEET NO. - STANDARD DETAILS
- SHEET NO. - DRAINAGE STRUCTURES
- SHEET NO. - CROSS SECTIONS

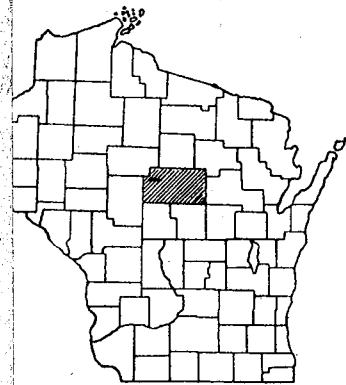

APPROVED FOR
 Marathon County
 Oscar Ruttko
 Chairman, Highway Comm.
 3/10/51

STATE OF WISCONSIN
 STATE HIGHWAY COMMISSION OF WISCONSIN

COUNTY AND HIGHWAY	ROUTE AND SECTION	CLASS AND AGREEMENT		FEDERAL DIVISION OFFICE	SHEET NUMBER	TOTAL SHEETS
		STATE	FEDERAL			
37.6	17.0		11.2	WIS. 5N	1	6

PLAN AND PROFILE OF PROPOSED
 C.T.H. "E" - S.T.H. 97
 MARATHON COUNTY
 PROJECT S017 (2)

PROJECT IS TO BE EXECUTED UNDER THE STANDARD SPECIFICATIONS FOR ROAD BRIDGE CONSTRUCTION OF THE HIGHWAY COMMISSION OF WISCONSIN - EDITION OF 1951. ADJUSTED FOR APPROVAL. FEDERAL AID REQUIRED CONTRACT PROVISIONS APPROVED NOV. 8, 1948 AND SPECIAL PROVISIONS AS ATTACHED TO PROPOSALS.

PLAN 1 IN. = 200 FT.
 PROFILE HOR. 1 IN. = 200 FT. VERT. 1 IN. = 20 FT.

ESTIMATE OF QUANTITIES					
TRACT NO.	ITEM NO.	QUANTITY	UNIT	ITEM	
2	2313-1	58650	SQ. YD.	BITUMINOUS ROAD MIX SURFACE	
2	2313-3	90000	GAL.	BITUMINOUS MATERIAL FOR SURFACE COURSE	
1	2313-2	4600	C.Y.	AGGREGATES FOR BITUMINOUS ROAD MIX SURFACE	

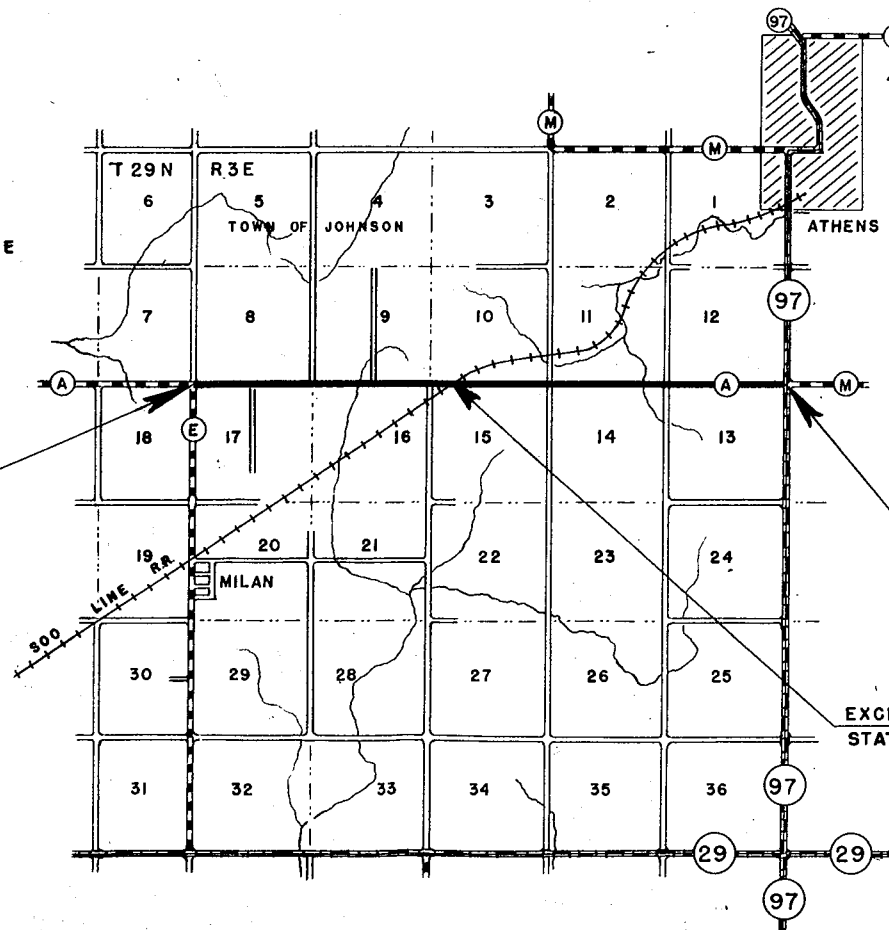

BEGINNING OF PROJECT S017(2)
 STATION 0 + 00 - STATION 353+27 END PROJECT S017(4)

END OF PROJECT S017(2)
 STATION 262 + 43

EXCEPTION TO NET LENGTH
 STATION 111+91.5 TO STATION 112+14.5

LAYOUT

SCALE 1 MILE

TOTAL NET LENGTH OF CENTERLINE = 4.966 MI.

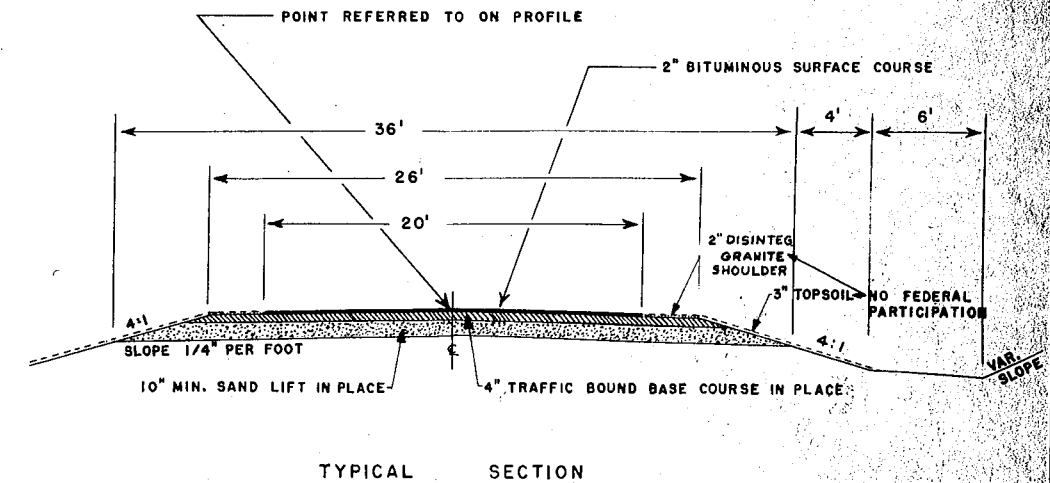

TYPICAL SECTION

CONVENTIONAL SIGNS	
LINE	CULVERTS IN PLACE
PROPERTY LINE	CULVERTS REQUIRED
BOUNDARY OR RANGE LINE	DROP INLET
SECTION LINE	POWER POLE
RIGHT OF WAY LINE	TELEPHONE OR TELEGRAPH POLE
LEFT RIGHT OF WAY LINE	RIGHT OF WAY MARKERS
FENCE WOVEN	REFERENCE STAKE FOR HUBS ONLY
FENCE BARBED	MARSH
LINE	HEDGE
CORPORATE OR CITY LIMITS	TREES
PROPERTY LINE PL 32.8	GROUND ELEVATION DATUM LINE 73.9
VEHICLED WAY OR P.E.	GRADE ELEVATION DATUM LINE 73.6
ROADS	
OR SURVEY LINE	

STATE HIGHWAY COMMISSION OF WISCONSIN
 MADISON, WIS.

SURVEYOR C.E.C. NOTE BOOK
 DIVISION COMPUTER C.E.C. M. O. CHECKER
 DIVISION CHECKER R.J.R. CORRECT

CORRECT:
 DATE 2/14/51 W.J. Haselton DIVISION ENGINEER

RECOMMENDED FOR APPROVAL:
 DATE 2/16/51 A. P. Huber CONSTRUCTION ENGINEER

APPROVED:
 DATE 2/24/51 E.C. Ruttko STATE HIGHWAY ENGINEER

DEPARTMENT OF COMMERCE
 BUREAU OF PUBLIC ROADS

RECOMMENDED FOR APPROVAL:
 DISTRICT ENGINEER DATE

APPROVED:
 DIVISION ENGINEER DATE

BENCH MARKS			
4	51 82	SPIKE IN T. POLE 30 R	496.80
5	79 42	" P. " 30 L	494.65
6	104 38	" P. " 30 L	502.11

FED. ROAD DIST. NO.	STATE	FED. AID PROJ. NO.	SHEET NO.	TOTAL SHEETS
4	WIS.	SO17(2)	3	6

DIVISION JOB NO.

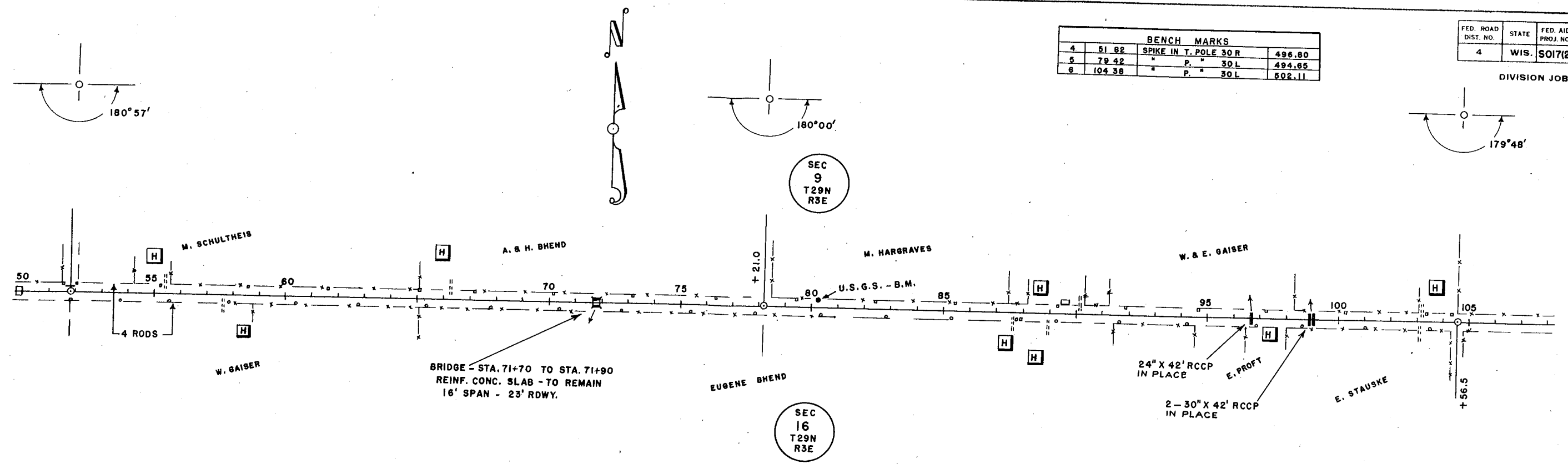

MILE 2 = 5274.8 FT.

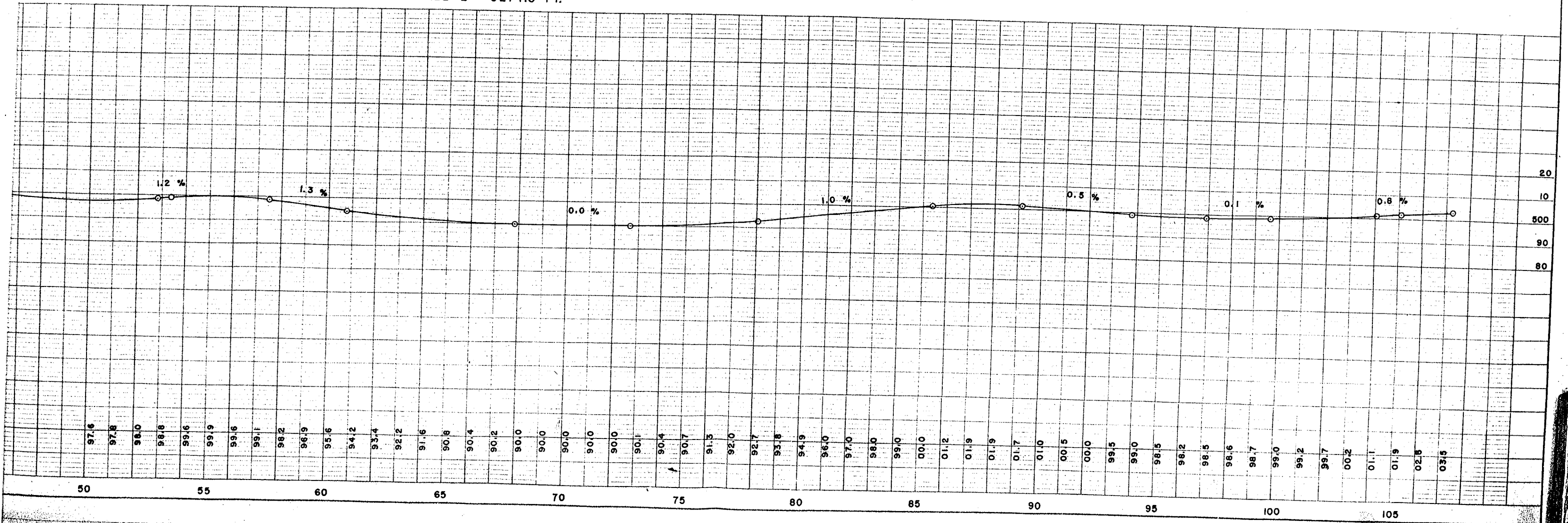

FED. ROAD DIST. NO.	STATE	FED. AID PROJ. NO.	SHEET NO.	TOTAL SHEETS
4	WIS.	5017(2)	4	6

DIVISION JOB NO. _____

BENCH MARKS				
6	104+38	SPIKE IN P. POLE	30' L	502.11
7	143+29	" " T	30' R	522.82
8	157+98	" " T	30' R	498.66

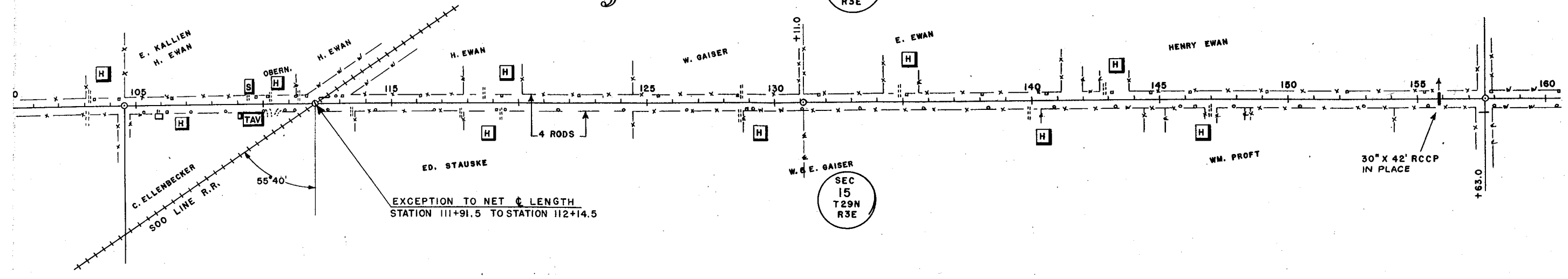
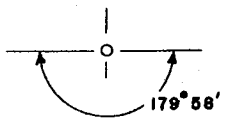
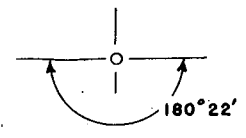
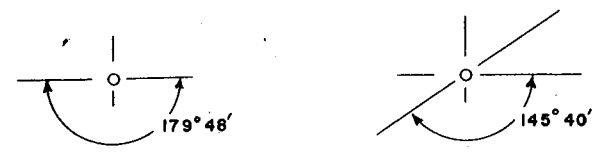

MILE 3 = 5283.5 FT.

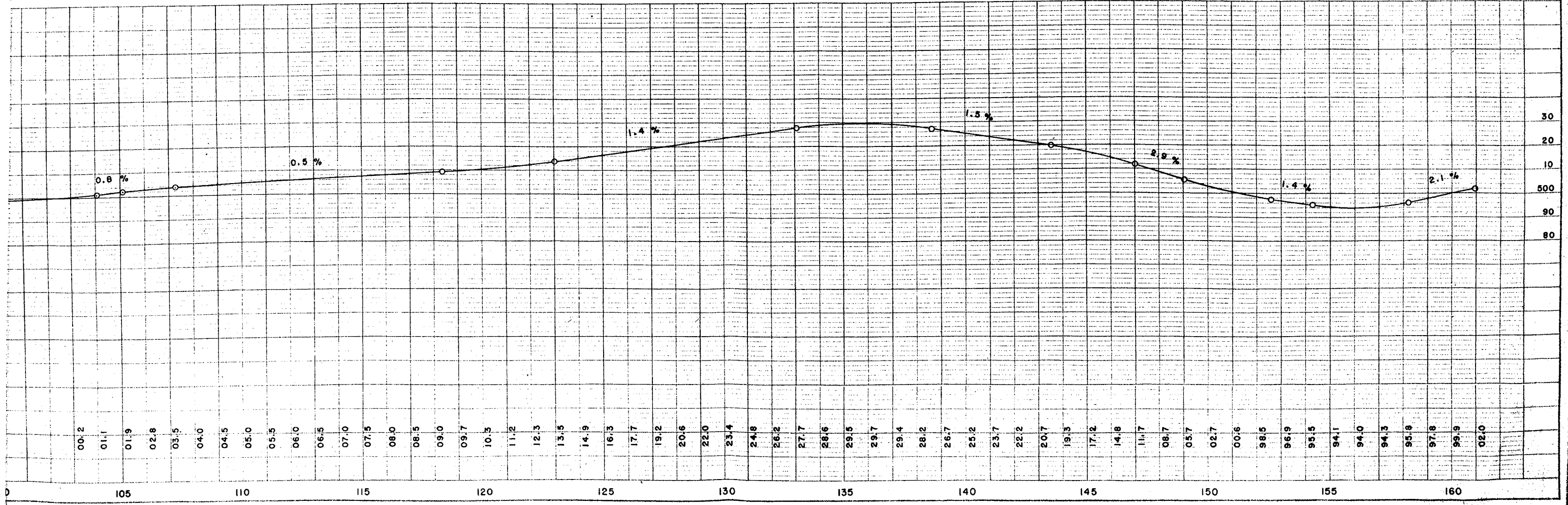

BENCH MARKS			
8	157 + 95	SPIKE IN T. POLE 30' R	498.66
9	175 + 56	" " P. " 30' L	504.34

FED. ROAD DIST. NO.	STATE	FED. AID PROJ. NO.	SHEET NO.	TOTAL SHEETS
4	WIS.	SO17(2)	5	6

DIVISION JOB NO.

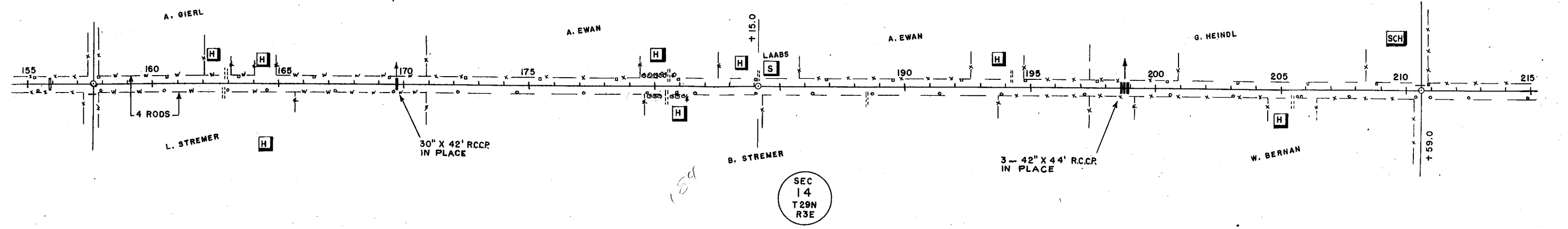
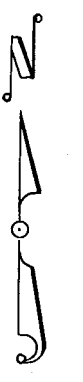
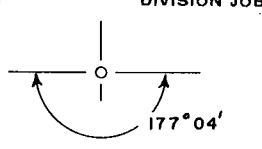
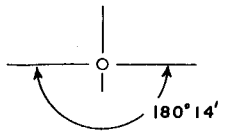
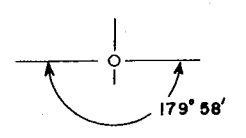

MILE 4 = 5296.0 FT.

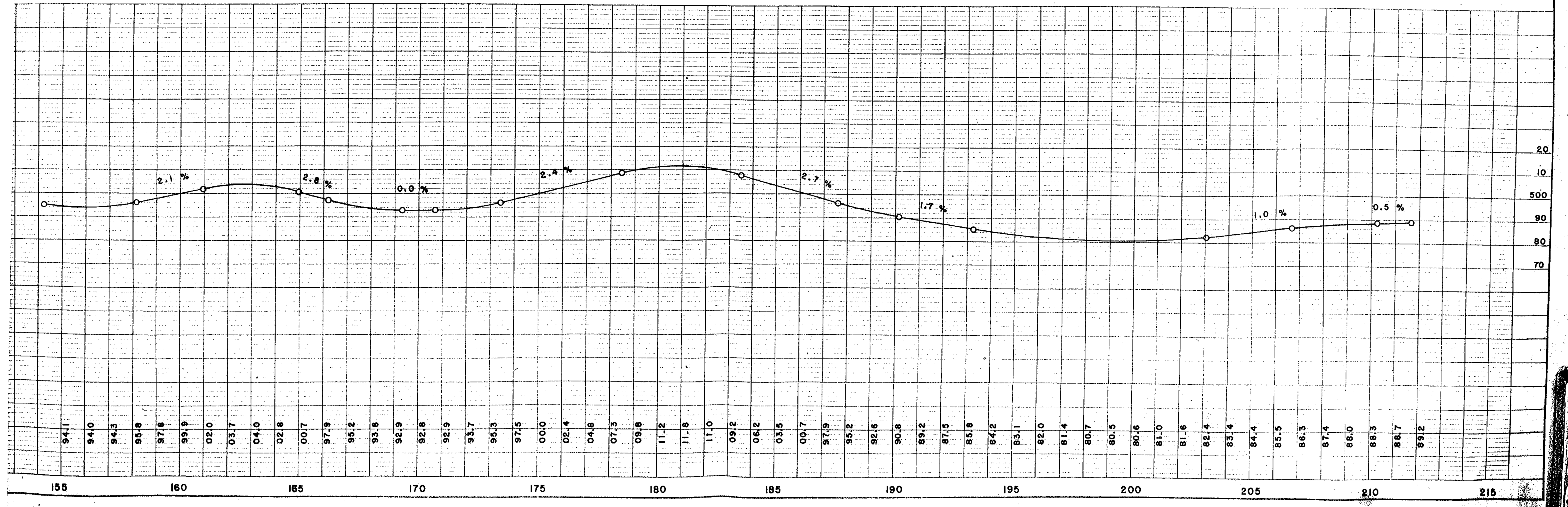

FED. ROAD DIST. NO.	STATE	FED. AID PROJ. NO.	SHEET NO.	TOTAL SHEETS
4	WIS.	5017(2)	6	6

BENCH MARKS			
10	224 + 80	SPIKE IN 30' ELM 40' R	501.40
11	247 + 85	" " T. POLE 30' R	512.56
12	262 + 02	" " P. " 30' L	514.24

DIVISION JOB NO. _____

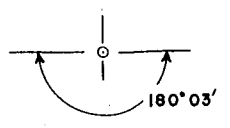
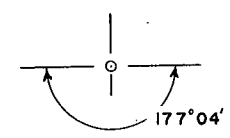
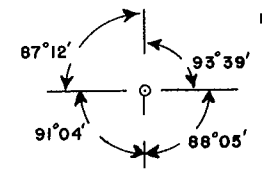

SEC 12
T29N
R3E

SEC 13
T29N
R3E

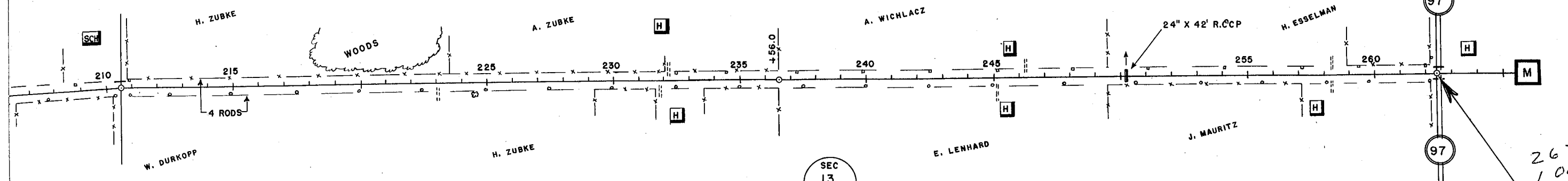

262
104
158

END OF PROJECT 5017(2)
STATION 262 + 43.0

MILE 5 = 5184.0 FT.

TOTAL NET LENGTH OF CENTERLINE = 26,220 FT. = 4.966 MILES

