

COUNTY AND HIGHWAY	ROUTE AND SECTION	CLASS AND AGREEMENT		S & R REGION DIVISION	SHEET NUMBER	TOTAL SHEETS
		STATE	FEDERAL			
37.6	22.0		11.1	4 WIS.	1	

INDEX OF SHEETS

- SHEET NO. 1 TITLE
- SHEET NO. 2-2.1 TYPICAL CROSS SECTIONS
- SHEET NO. 3 ESTIMATE OF QUANTITIES
- SHEET NO. 3A MISCELLANEOUS QUANTITIES
- SHEET NO. 4-4.4 RIGHT OF WAY PLAT
- SHEET NO. 5-10 PLAN AND PROFILE STA. 13+54.9 TO STA. 155+00
- SHEET NO. STANDARD DETAILS
- SHEET NO. DRAINAGE STRUCTURES
- SHEET NO. CROSS SECTIONS

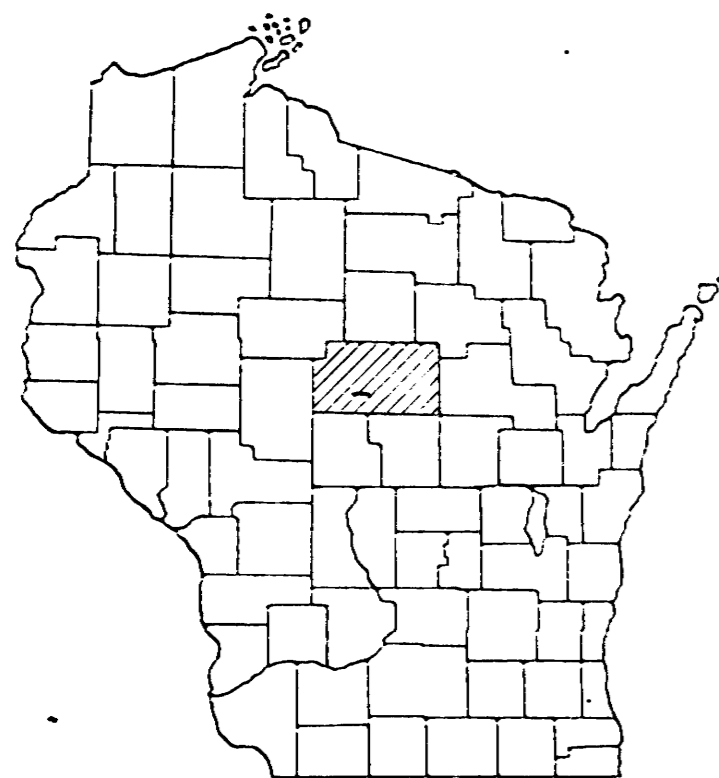

STATE OF WISCONSIN
STATE HIGHWAY COMMISSION OF WISCONSIN

PLAN AND PROFILE OF PROPOSED
S.T.H. 97-ROZELLVILLE ROAD
C.T.H. C
MARATHON COUNTY
PROJECT S022(1)

PLAN 1 IN. = 100 FT. & 50 FT.
PROFILE HOR. 1 IN. = 100 FT. & 1 IN. = 50 FT. VERT. 1 IN. = 10 FT.
CROSS SECTIONS HOR. 1 IN. = 5 FT. VERT. 1 IN. = 5 FT.

DESIGN DESIGNATION

ADT	1967	650
ADT	1987	1100
DHV		165
D		60-40
T		5
V		50 M.P.H.

BEGINNING OF PROJECT S022(1)
STA. 13+54.9=

STA. 348+32.2 PROJECT S015(8)
50' NORTH AND 4' WEST OF THE N.W. COR. OF SEC. 18
T 26N. R 4E

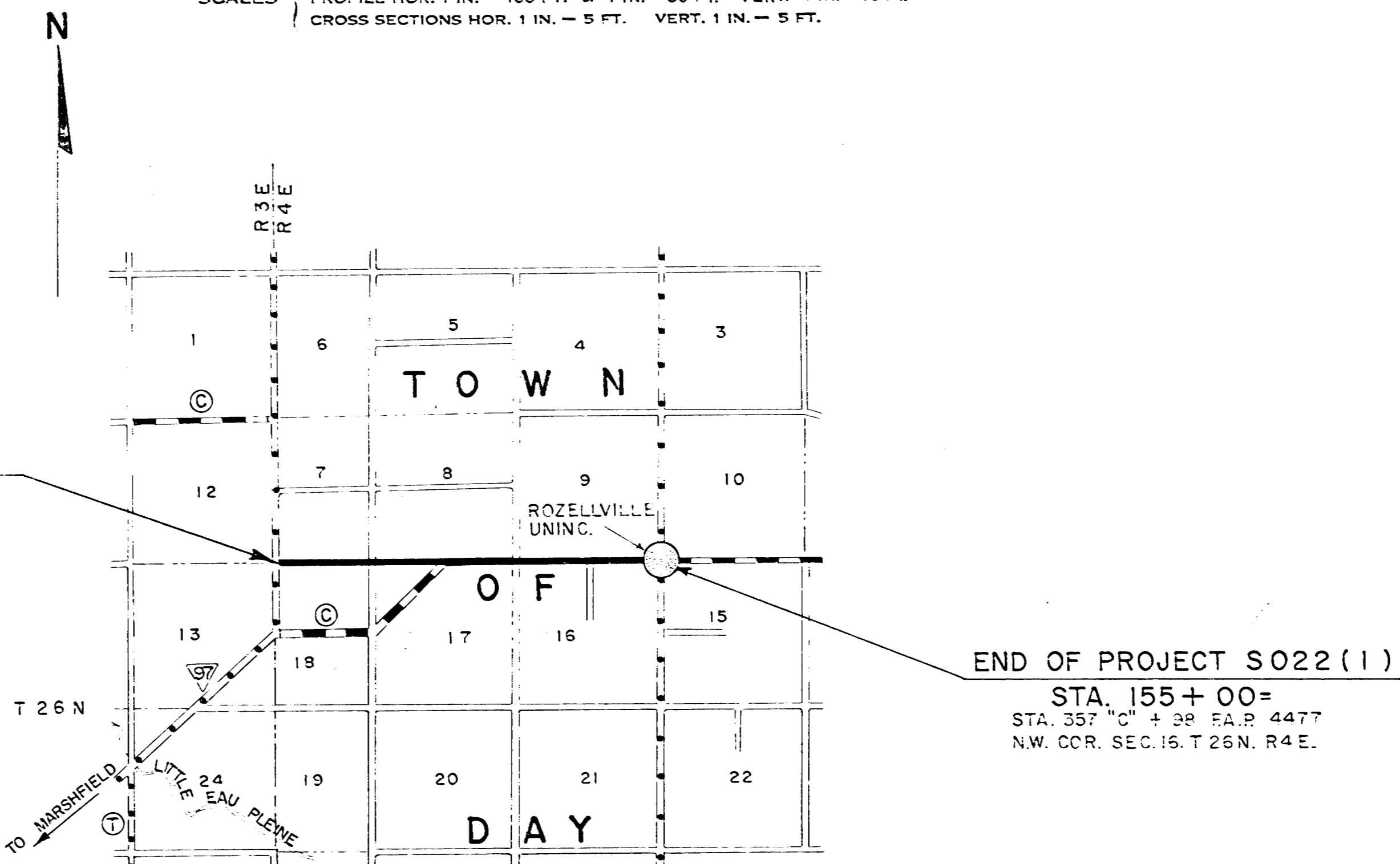

END OF PROJECT S022(1)
STA. 155+00=
STA. 357 "C" + 38 F.A.R. 4477
N.W. COR. SEC. 15. T 26N. R 4E.

CONVENTIONAL SIGNS

STATE LINE	-----	CULVERTS IN PLACE	-----
COUNTY LINE	-----	CULVERTS REQUIRED	-----
TOWNSHIP OR RANGE LINE	-----	DROP INLET	-----
SECTION LINE	-----	POWER POLE	-----
NEW RIGHT OF WAY LINE	-----	TELEPHONE OR TELEGRAPH POLE	-----
PRESENT RIGHT OF WAY LINE	-----	RIGHT OF WAY MARKERS	-----
WIRE FENCE { WOVEN	-----	REFERENCE STAKE FOR HUBS ONLY	-----
{ BARBED	-----	MARSH	-----
LOT LINE	-----	HEDGE	-----
CORPORATE OR CITY LIMITS	-----	TREES	-----
PROPERTY LINE	-----	GROUND ELEVATION	DATUM LINE 7516 73.9
TRAVELED WAY OR P.E.	-----	GRADE ELEVATION	DATUM LINE 7516 73.9
RAILROADS	-----		
BASE OR SURVEY LINE	-----		

LAYOUT

SCALE 1 MILE

TOTAL NET LENGTH OF CENTERLINE = 2.679 MI.



AUG 14 1967

STATE HIGHWAY COMMISSION OF WISCONSIN MADISON, WIS.	
SURVEYOR R.K.F.	NOTE BOOK 4765
DIVISION COMPUTER J.E.S.	M.O. CHECKER
DISTRICT CHECKER E.P.M.	CORRECT
CORRECT	
DATE	DISTRICT ENGINEER
RECOMMENDED FOR APPROVAL	
DATE	CHIEF DESIGN ENGINEER
APPROVED	
DATE	STATE HIGHWAY ENGINEER
DEPARTMENT OF COMMERCE BUREAU OF PUBLIC ROADS	
APPROVED	
DATE	
DIVISION ENGINEER	

Plan as submitted to L. Fuller 8/16/67 showing construction easements and out face stream sewer & ditch. WRA!

SAVE

LEGEND

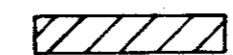
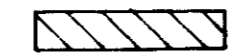
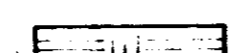
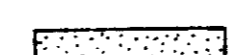
-  BITUMINOUS CONCRETE PAVEMENT
-  CONCRETE PAVEMENT (IN PLACE)
-  GRAVEL OR CRUSHED STONE BASE COURSE
-  GRAVEL OR CRUSHED STONE BASE COURSE (SHOULDER MATERIAL)
-  3" SALVAGED TOPSOIL (SEED AND FERTILIZE)
-  GRANULAR SUBBASE COURSE

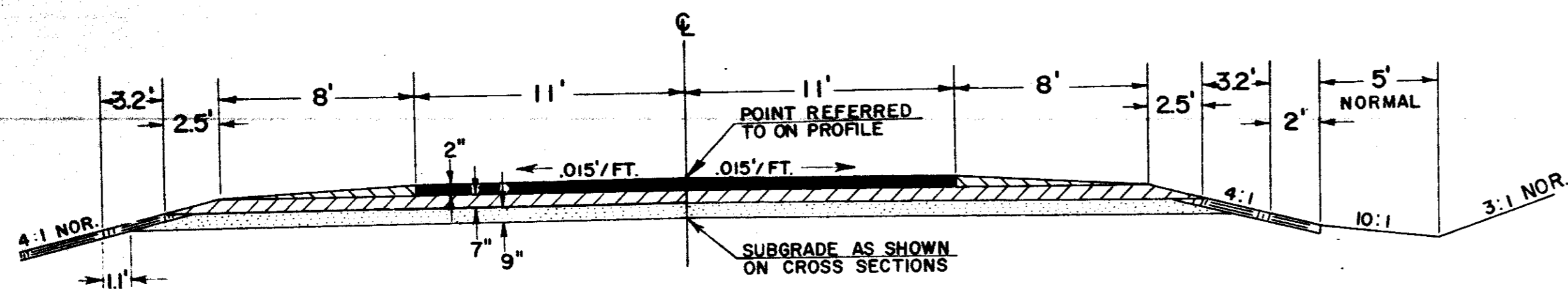

TYPICAL SECTION
 STA. 13+54.9 TO STA. 81+75
 STA. 96+00 TO STA. 105+00, # 3" BITUMINOUS CONCRETE PAVEMENT

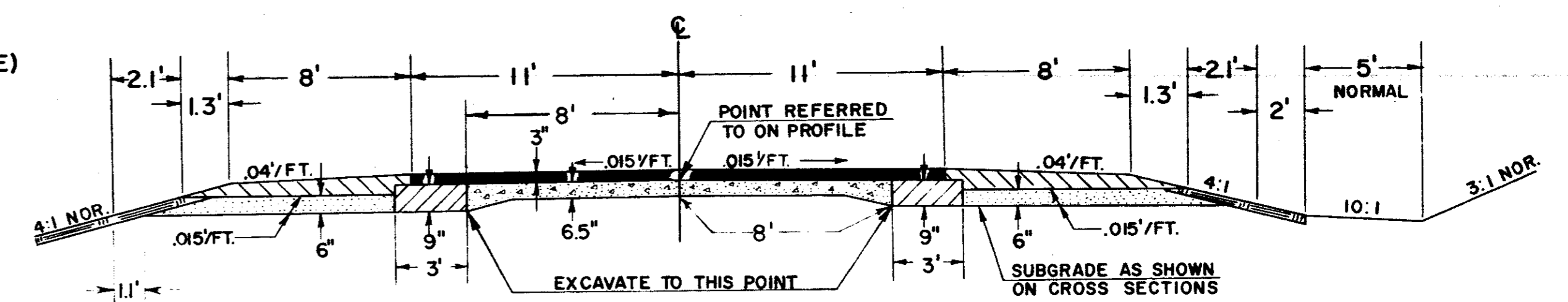

TYPICAL CAPPING SECTION
 STA. 81+75 TO STA. 96+00
 STA. 105+00 TO STA. 140+00
 STA. 110+00 TO STA. 115+00 (5" BIT. CONC. PAVEMENT)

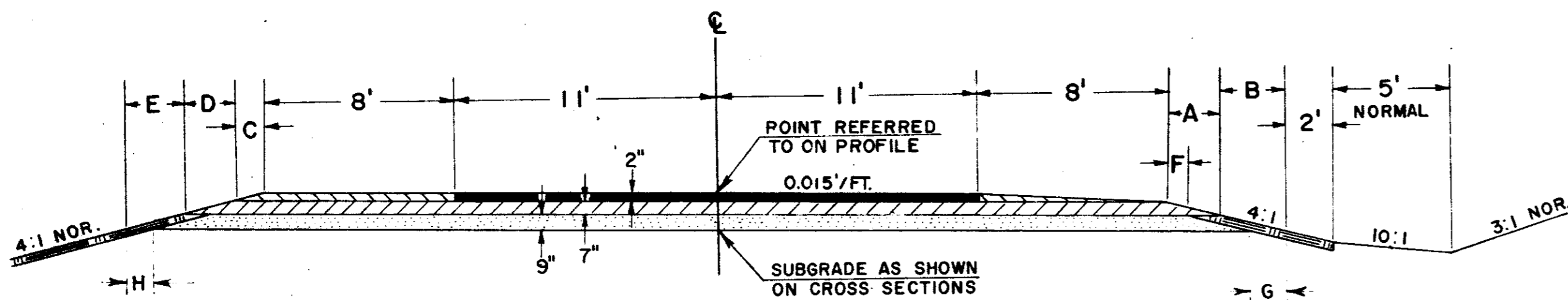

TYPICAL SUPERELEVATED SECTION

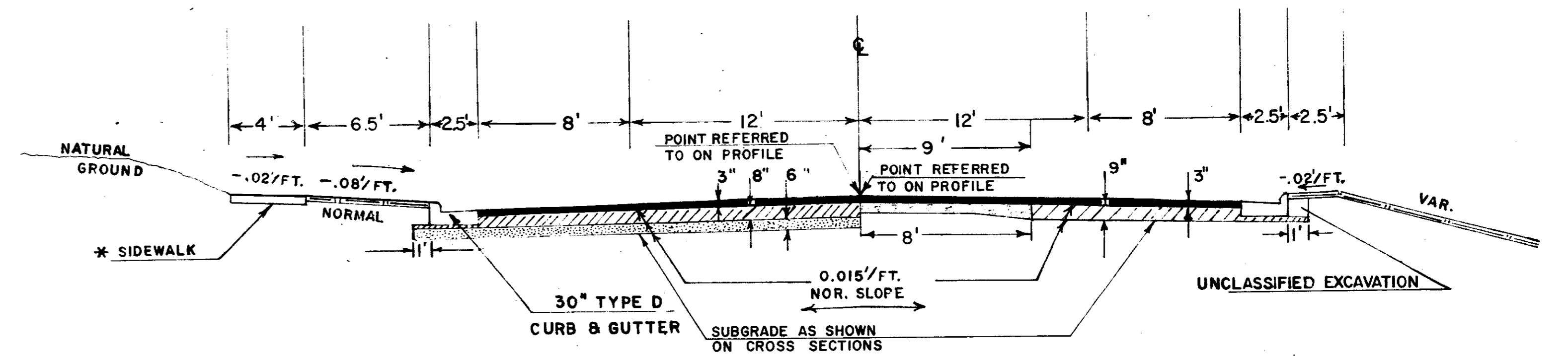

TYPICAL 1/2 SECTION
 STA. 149+00-155+00

TYPICAL 1/2 SECTION
 STA. 140+00-149+00

DEGREE	P.I. STA.	SE / FT	A	B	C	D	E	F	G	H
0° 30' RT.	29+04.9	R.C.	2.5'	3.2'	0.6'	2.2'	2.8'	0.0'	1.1'	0.9'
0° 45' LT.	49+29.4	R.C.	2.2'	2.8'	0.0'	2.5'	3.2'	0.6'	0.9'	1.1'
0° 30' RT.	101+04.4	R.C.	2.5'	3.2'	0.6'	2.2'	2.8'	0.0'	1.1'	0.9'

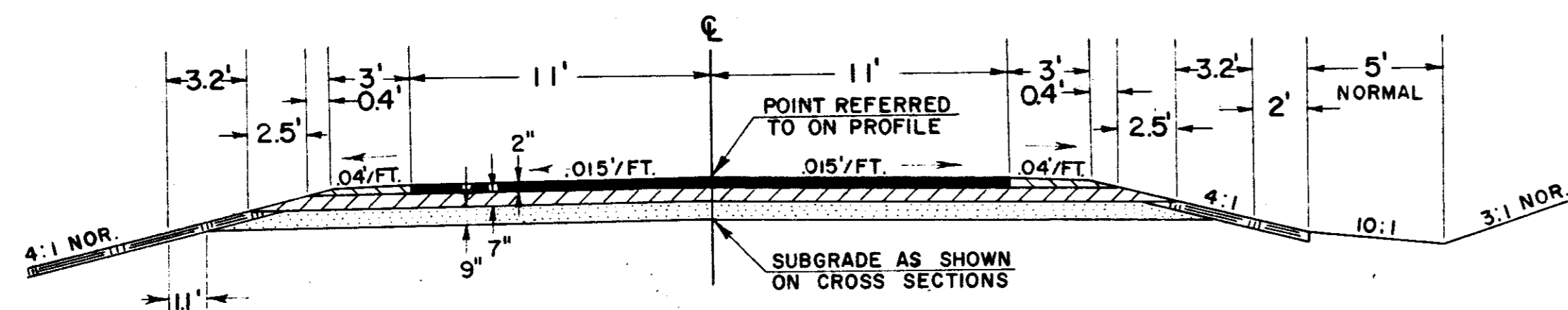

TYPICAL SECTION "E" LINE

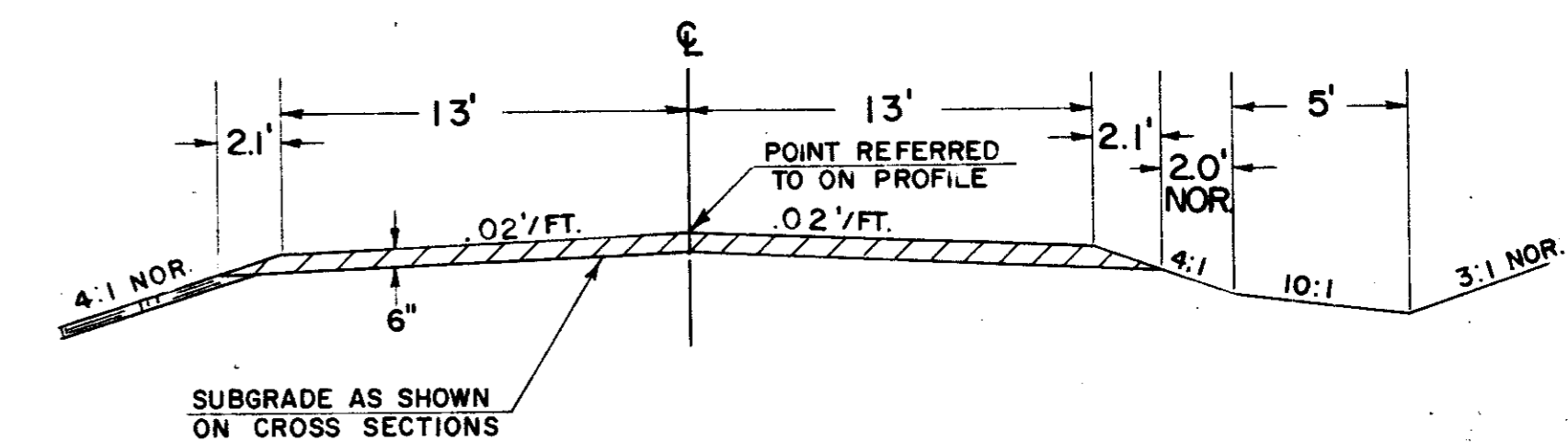

TYPICAL SECTION "B" & "C" LINES

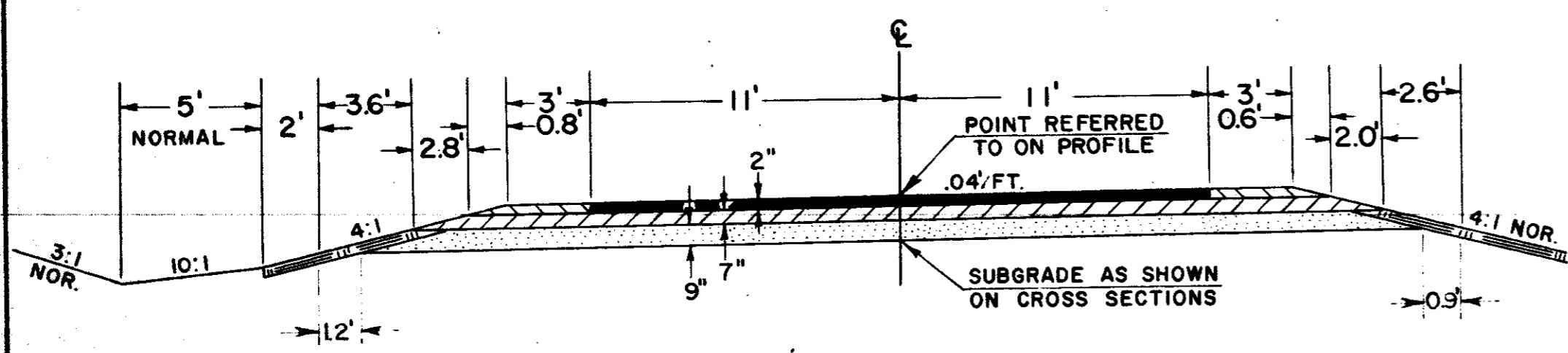

TYPICAL SUPERELEVATED SECTION "E" LINE

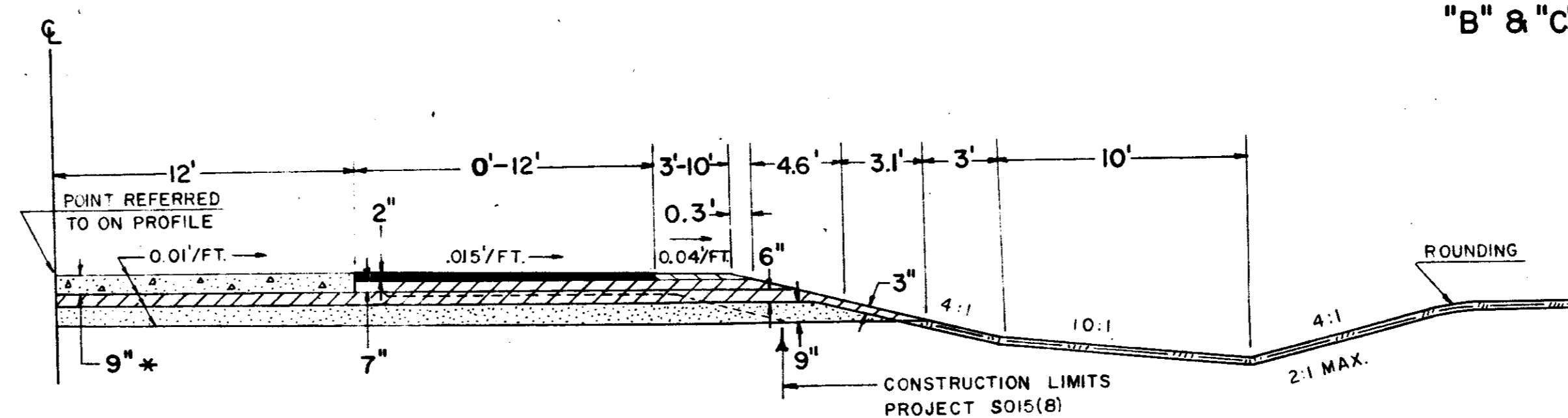

ULTIMATE HALF SECTION S.T.H. 97
 STA. 344+10 TO STA. 350+10

* NOT A PART OF THIS CONTRACT

TYPICAL CROSS SECTIONS FOR

- 38' ROADWAY - C.T.H. "C"
- 28' ROADWAY - "E" LINE
- 26' ROADWAY - "B" & "C" LINE

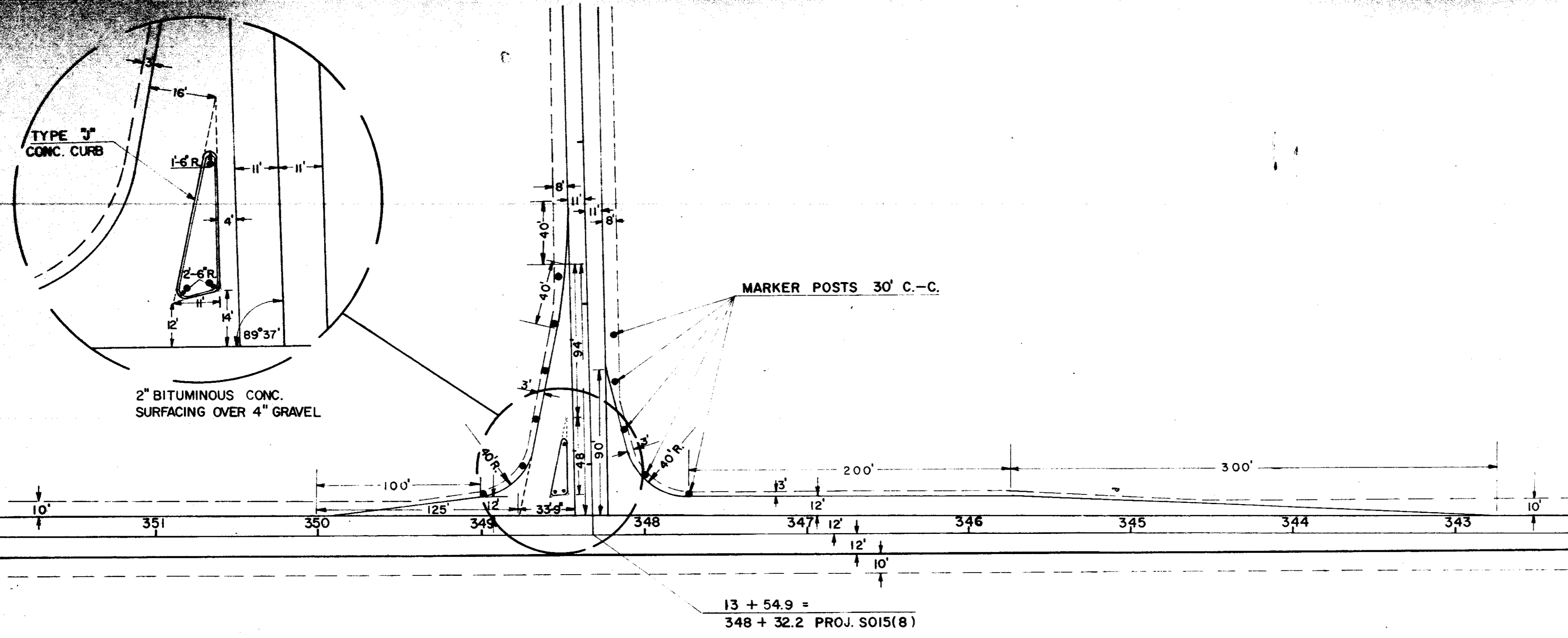

TYPE "J" INTERSECTION

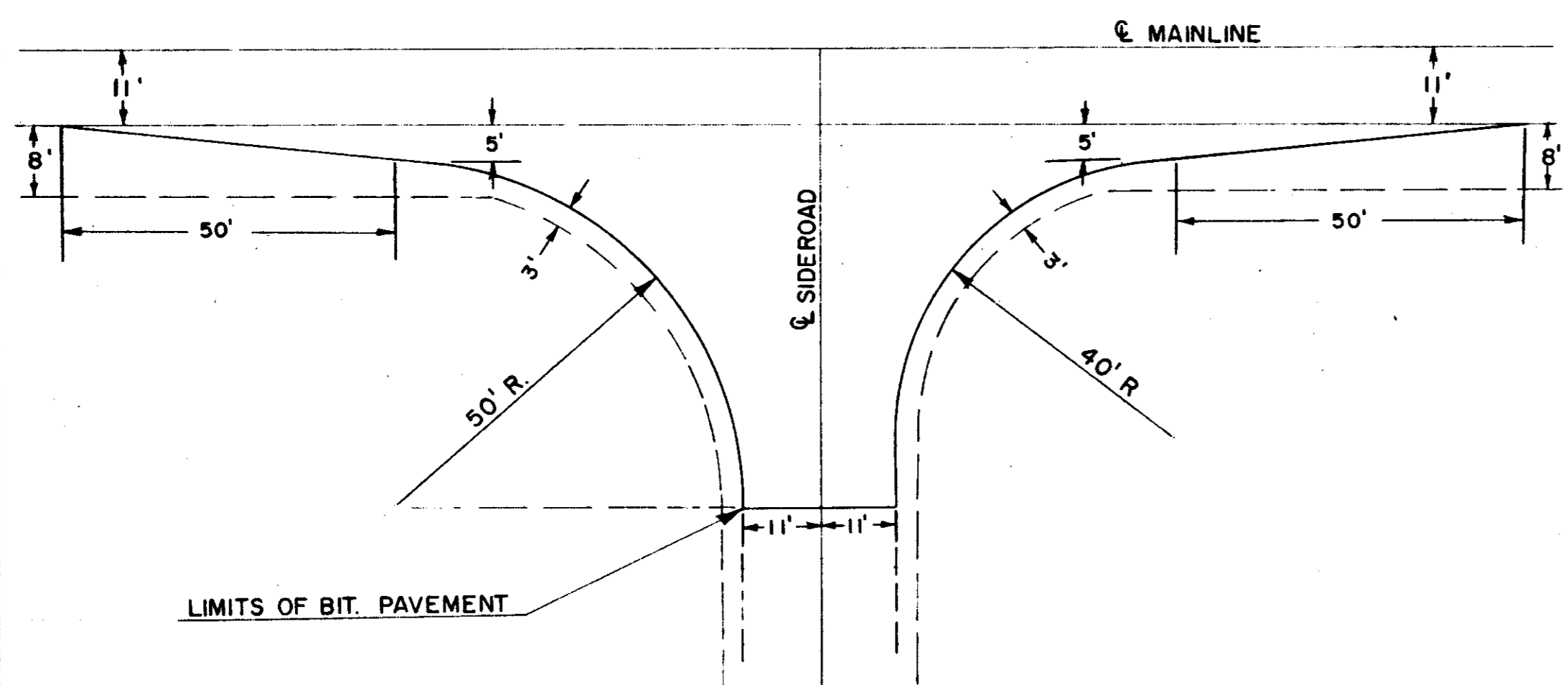

TYPE "S" INTERSECTION

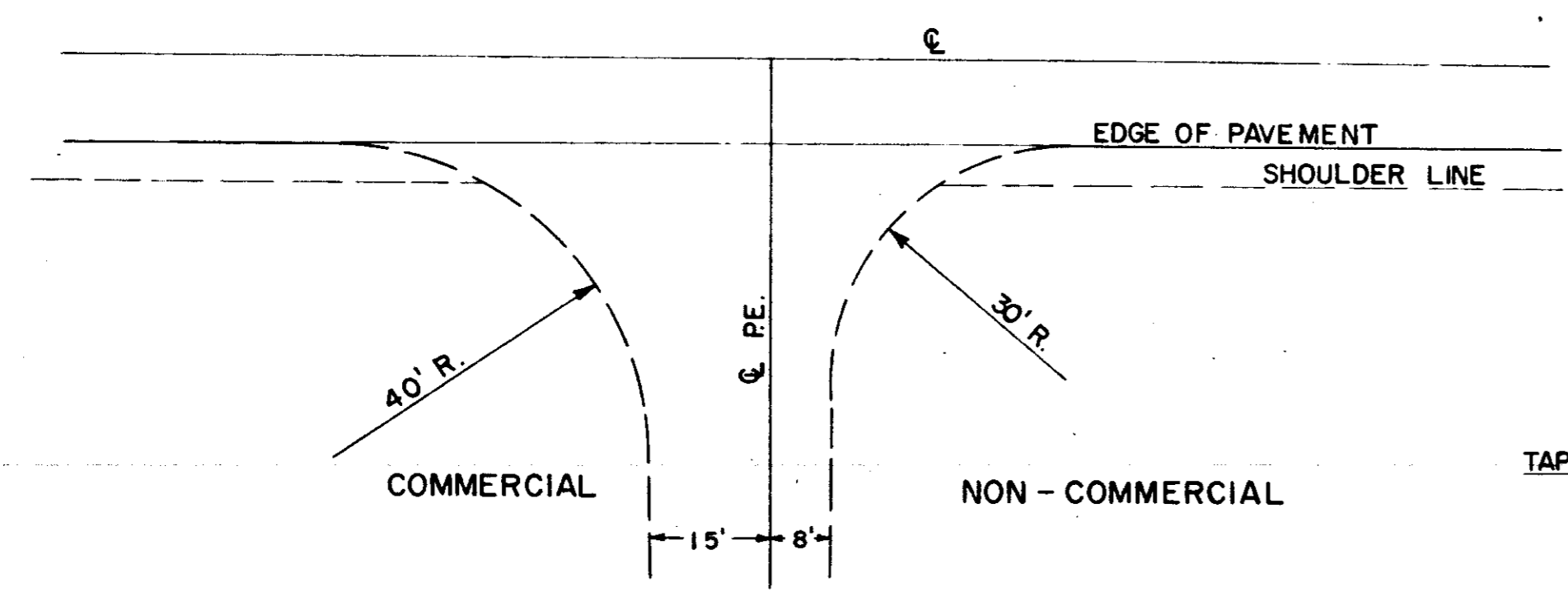

TYPICAL HALF PLAN OF ENTRANCES

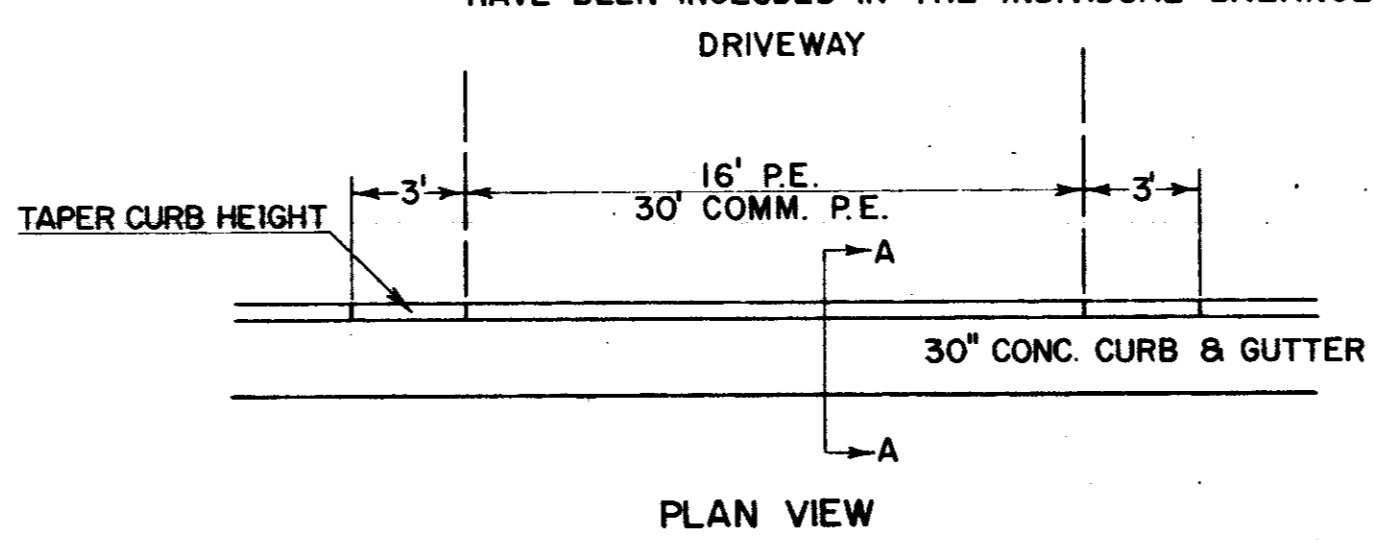

PLAN VIEW

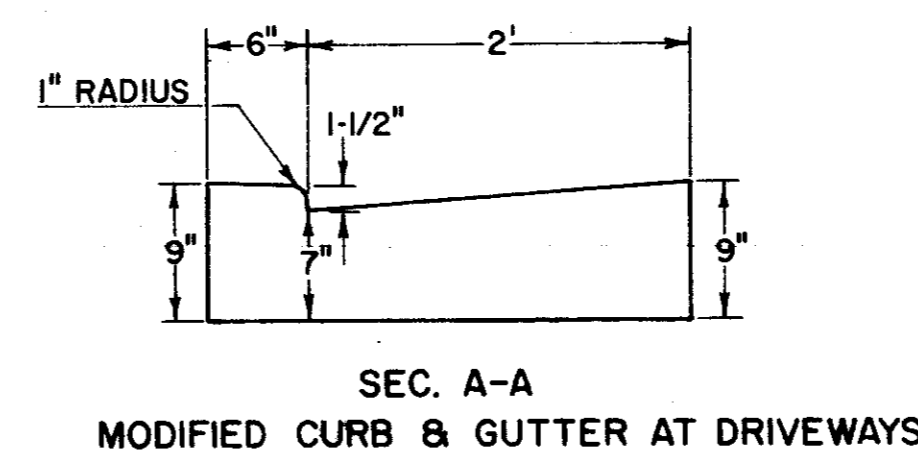

SEC. A-A
MODIFIED CURB & GUTTER AT DRIVEWAYS

GENERAL NOTES:
 WHEN THE QUANTITY OF THE ITEMS OF SUBBASE, BASE, OR SURFACE COURSE ARE MEASURED FOR PAYMENT BY THE TON OR BY THE CUBIC YARD, THE DEPTH OR THICKNESS OF THE COURSE SHOWN ON THE PLANS IS APPROXIMATE AND THE ACTUAL THICKNESS WILL DEPEND UPON THE DISTRIBUTION OF THE MATERIAL AS DIRECTED BY THE ENGINEER.

SALVAGED TOPSOIL, WHERE REQUIRED, IS PLACED TO APPROXIMATE DEPTH OF 3" AT TIME OF PLACING.

THE LOCATION OF PRIVATE ENTRANCES IS APPROXIMATE AND THE EXACT LOCATION IS TO BE DETERMINED IN THE FIELD BY THE ENGINEER.

AT ENDS OF CURB & GUTTER, VARY HEIGHT OF CURB 0" TO 6" IN 4'.

ALL STONE PILES ON OR PARTIALLY ON THE R/W SHALL BE ENTIRELY REMOVED AND WILL BE PAID FOR AS UNCLASSIFIED EXCAVATION AND HAVE BEEN INCLUDED IN THE INDIVIDUAL BALANCES.

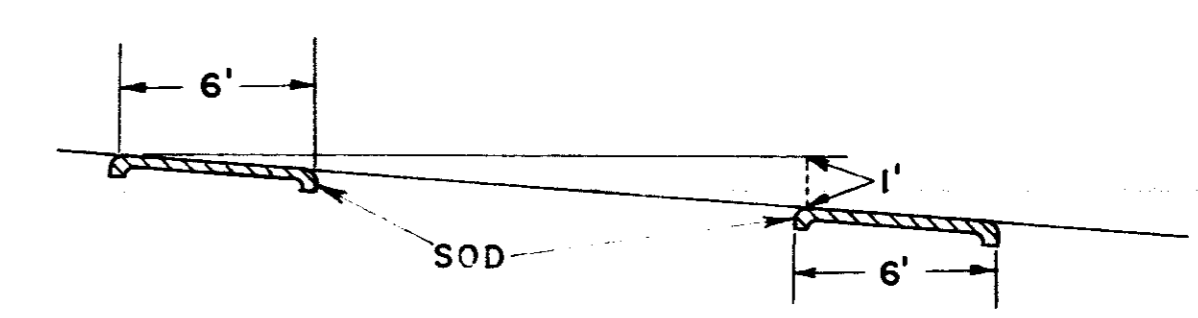

PROFILE OF DITCH GRADE
SHOWING SOD DITCH CHECKS

NOTE: NUMBER REQUIRED WILL BE DETERMINED BY VERTICAL SPACING

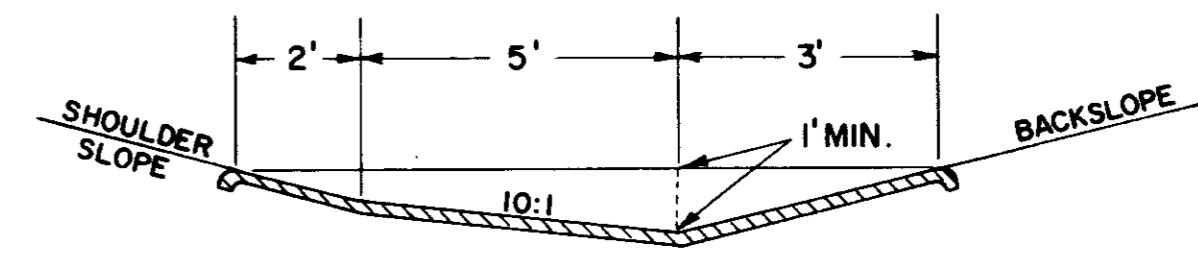

CROSSSECTION OF SOD DITCHES
AND SOD DITCH CHECKS

NOTE: LOCATION AND DIMENSIONS TO FIT FIELD CONDITIONS TO BE ADJUSTED AS DIRECTED BY THE ENGINEER

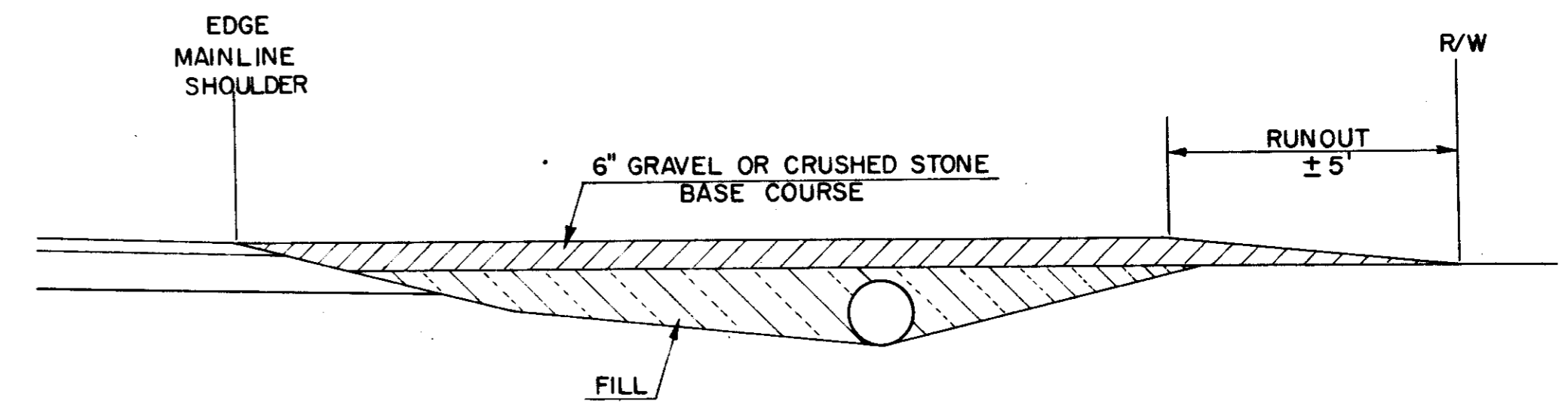

SECTION VIEW OF PRIVATE ENTRANCES

APPLICABLE STANDARD DETAIL DRAWINGS

- 6 - 2.5.2 RIPRAP AT SIDE ROAD CULVERTS AND RIPRAP OR SOD AT PRIVATE ENTRANCE
- 6 - 2.6.5 APRON ENDWALLS FOR CULVERT PIPE AND PIPE ARCH
- 7 - 1.3.5 MARKER POST AND MARKER POSTS FOR RIGHT OF WAY
- 7 - 2.4.12 STEEL PLATE BEAM GUARD & STEEL BEAM MEDIAN GUARD
- 7 - 4.1.5 CONSTRUCTION BARRICADE
- 6 - 2.4.3 MORTAR RUBBLE MASONRY OR RIPRAP FOR CULVERT & CATTLE PASS END WALLS.
- 12 - 1.1.2 LANDMARK REFERENCE MONUMENTS
- 3 - 1.1.7 CONCRETE CURB, GUTTER, COMBINATION CURB & GUTTER, SURFACE DRAIN.
- 5 - 3.4.8 CATCH BASINS AND INLET COVERS
- 5 - 3.5.2 INLETS

MISCELLANEOUS DETAILS

URBAN ENTRANCE DETAILS

BENCH MARKS			
NO	STATION	DESCRIPTION	ELEV.
1	14+37	SPIKE IN TWIN 12" ELM	49' RT. 1272.97
2	22+17	SPIKE IN 14" ELM	51' RT. 1265.63
3	29+05	SPIKE IN FENCE POST	46' RT. 1249.80
4	36+02	SPIKE IN 20" ELM	17' RT. 1239.87

B. P. R. DIVISION	PROJECT	SHEET NUMBER	TOTAL SHEETS
4	S022(1)	5	

DATE	BY	REVISION
12-18-83	J.E.S.	1
12-18-83	J.E.S.	2

PLAN
 DRAWING NO. S022(1)
 NOTE BOOK: ALIGNED CHECKED
 NO. 5785
 FT. OF WAY CHECKED

DATE	BY	REVISION
12-18-83	J.E.S.	1
12-18-83	J.E.S.	2

PROFILE
 DRAWING NO. S022(1)
 NOTE BOOK: GRADES CHECKED
 NO. 5785
 ENGINEER'S OFFICE: C.E.D.

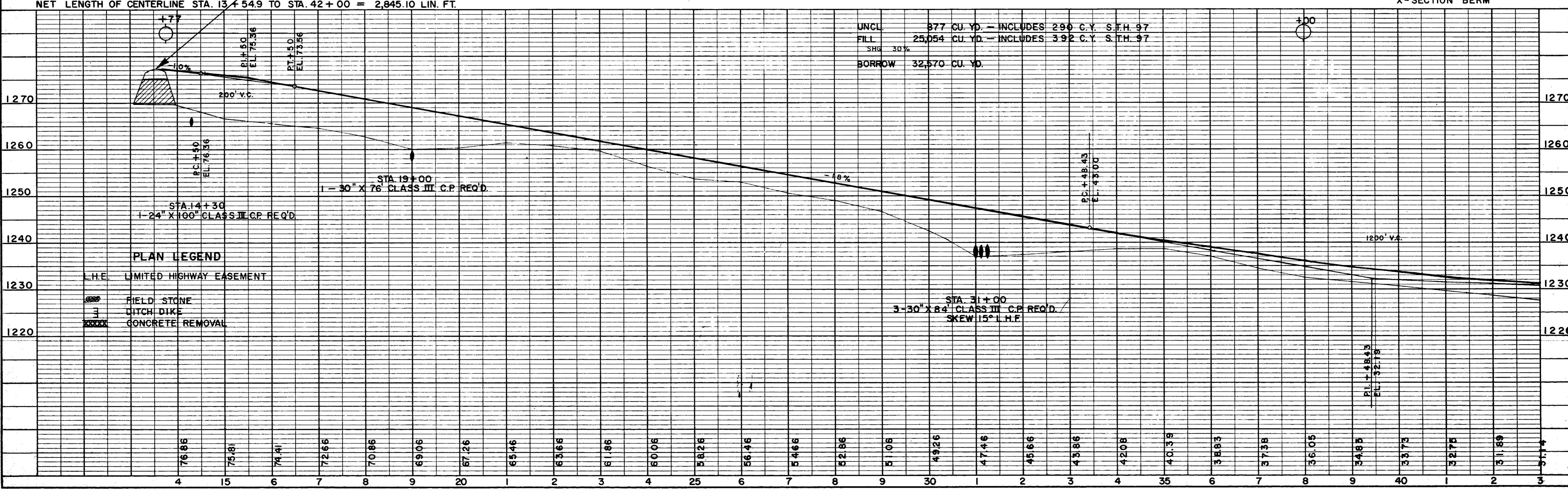
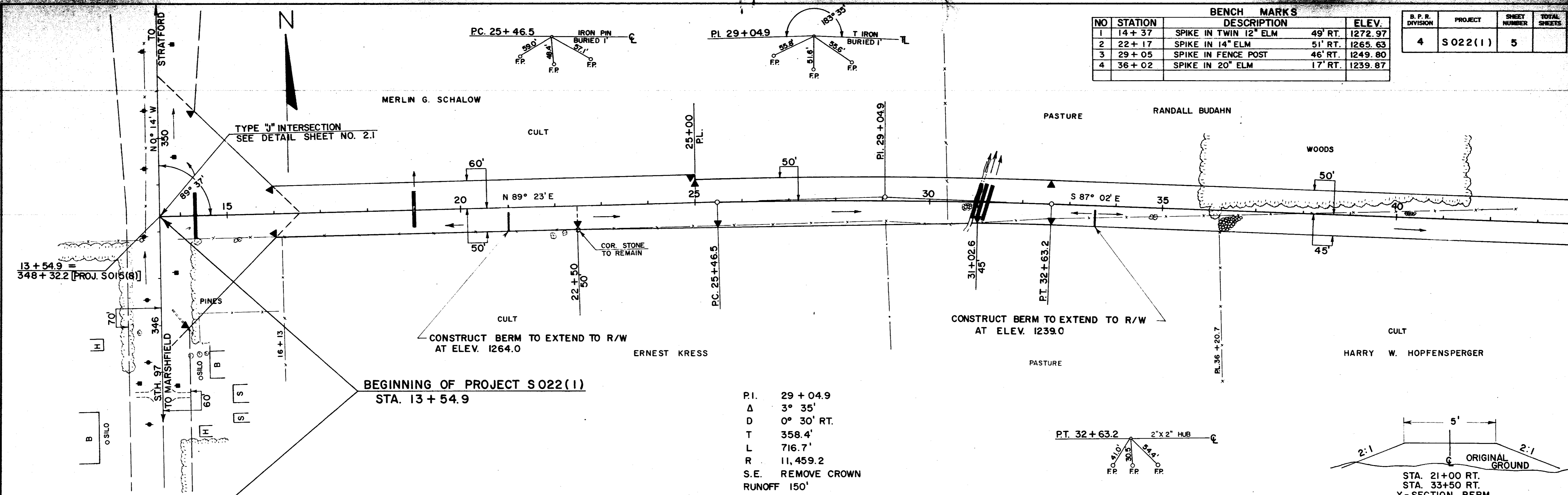
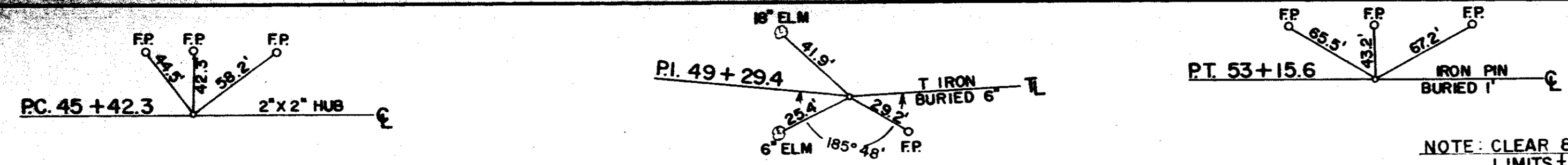
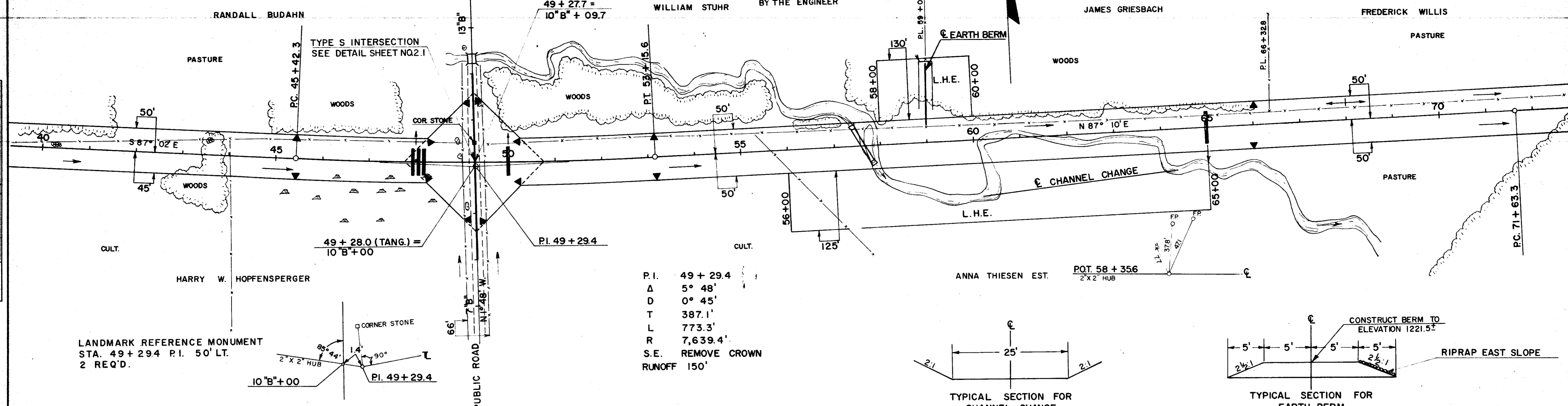

PLATE 1-PLAN-PROFILE
 MADE AND PRINTED IN U.S.A.
 CHARLES BRIDGES COMPANY, INC.



BENCH MARKS			
NO	STATION	DESCRIPTION	ELEV.
5	43+25	SPIKE IN 10" ELM	47' RT. 1229.35
6	48+94	SPIKE IN 18" ELM	8' LT. 1224.70
7	55+10	SPIKE IN 16" ELM	90' LT. 1220.34
8	62+87	SPIKE IN 16" ELM	154' LT. 1221.07

B. P. R. DIVISION	PROJECT	SHEET NUMBER	TOTAL SHEETS
4	S022(1)	6	



NET LENGTH OF CENTERLINE STA. 42+00 TO STA. 72+00 = 3,000 LIN. FT.

UNCL.	1,539	CU. YD.	99 CU. YD. MAIN LINE
			65 CU. YD. "B" LINE
			1,375 CU. YD. CHANNEL CHANGE
FILL	21,958	CU. YD.	20,883 CU. YD. MAIN LINE
			900 CU. YD. "B" LINE
			175 CU. YD. BERM
BORROW	27,006	CU. YD.	

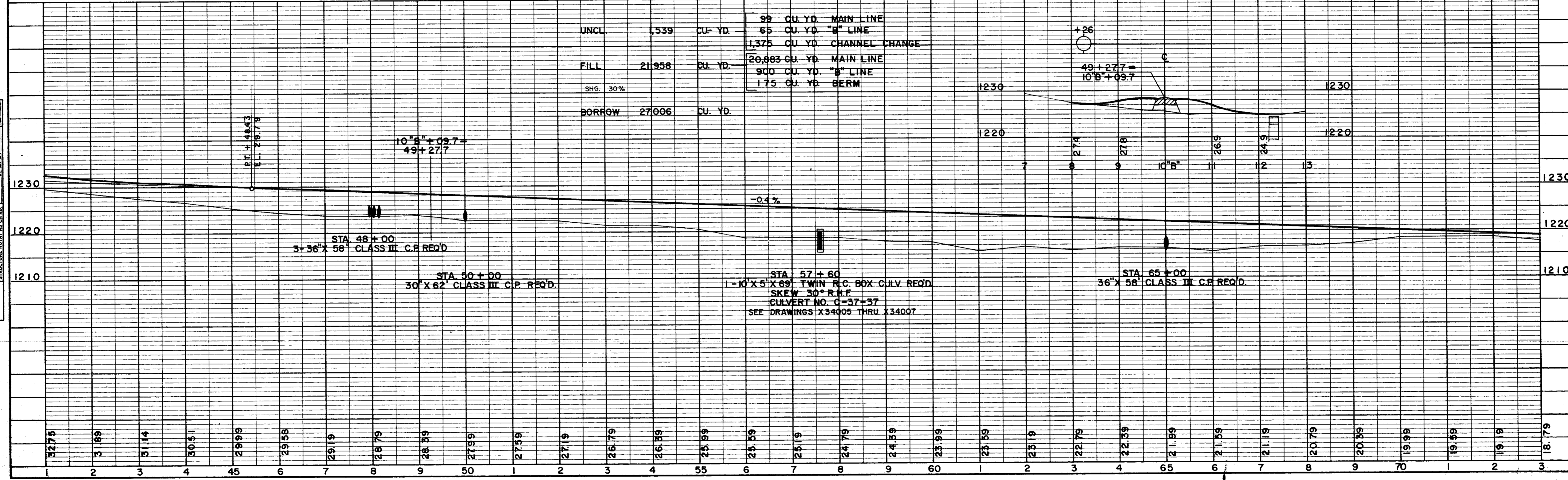

PLAN	REVISIONS
NO. 47.81	DATE
	BY
	CHKD.
	APP'D.
	DATE

PROFILE	REVISIONS
NO. 47.81	DATE
	BY
	CHKD.
	APP'D.
	DATE

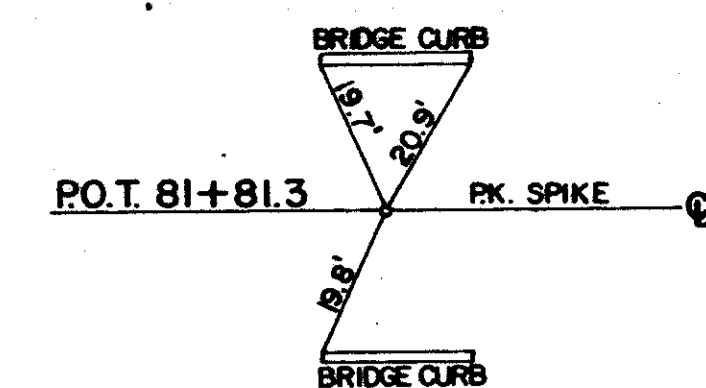
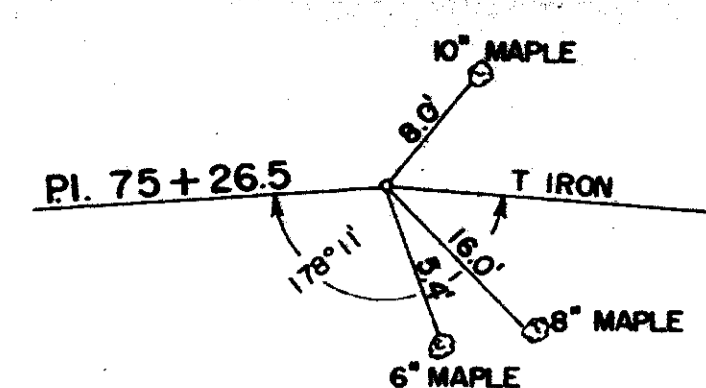
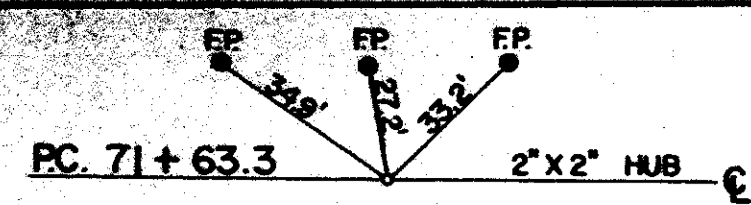

BENCH MARKS			
NO	STATION	DESCRIPTION	ELEV.
9	72+33	SPIKE IN 20" ELM	55' RT. 1217.73
10	80+89	SPIKE IN 22" ELM	27' RT. 1213.40
11	90+32	SPIKE IN TELEPHONE POLE	30' LT. 1220.57
12	101+34	SPIKE IN POWER POLE	71' LT. 1234.52

B. P. R. DIVISION	PROJECT	SHEET NUMBER	TOTAL SHEETS
4	S022 (1)	7	

DATE	BY	REVISION
11-1-58	J. E. S.	1
10-1-58	J. E. S.	2
9-1-58	J. E. S.	3
8-1-58	J. E. S.	4

PLAN
SURVEYED BY J. E. S.
NOTE BOOK ALPHABETICALLY CHECKED.
NO. 4783 RT. OF WAY CHECKED.

DATE	BY	REVISION
11-1-58	J. E. S.	1
10-1-58	J. E. S.	2
9-1-58	J. E. S.	3
8-1-58	J. E. S.	4

PROFILE
SURVEYED BY J. E. S.
NOTE BOOK ALPHABETICALLY CHECKED.
B. M. S. NOTED.
NO. 4783 STRUCTURE NOTATION CHECKED.

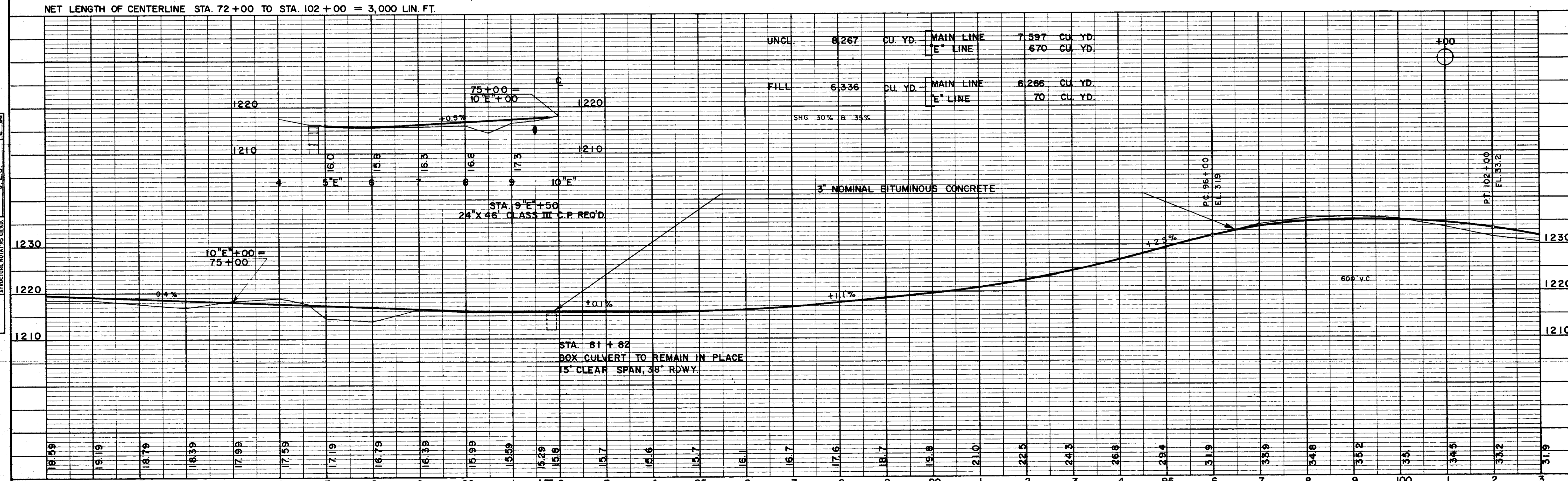
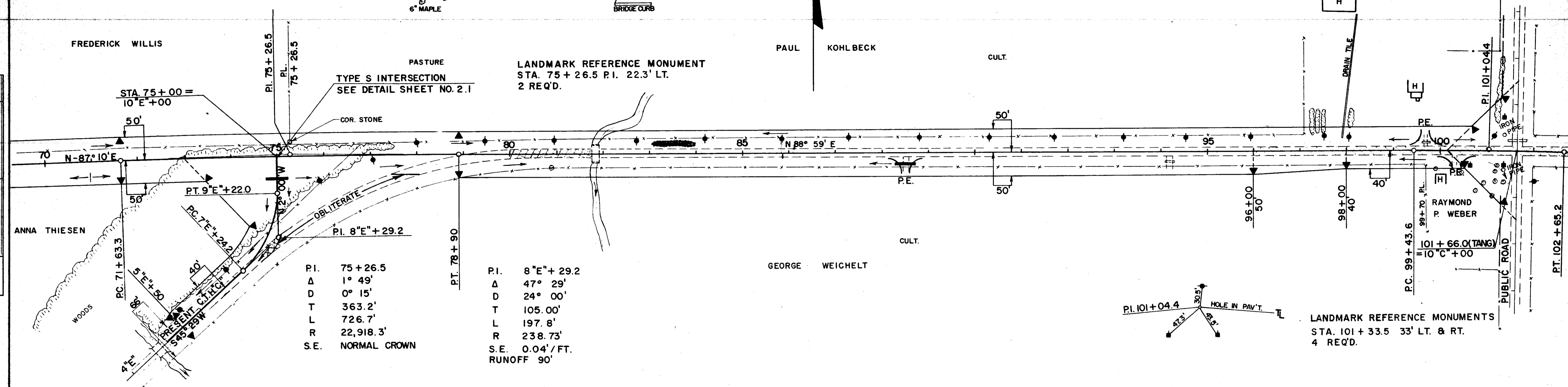
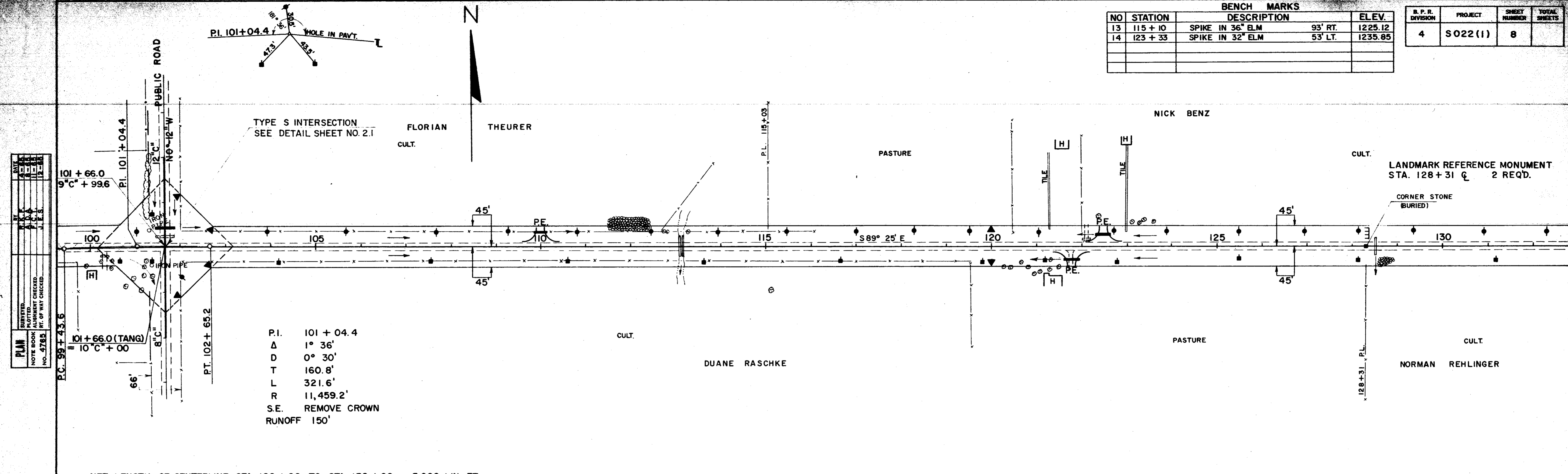

PLATE 1-PLAN-PROFILE S. P. R. & E. C. MADE AND PRINTED IN U.S.A. CHARLES BREWING COMPANY, INC.

BENCH MARKS			
NO	STATION	DESCRIPTION	ELEV.
13	115 + 10	SPIKE IN 36" ELM	93' RT. 1225.12
14	123 + 33	SPIKE IN 32" ELM	53' LT. 1235.85

B. P. R. DIVISION	PROJECT	SHEET NUMBER	TOTAL SHEETS
4	S022(1)	8	



P.I. 101 + 04.4
 Δ 1° 36'
 D 0° 30'
 T 160.8'
 L 321.6'
 R 11,459.2'
 S.E. REMOVE CROWN
 RUNOFF 150'

NET LENGTH OF CENTERLINE STA. 102 + 00 TO STA. 132 + 00 = 3,000 LIN. FT.

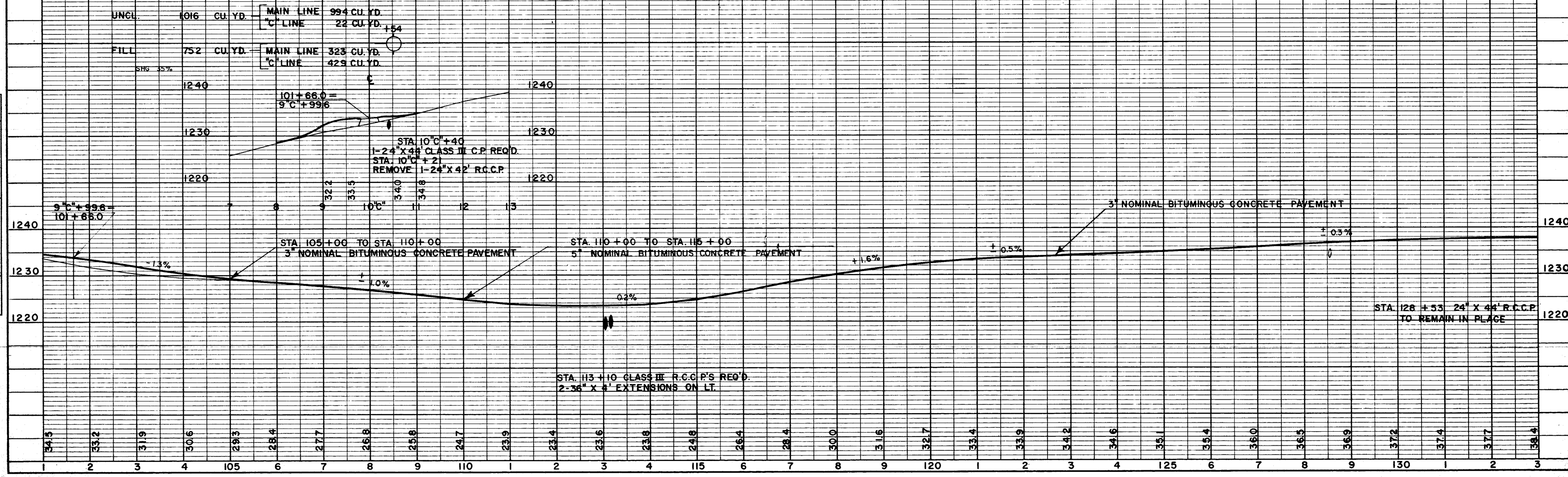

DATE	BY	REVISION
1-1-68	J.C.	1
1-1-68	J.C.	2
1-1-68	J.C.	3
1-1-68	J.C.	4
1-1-68	J.C.	5
1-1-68	J.C.	6
1-1-68	J.C.	7
1-1-68	J.C.	8
1-1-68	J.C.	9
1-1-68	J.C.	10

DATE	BY	REVISION
1-1-68	J.C.	1
1-1-68	J.C.	2
1-1-68	J.C.	3
1-1-68	J.C.	4
1-1-68	J.C.	5
1-1-68	J.C.	6
1-1-68	J.C.	7
1-1-68	J.C.	8
1-1-68	J.C.	9
1-1-68	J.C.	10

PLATE 1-PLAN-PROFILE S. P. R. R. E.
 MADE AND PRINTED IN U.S.A.
 CHARLES BREWING COMPANY, INC.

BENCH MARKS			
NO	STATION	DESCRIPTION	ELEV.
15	134+20	SPIKE IN POWER POLE	32' RT. 1239.79
16	140+89	SPIKE IN 14" BOX ELDER	50' RT. 1248.95
17	146+37	SPIKE IN TELEPHONE POLE	29' LT. 1258.74

D. P. R. DIVISION	PROJECT	SHEET NUMBER	TOTAL SHEETS
4	SO22(1)	9	

PLAN
 SURVEYED: []
 NOTE BOOK: []
 NO. 4788
 FT. OF WAY CHECKED: []

PROFILE
 SURVEYED: []
 NOTE BOOK: []
 NO. 4788
 STRUCTURE NOTATIONS CHECKED: []

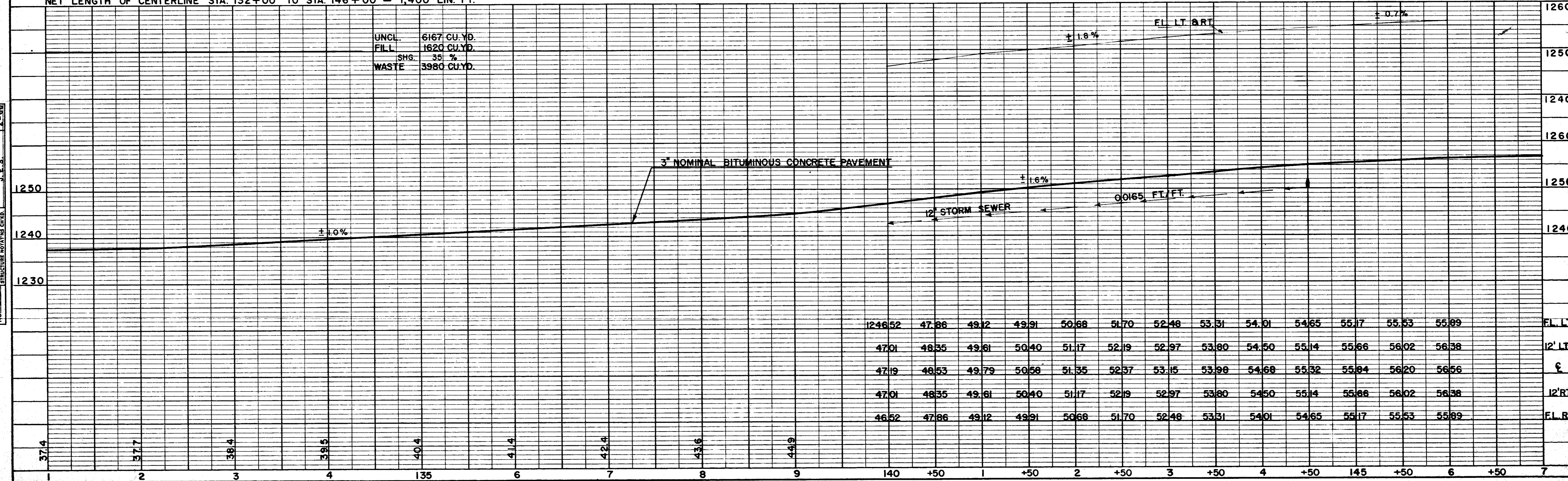
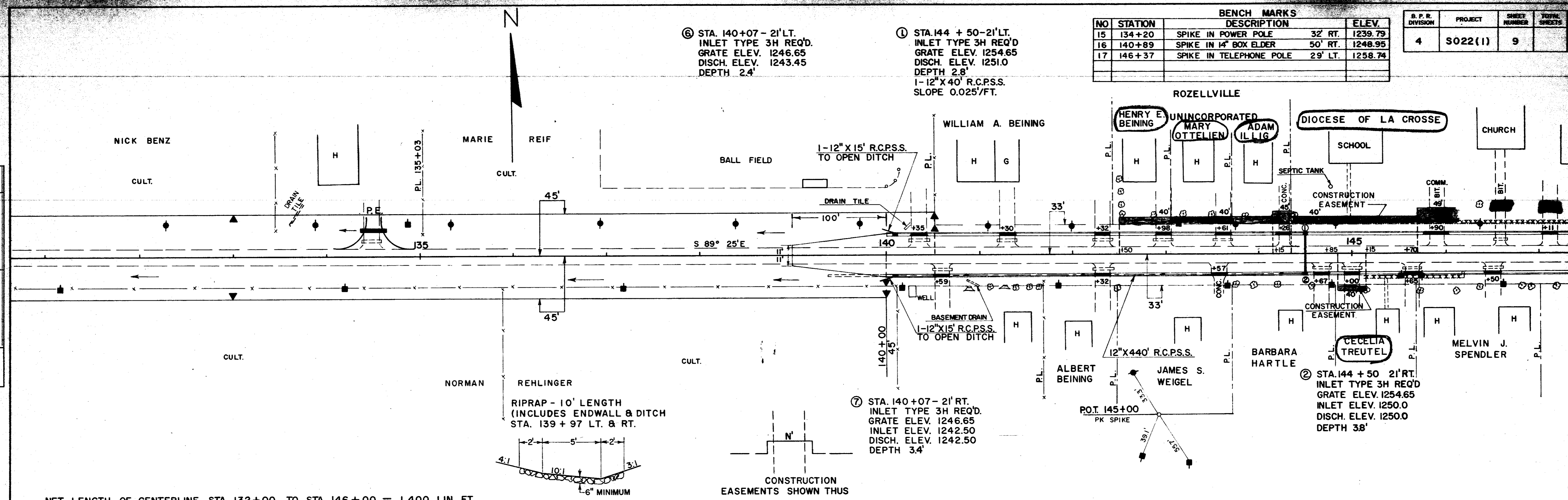

PLATE 1-PLAN - PROFILE O. P. R. & R. E.
 MADE AND PRINTED IN U.S.A.
 CHARLES BEISING COMPANY, INC.

NO	STATION	DESCRIPTION	ELEV.
1B	154+69	X ON GAS PUMP ISLAND	41' RT. 1257.34
	13'D+20	USGS STANDARD DISK	30' LT. 1260.09

S.P.R. DIVISION	PROJECT	SHEET NUMBER	TOTAL SHEETS
4	S022 (1)	10	

DATE	BY	REVISION
11/11/51	J.L.	DESIGNED
11/11/51	J.L.	NOTED
11/11/51	J.L.	APPROVED
11/11/51	J.L.	CONSTRUCTION
11/11/51	J.L.	AS-BUILT

DATE	BY	REVISION
11/11/51	J.L.	DESIGNED
11/11/51	J.L.	NOTED
11/11/51	J.L.	APPROVED
11/11/51	J.L.	CONSTRUCTION
11/11/51	J.L.	AS-BUILT

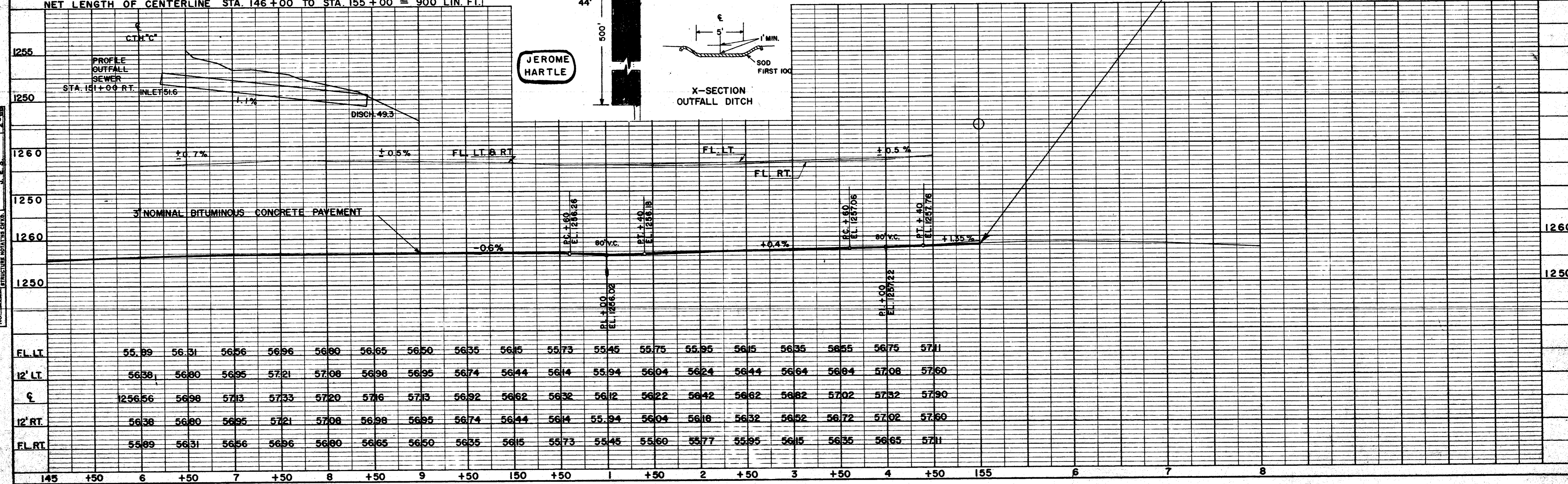
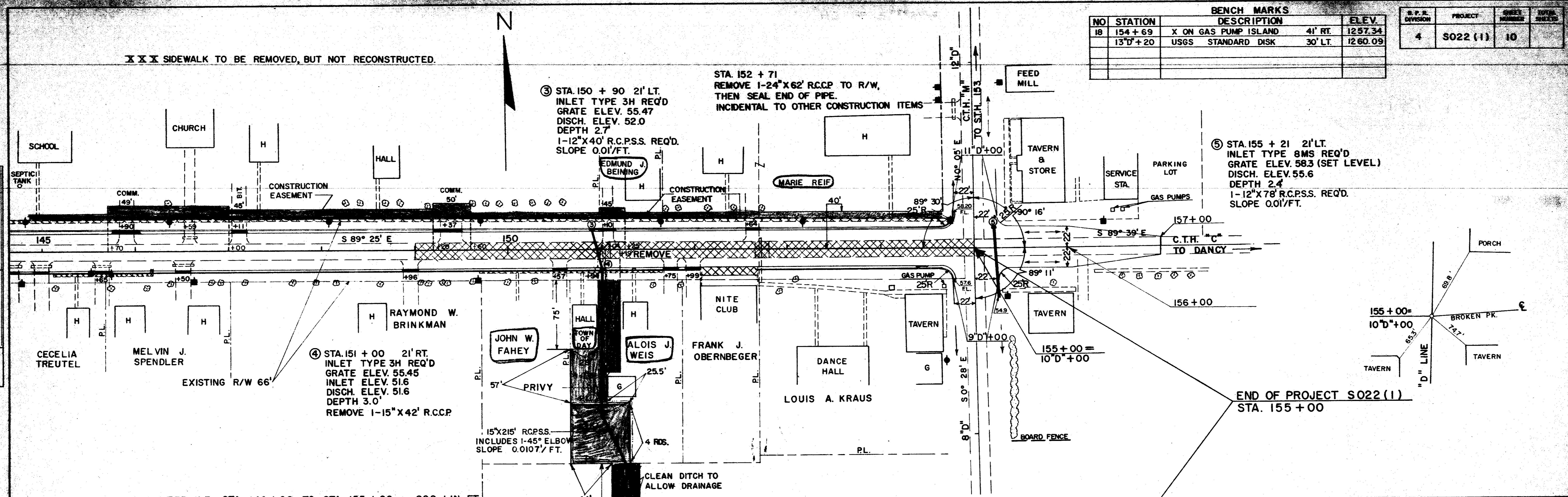

PLATE 1 - PLAN - PROFILE O.P.S.D.C.
 MADE AND PRINTED IN U.S.A.
 CRAWLEY-BROOKS COMPANY, INC.