

INDEX OF SHEETS

SHEET NO.	TITLE
SHEET NO. 1	TITLE
SHEET NO.	TYPICAL CROSS SECTIONS
SHEET NO.	ESTIMATE OF QUANTITIES
SHEET NO.	MISCELLANEOUS QUANTITIES
SHEET NO.	RIGHT OF WAY PLAT
SHEET NO.	PLAN AND PROFILE STA. TO STA.
SHEET NO.	STANDARD DETAILS
SHEET NO.	DRAINAGE STRUCTURES
SHEET NO.	CROSS SECTIONS



STATE OF WISCONSIN
STATE HIGHWAY COMMISSION OF WISCONSIN

PLAN AND PROFILE OF PROPOSED
BROKAW BRIDGE AND APPROACHES

C.T.H. WW
MARATHON COUNTY

PROJECT S014(6)

PLAN 1 IN. = 100 FT.
PROFILE HOR. 1 IN. = 100 FT. VERT. 1 IN. = 10 FT.
CROSS SECTIONS HOR. 1 IN. = 10 FT. VERT. 1 IN. = 10 FT.

COUNTY AND HIGHWAY	ROUTE AND SECTION	CLASS AND AGREEMENT		B.P.R. REGION DIVISION	SHEET NUMBER	TOTAL SHEETS
		STATE	FEDERAL			
37.6	14.0		13.6	4 WIS.		

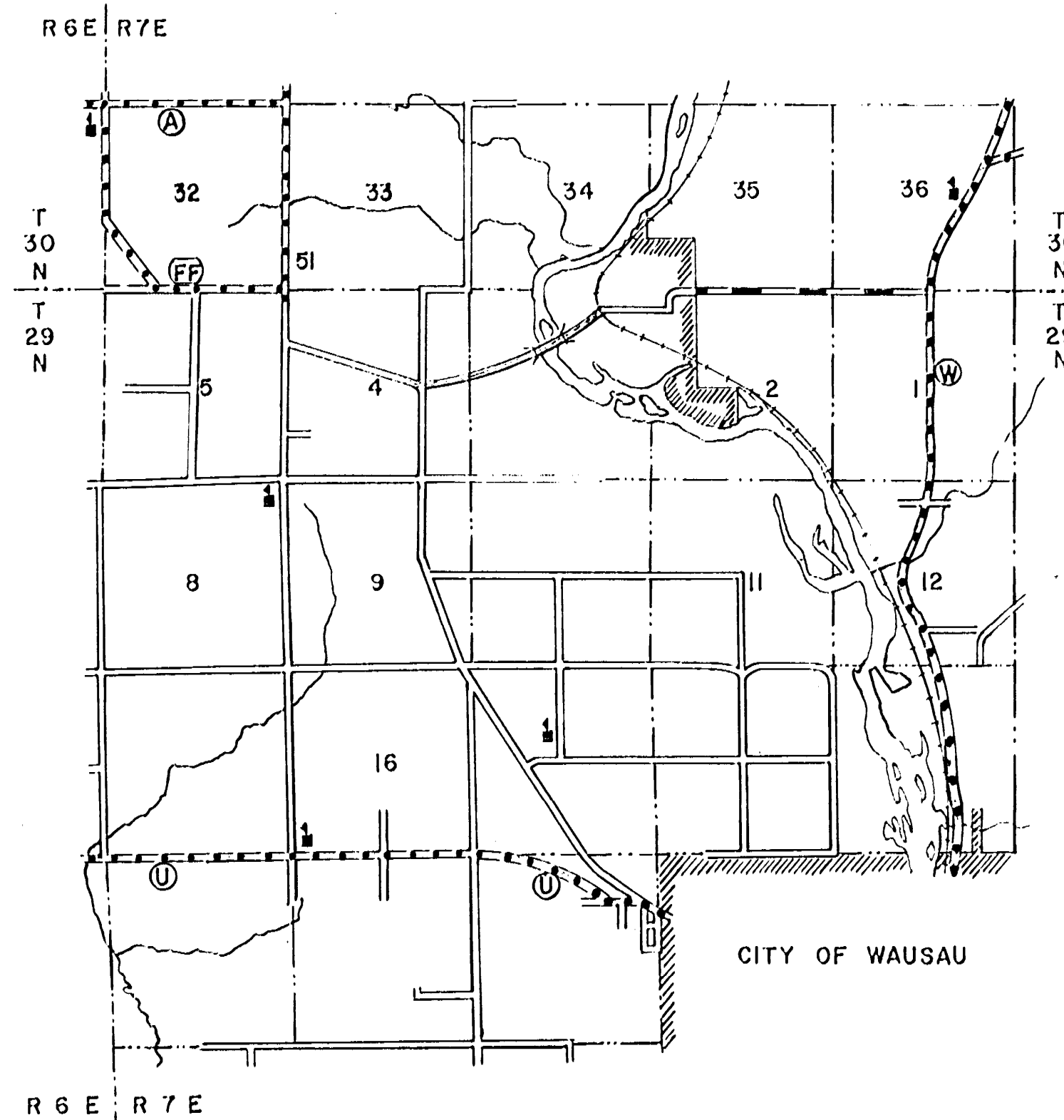

LAYOUT

SCALE 1" = ONE MILE

TOTAL NET LENGTH OF CENTERLINE = MI.

CONVENTIONAL SIGNS

STATE LINE	-----	CULVERTS IN PLACE	-----
COUNTY LINE	-----	CULVERTS REQUIRED	-----
TOWNSHIP OR RANGE LINE	-----	DROP INLET	-----
SECTION LINE	-----	POWER POLE	-----
NEW RIGHT OF WAY LINE	-----	TELEPHONE OR TELEGRAPH POLE	-----
PRESENT RIGHT OF WAY LINE	-----	RIGHT OF WAY MARKERS	-----
WIRE FENCE WOVEN	-----	REFERENCE STAKE FOR HUBS ONLY	-----
WIRE FENCE BARBED	-----	MARSH	-----
LOT LINE	-----	HEDGE	-----
CORPORATE OR CITY LIMITS	-----	TREES	-----
PROPERTY LINE	-----	GROUND ELEVATION	DATUM LINE 73.9
TRAVELED WAY OR P.E.	-----	GRADE ELEVATION	DATUM LINE 75.6
RAILROADS	-----		
BASE OR SURVEY LINE	-----		

PRELIMINARY COPY

MAY 4 1966

STATE HIGHWAY COMMISSION OF WISCONSIN MADISON, WIS.	
SURVEYOR L. J. W.	NOTE BOOK 4767
DIVISION COMPUTER R. J. S.	M. O. CHECKER
DISTRICT CHECKER	CORRECT
CORRECT:	
DATE	DISTRICT ENGINEER
RECOMMENDED FOR APPROVAL:	
DATE	CHIEF DESIGN ENGINEER
APPROVED:	
DATE	STATE HIGHWAY ENGINEER
DEPARTMENT OF COMMERCE BUREAU OF PUBLIC ROADS	
APPROVED:	
DATE	
DIVISION ENGINEER	

NO	STATION	BENCH MARKS	DESCRIPTION	ELEV
8	27°D+75	N.BOLT ON HYD.		20 RT. 1219.47

S.P.R. DIVISION	PROJECT	SHEET NUMBER	TOTAL SHEETS
4	SO14 (6)	9	

NOTE: SEE SHEET NO. 7 FOR TIES

DATE	BY	REVISION
10-25-56	N.L.D.	3-56

PLANNING SURVEYED, PLOTTED, ALIGNED, CHECKED, REVISIONS, BY, DATE

DATE	BY	REVISION
10-25-56	N.L.D.	3-56

PROFILE SURVEYED, PLOTTED, ALIGNED, CHECKED, REVISIONS, BY, DATE

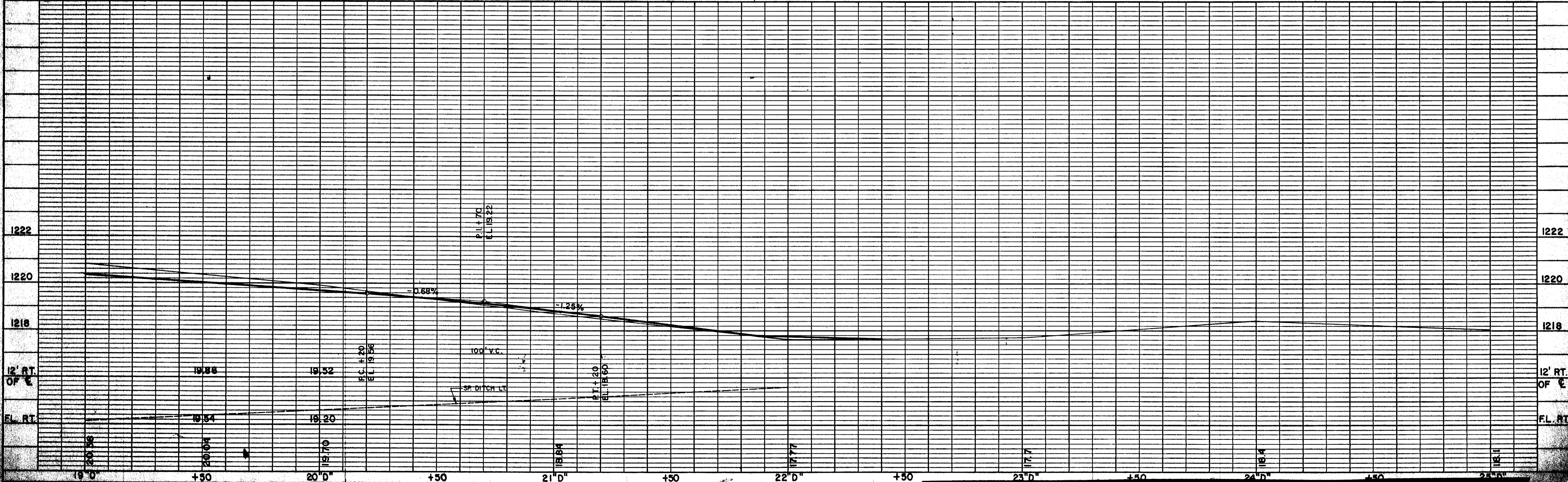
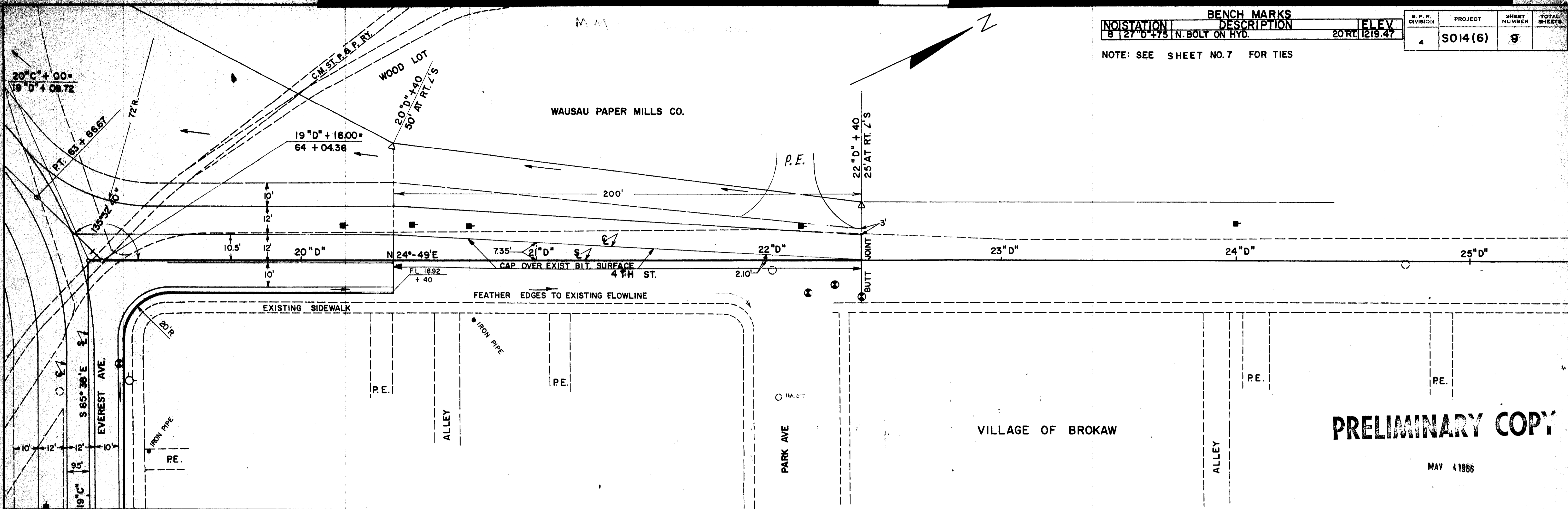

PRELIMINARY COPY

MAY 4 1956

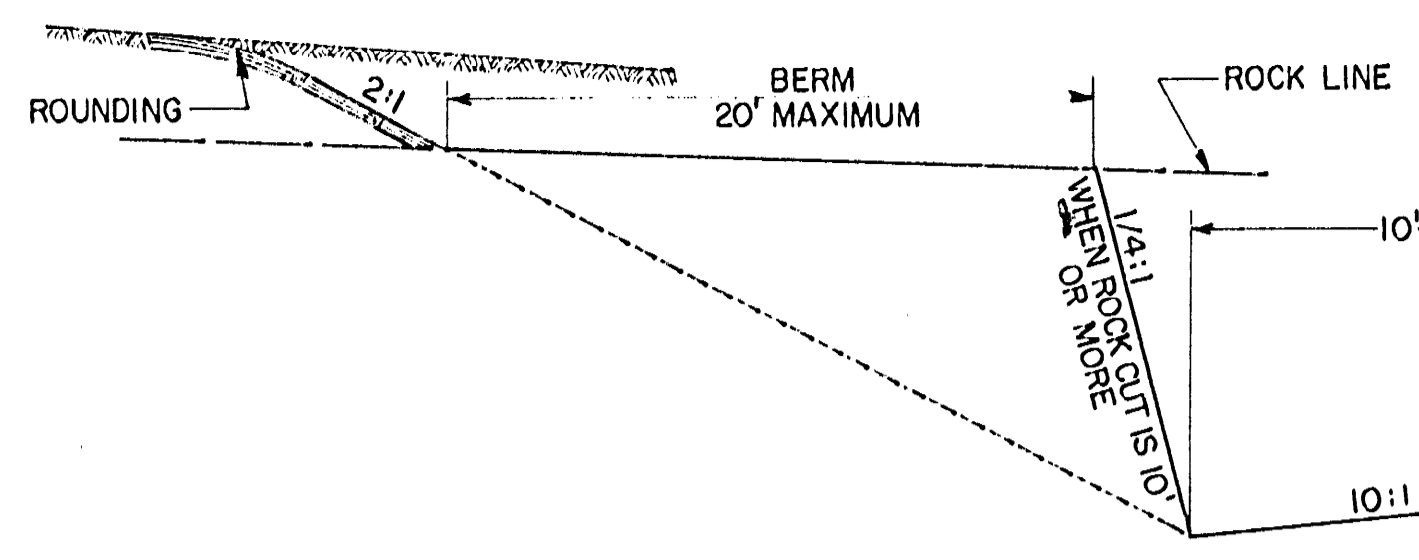

TYPICAL ROCK CUT TREATMENT

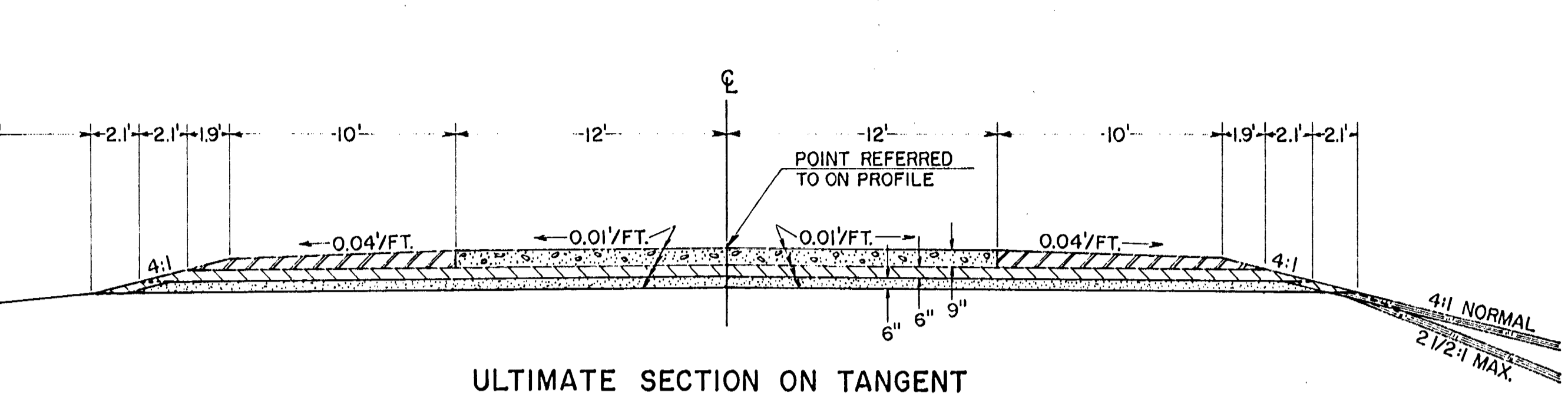

ULTIMATE SECTION ON TANGENT

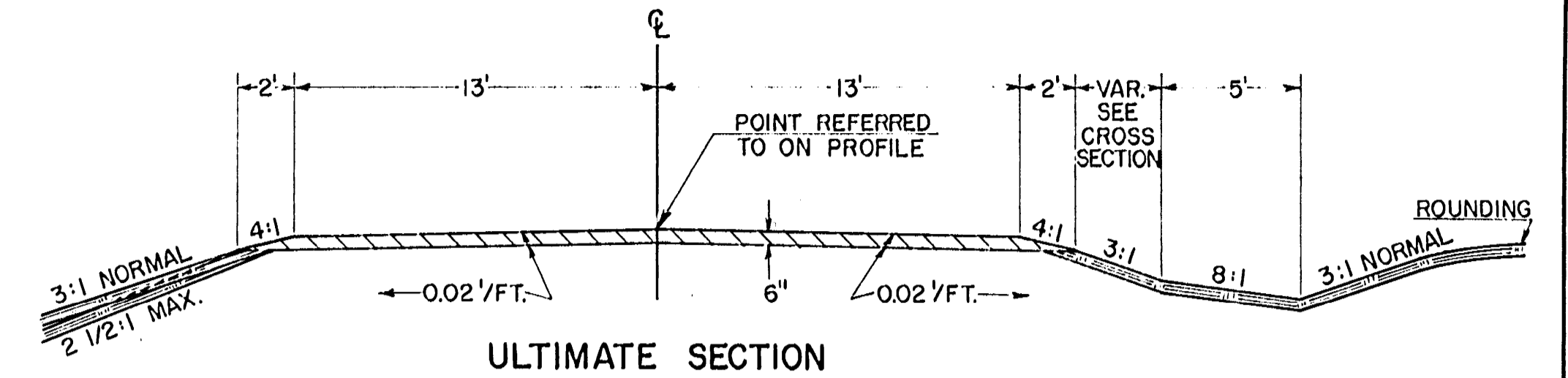

ULTIMATE SECTION

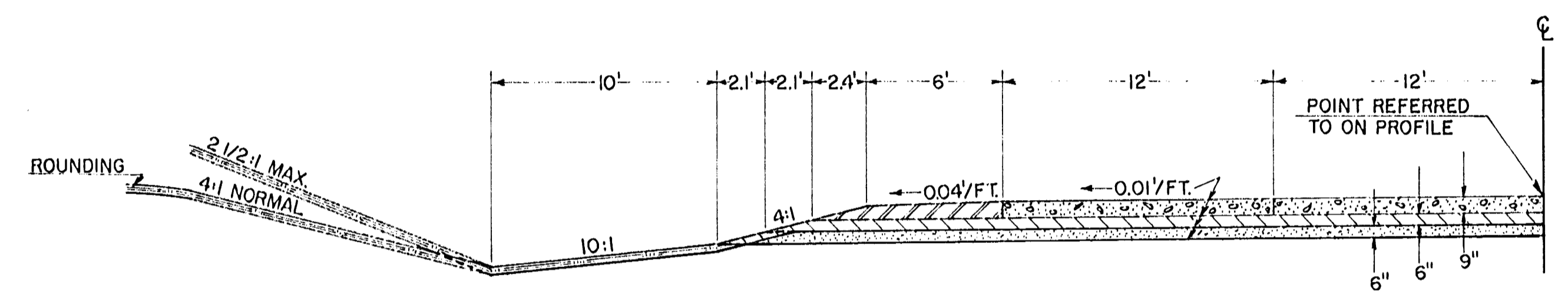

ULTIMATE HALF SECTION WITH CLIMBING LANE ON LEFT

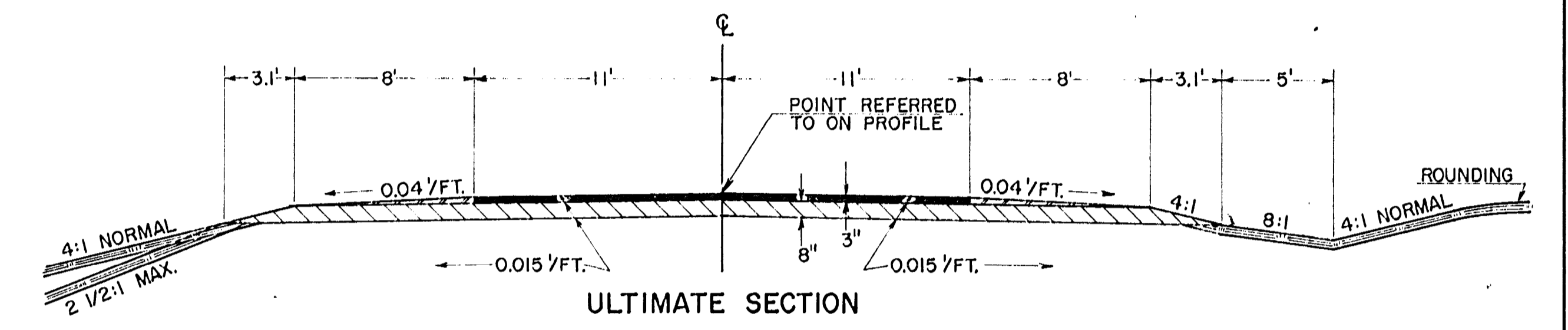

ULTIMATE SECTION

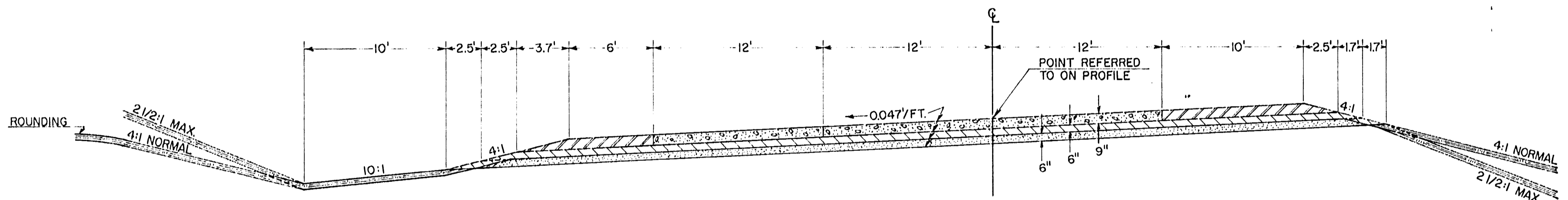

ULTIMATE SUPERELEVATED SECTION WITH CLIMBING LANE ON LEFT

- LEGEND**
- P.C. CONCRETE PAVEMENT
 - GRAVEL OR CRUSHED STONE BASE COURSE
 - GRAVEL OR CRUSHED STONE BASE COURSE (SHOULDER MATERIAL)
 - GRANULAR SUBBASE COURSE
 - BITUMINOUS CONCRETE PAVEMENT
 - 3" SALVAGE TOPSOIL (SEED & FERTILIZE)

PRELIMINARY COPY

MAY 4, 1968

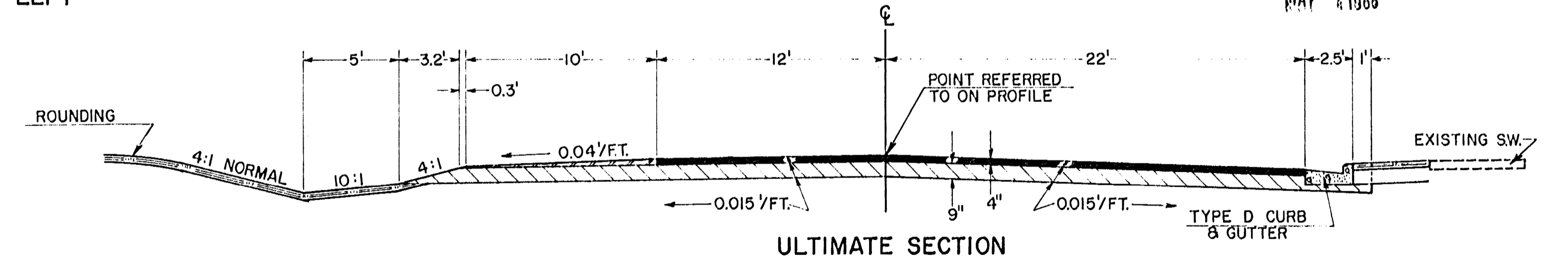

ULTIMATE SECTION

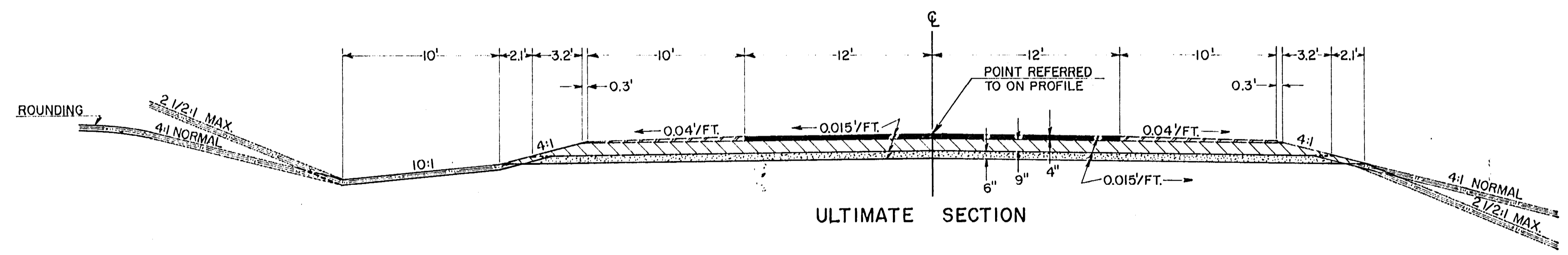

ULTIMATE SECTION

TYPICAL CROSS SECTIONS FOR C.T.H. "WW" AND SIDEROADS

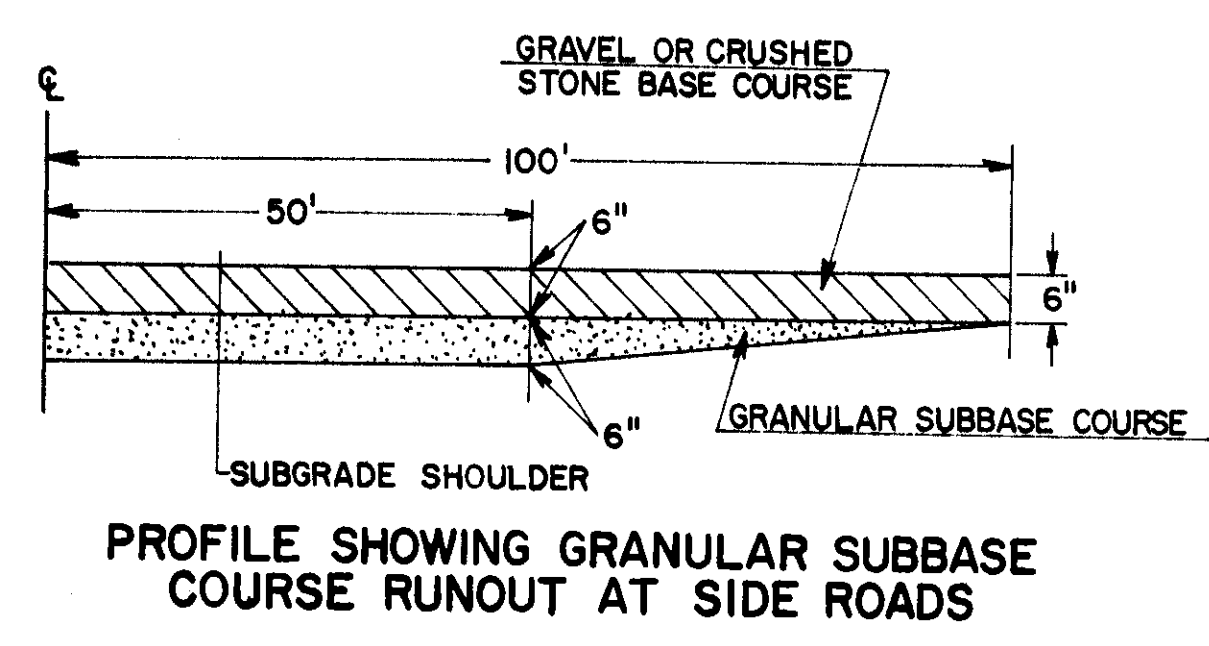
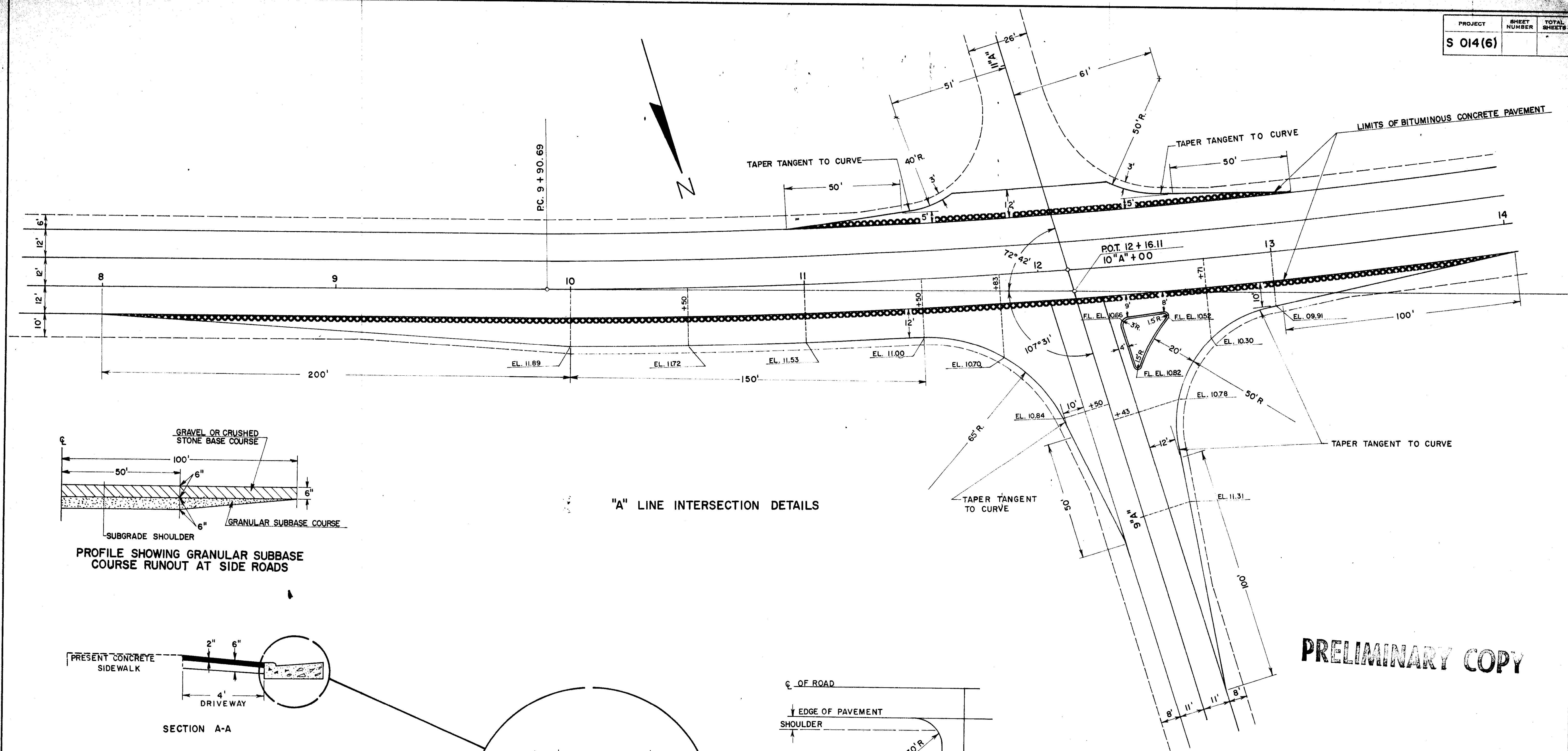

"A" LINE INTERSECTION DETAILS

PRELIMINARY COPY

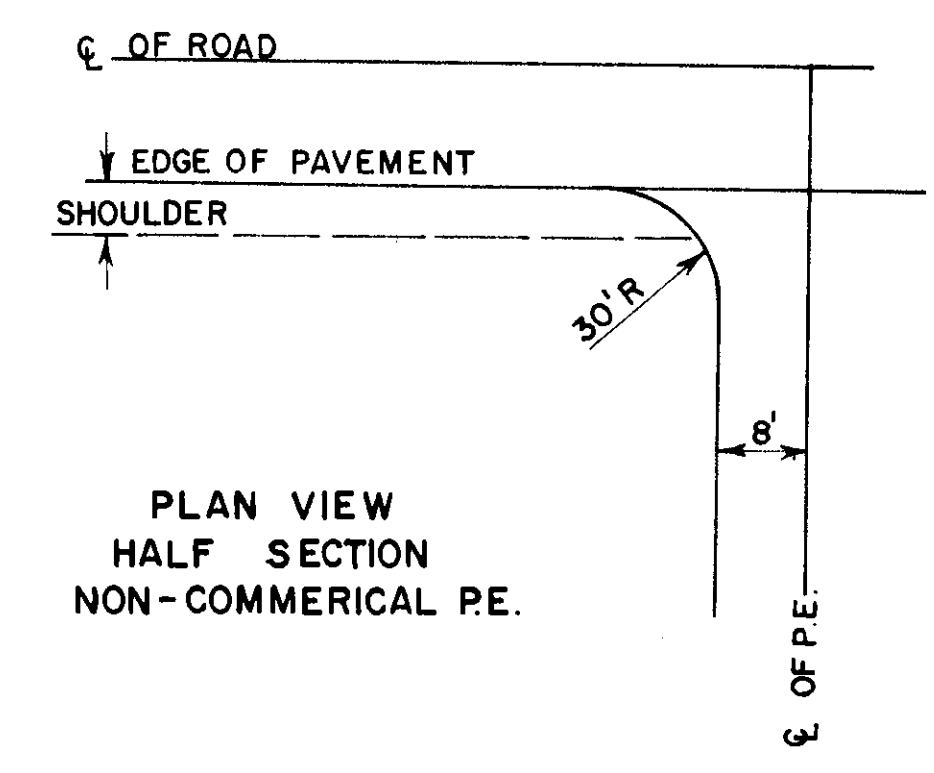
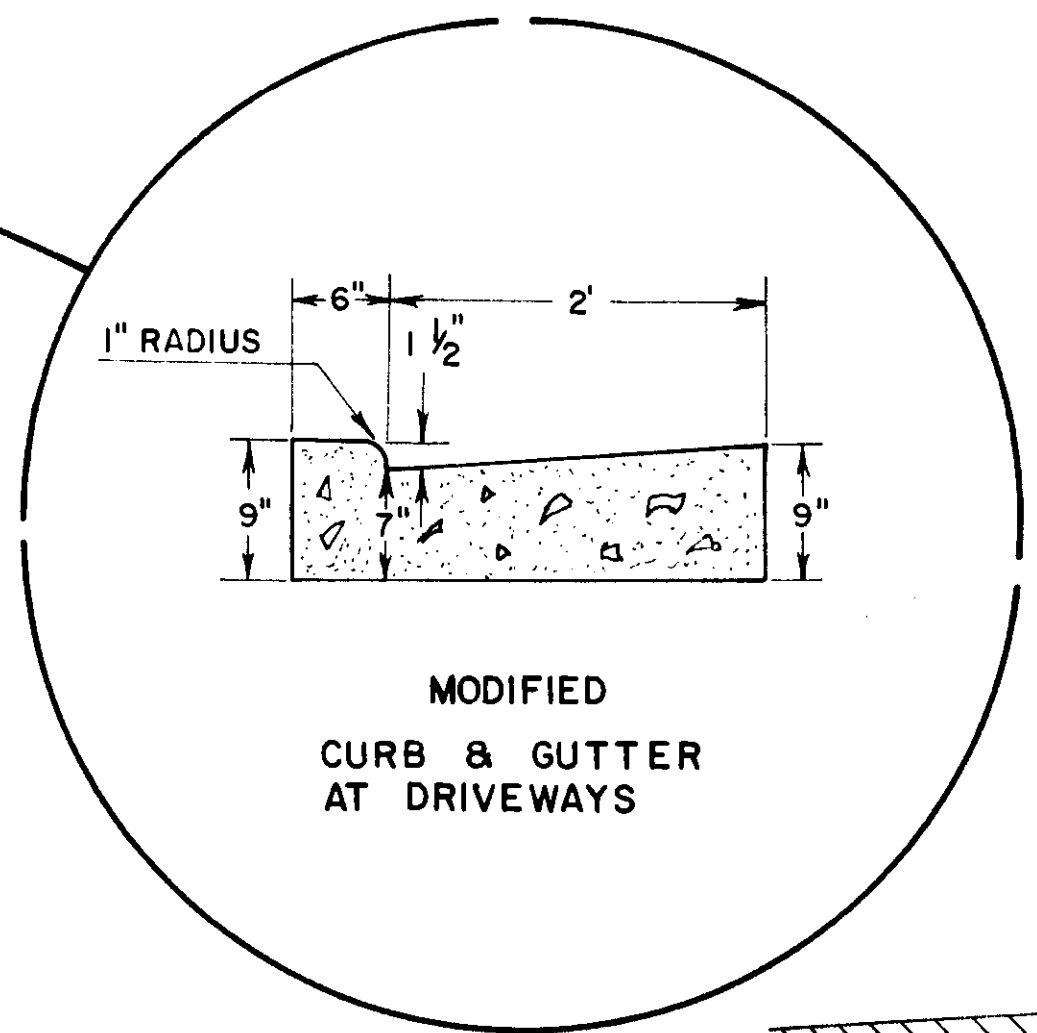
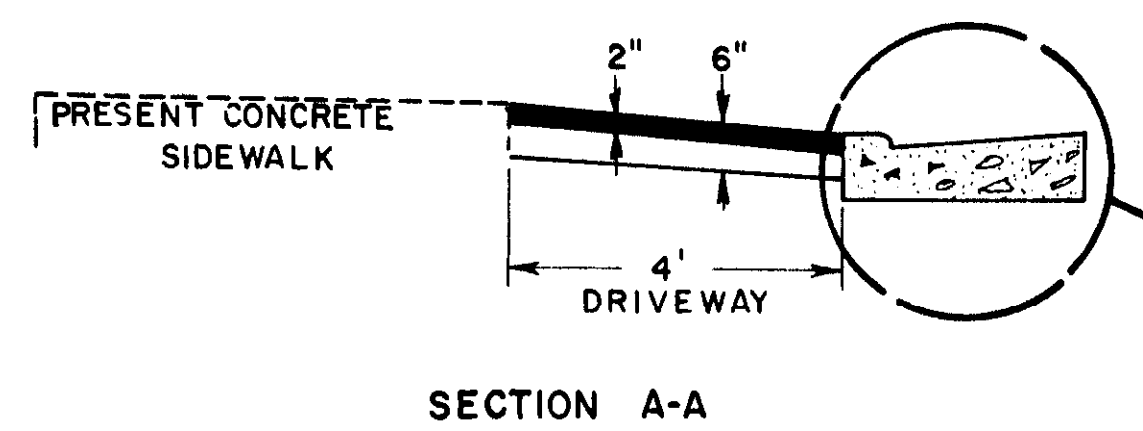

PRIVATE ENTRANCE DETAILS (WITHOUT CURB AND GUTTER)

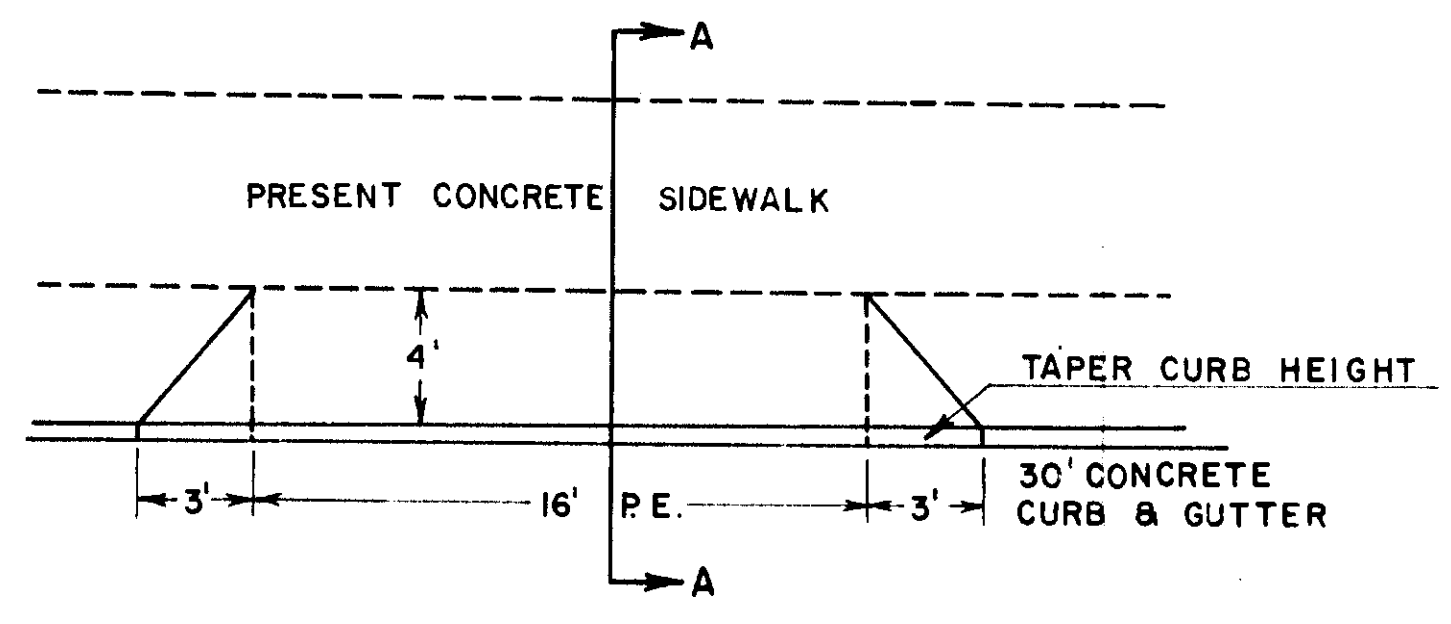

PRIVATE ENTRANCE DETAILS (WITH CURB AND GUTTER)

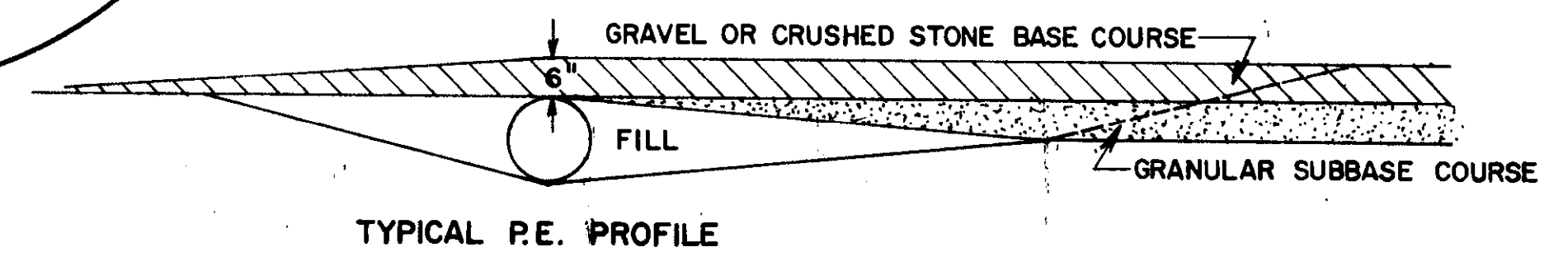

TYPICAL P.E. PROFILE

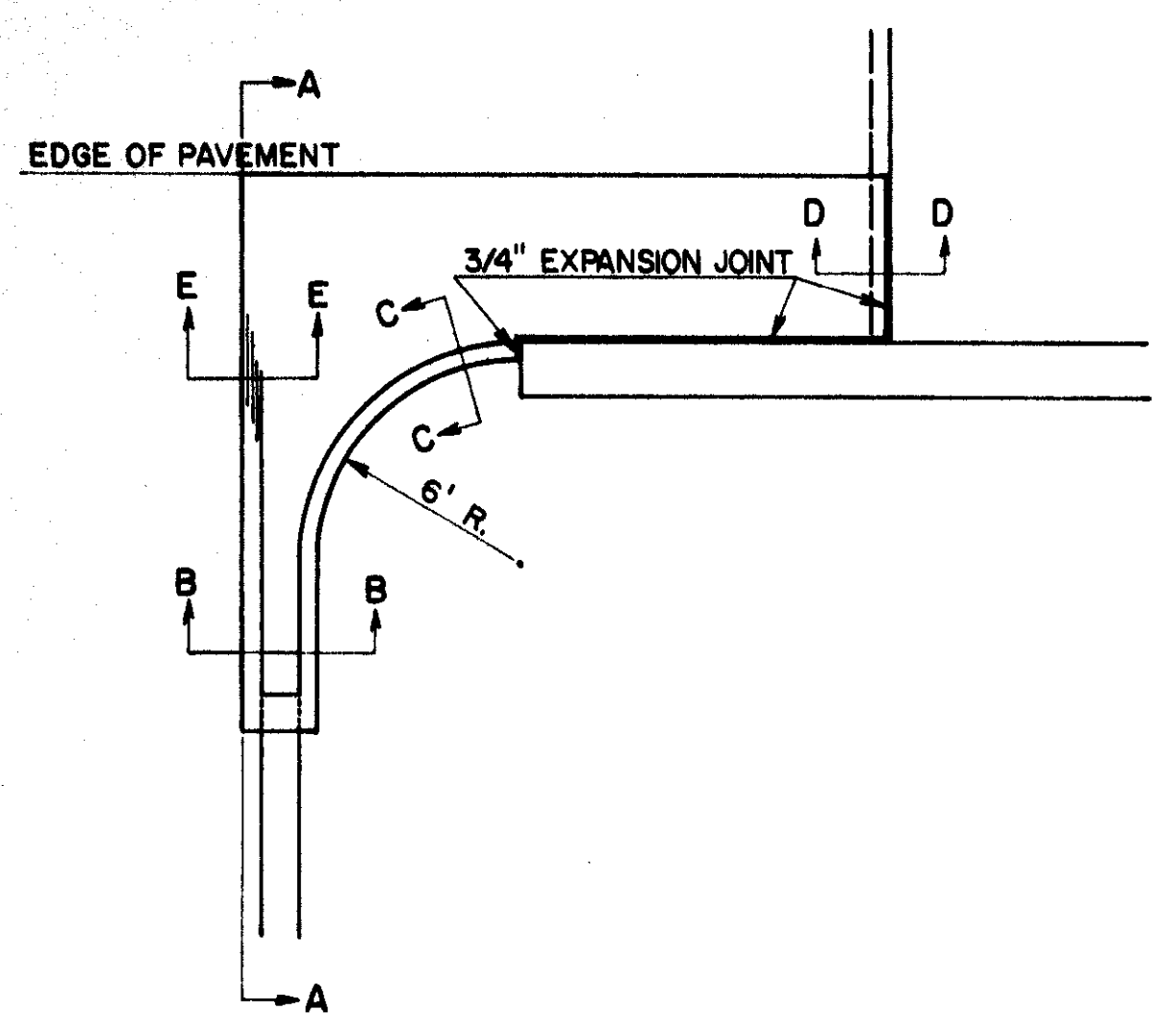

PLAN VIEW

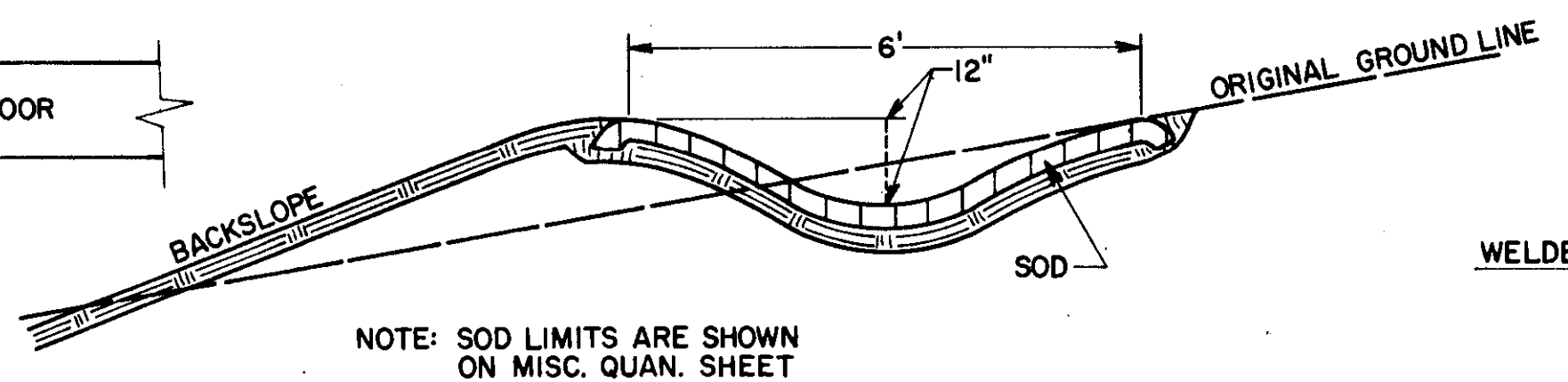
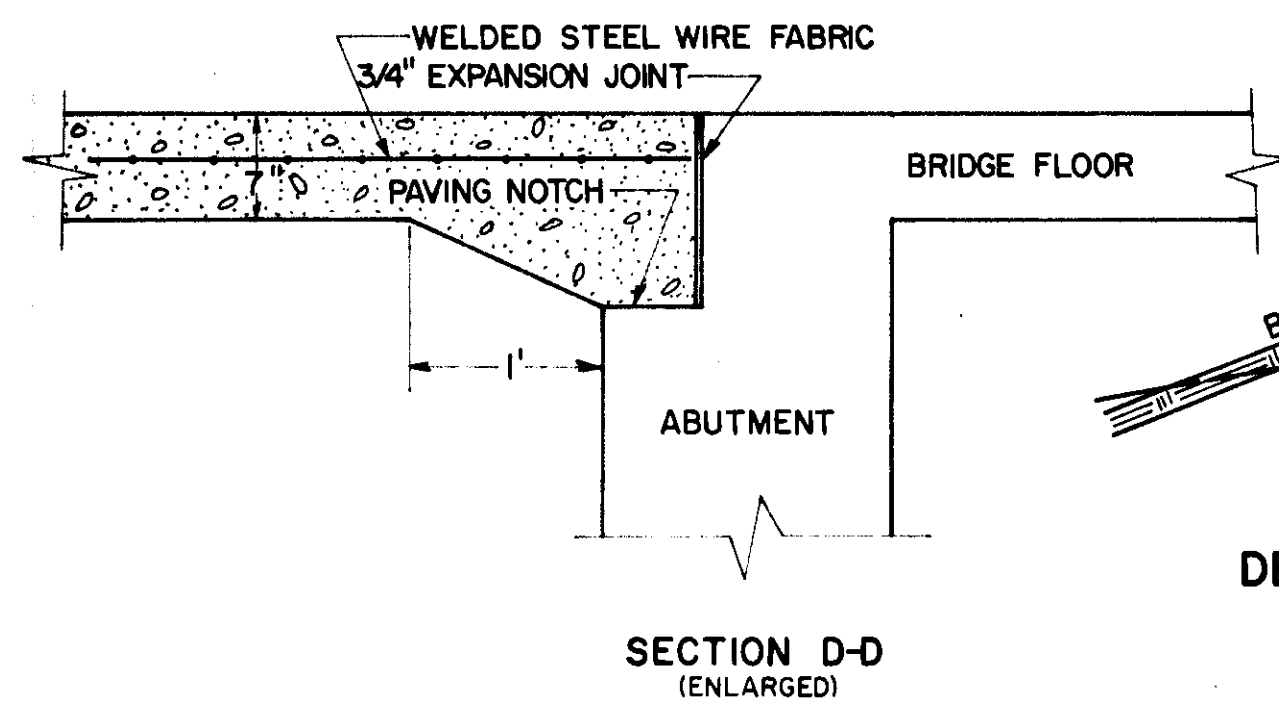

DETAIL OF SOD DITCH ON INTERCEPTING EMBANKMENT

NOTE: SOD LIMITS ARE SHOWN ON MISC. QUAN. SHEET

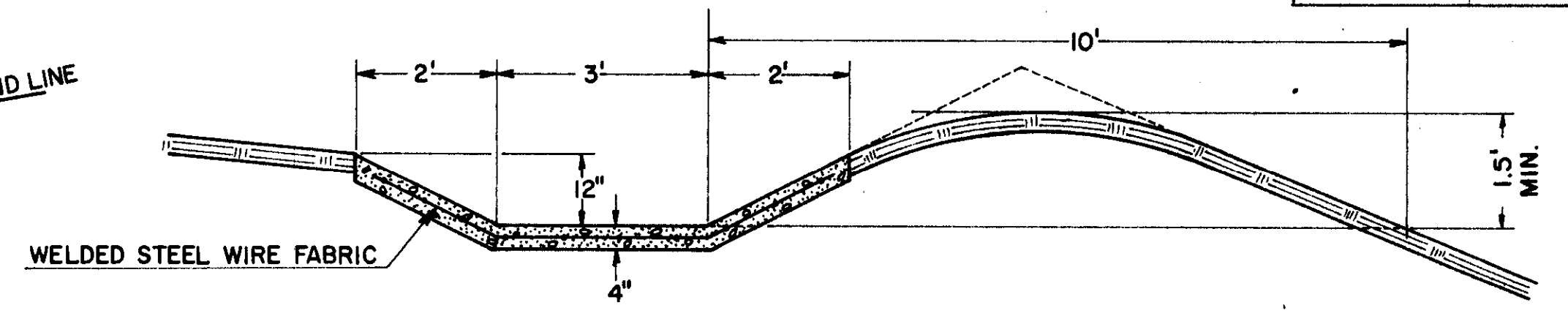

DETAIL OF PAVED DITCH ON INTERCEPTING EMBANKMENT

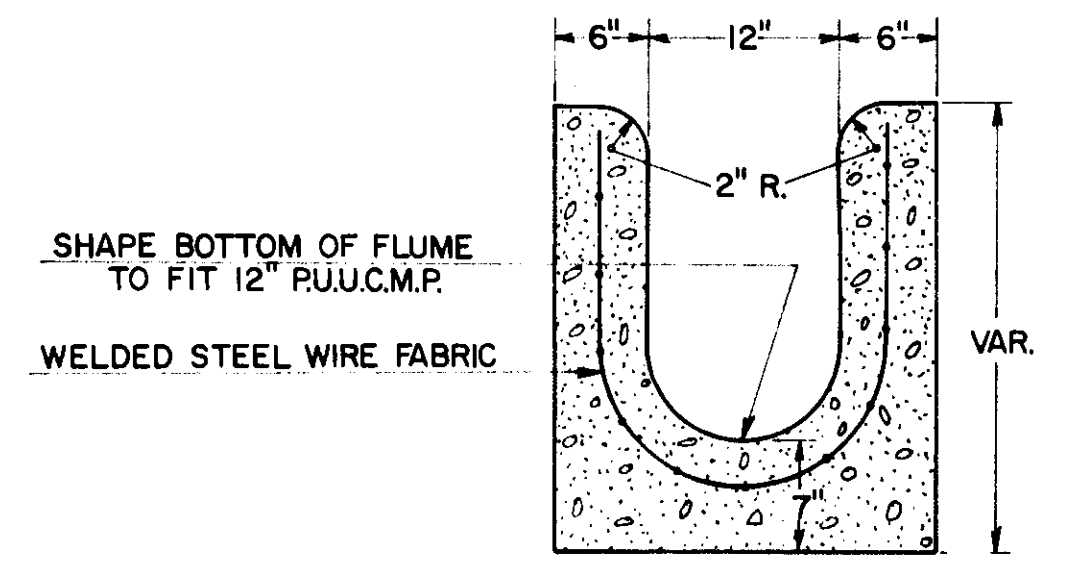

SECTION B-B (ENLARGED)

CONCRETE SURFACE DRAIN NOTES:

Details of construction not shown shall conform to the pertinent requirements of the Standard Specifications Subsection 409.7.4. (in paragraphs 3 & 4 of said Subsection, when reference is made to the edge of pavement it shall be construed to mean the edge of the surface drain), and applicable Special Provisions.

CONCRETE

Concrete shall be Grade "AA" in accord with the Standard Specifications, Section 501.4.

REINFORCEMENT

#4 2'-0" Deformed tie bars shall be used, spaced 3'-0" C.C. Welded Steel Wire Fabric shall be 4 gage 6" mesh or equivalent. It shall be imbedded 2" clear with a minimum overlap sheet to sheet of 6".

Welded Steel Wire Fabric shall conform to the requirements of the "Standard Specifications For Welded Steel Wire Fabric For Concrete Reinforcement", A. A. S. H. O. Designation M 55.

MEASUREMENT AND PAYMENT

Measurement and payment of items shown hereon shall be made in accord with the Standard Specifications, Subsections 409.8.3 & 409.9.3.

The Discharge Pipe IS A SEPARATE BID ITEM.

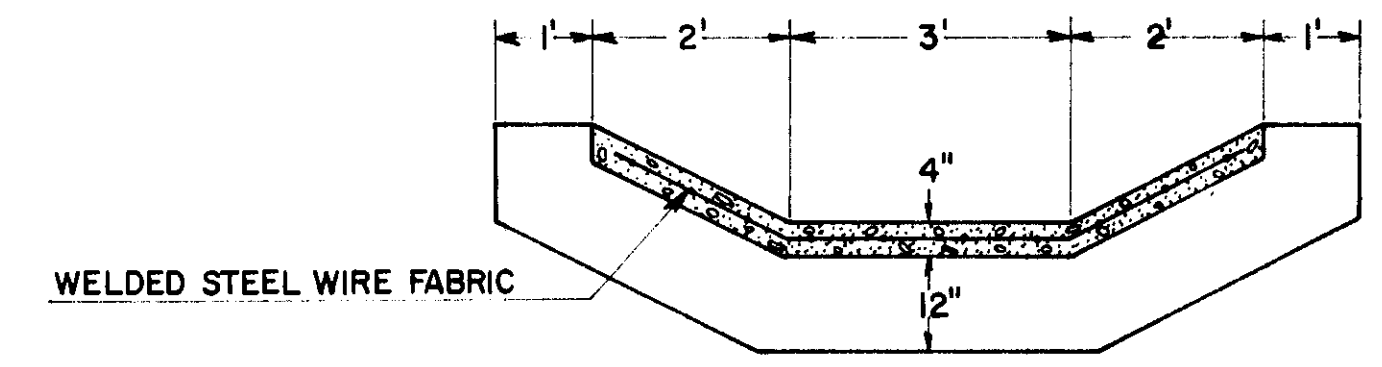

SECTION A-A

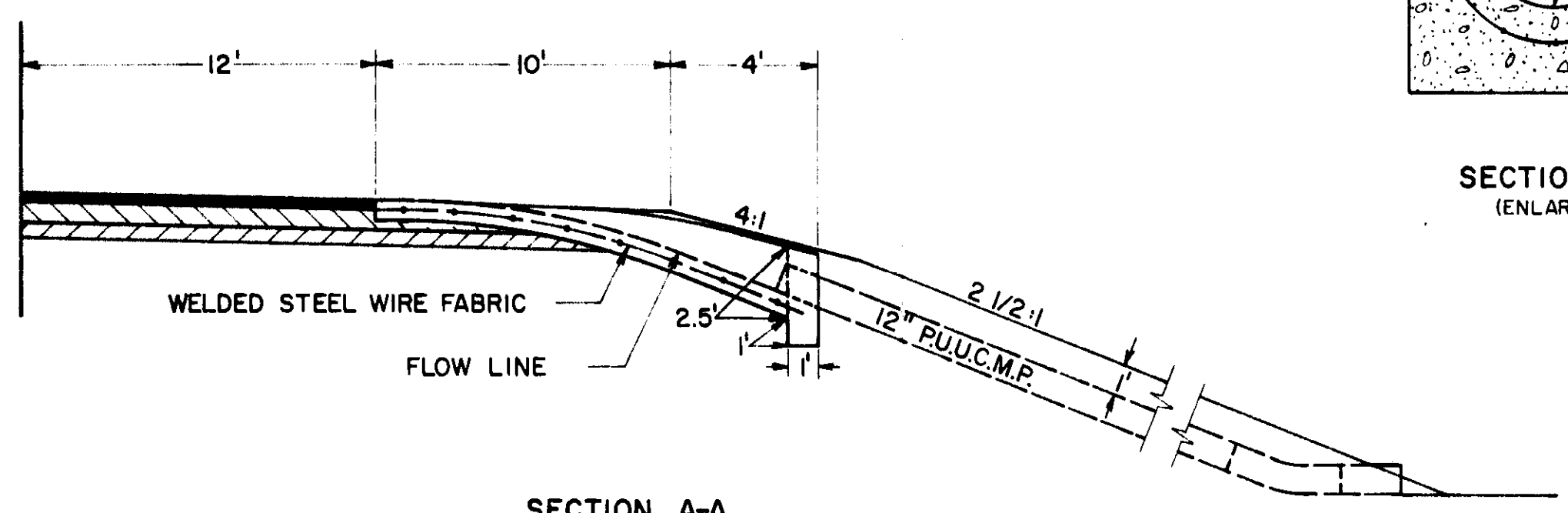

SECTION A-A

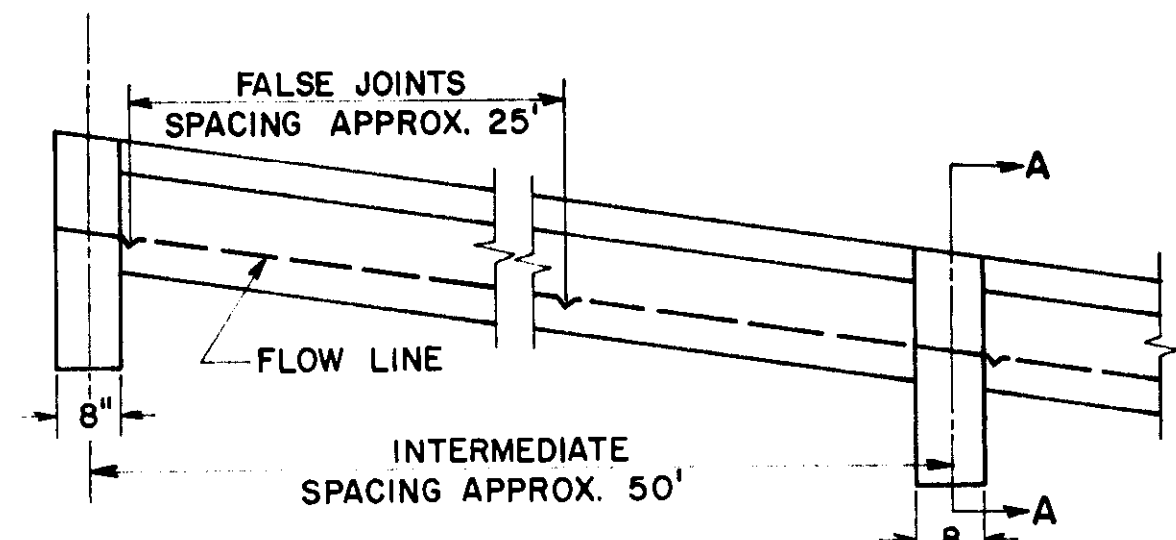

DETAILS OF PAVED DITCH CUTOFF WALLS

PRELIMINARY COPY

MAY 4 1966

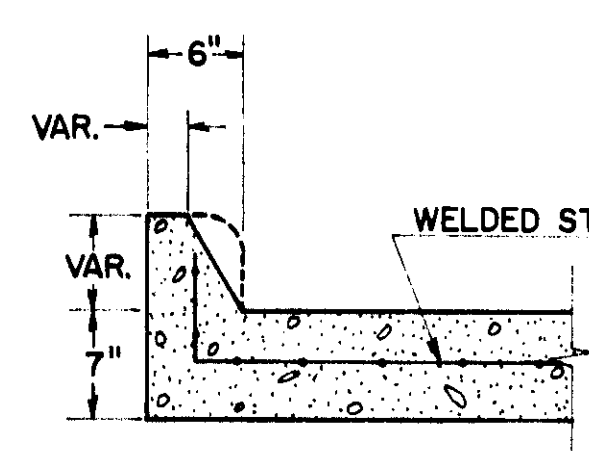

SECTION E-E (ENLARGED)

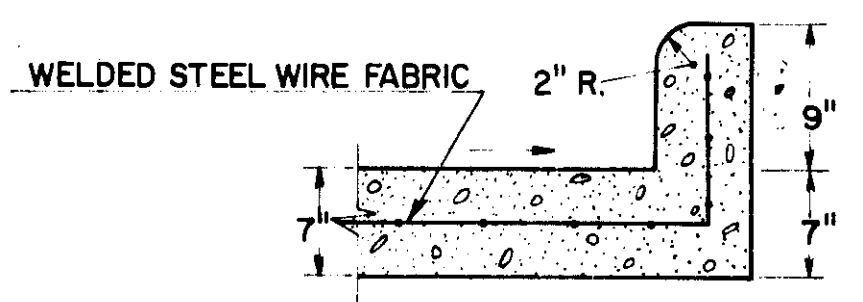

SECTION C-C (ENLARGED)

DETAILS OF CONCRETE SURFACE DRAIN

GENERAL NOTES FOR SLOPE PAVING (4" CONCRETE PAVED DITCH)

Details of construction not shown shall conform to the pertinent requirements of the Standard Specifications and the applicable Special Provisions.

CONCRETE

Concrete for paved ditch and cutoff wall shall be Grade "AA" in accordance with the the Standard Specifications, Section 501.

WELDED STEEL WIRE FABRIC

Welded Steel Wire Fabric shall be 4 gage 6" mesh or equivalent. It shall be imbedded 2" clear with minimum overlap sheet to sheet of 6".

Welded Steel Wire Fabric shall conform to the requirements of the Standard Specifications for Welded Steel Wire Fabric for concrete reinforcement, A. S. S. H. O. Designation M 55.

MEASUREMENT AND PAYMENT

Measurement and payment of items shown hereon shall be made in accordance with the Standard Specifications Section 604.4 and 604.5 respectively and shall include the furnishing and placement of the Welded Steel Wire Fabric.

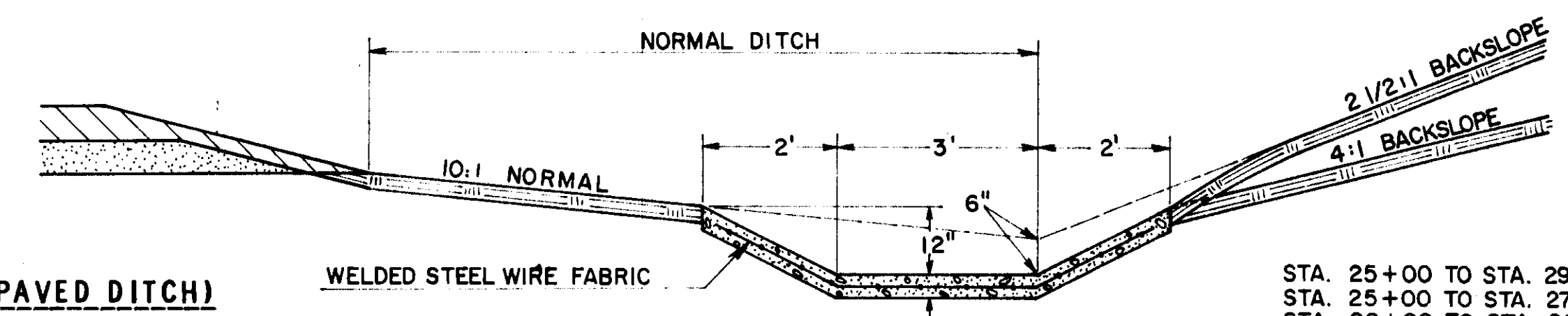

DETAIL FOR NORMAL PAVED DITCH

STA. 25+00 TO STA. 29+50 LT.
STA. 25+00 TO STA. 27+00 RT.
STA. 29+00 TO STA. 29+50 RT.

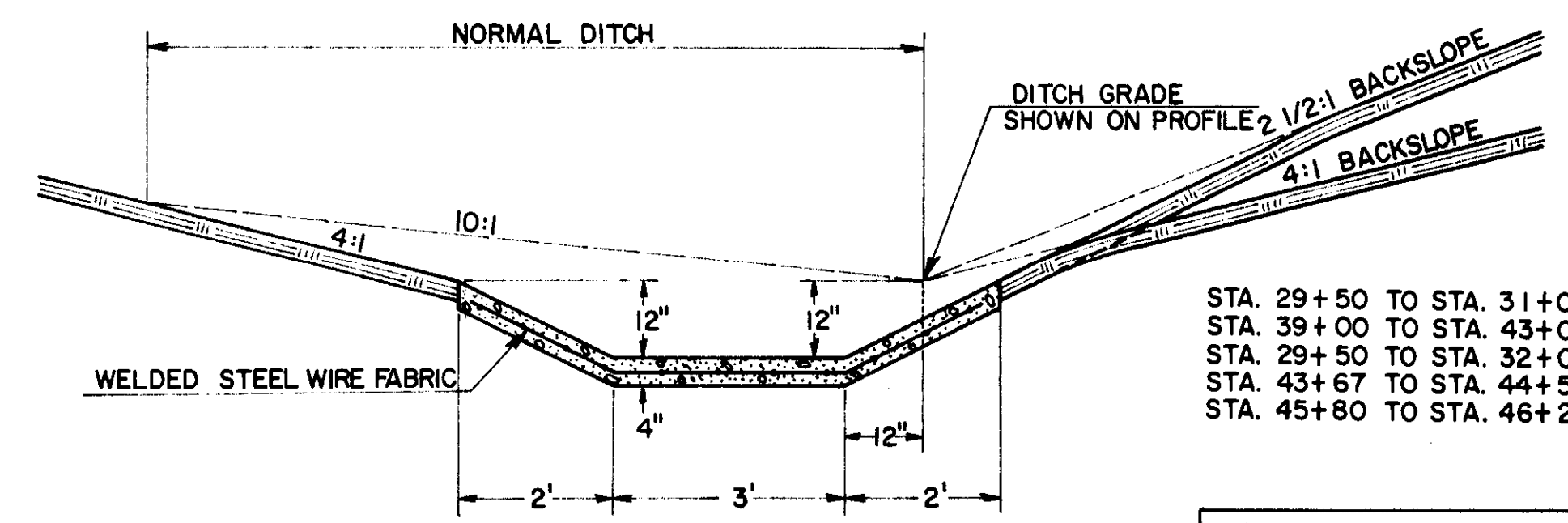

DETAIL FOR PAVED SPECIAL DITCH

STA. 29+50 TO STA. 31+00 LT.
STA. 39+00 TO STA. 43+08 LT.
STA. 29+50 TO STA. 32+00 RT.
STA. 43+67 TO STA. 44+50 RT.
STA. 45+80 TO STA. 46+26 RT.

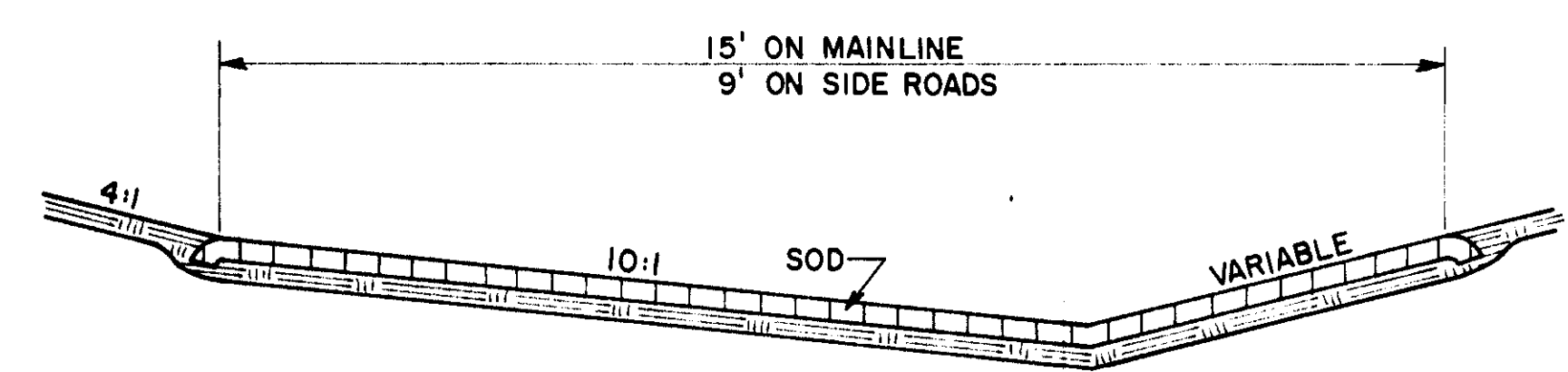

DETAIL OF SOD DITCH

LEGEND

3" TOPSOIL OR SALVAGED TOPSOIL

MISCELLANEOUS DRAINAGE DETAILS

PROJECT	SHEET NUMBER	TOTAL SHEETS
	2.4	

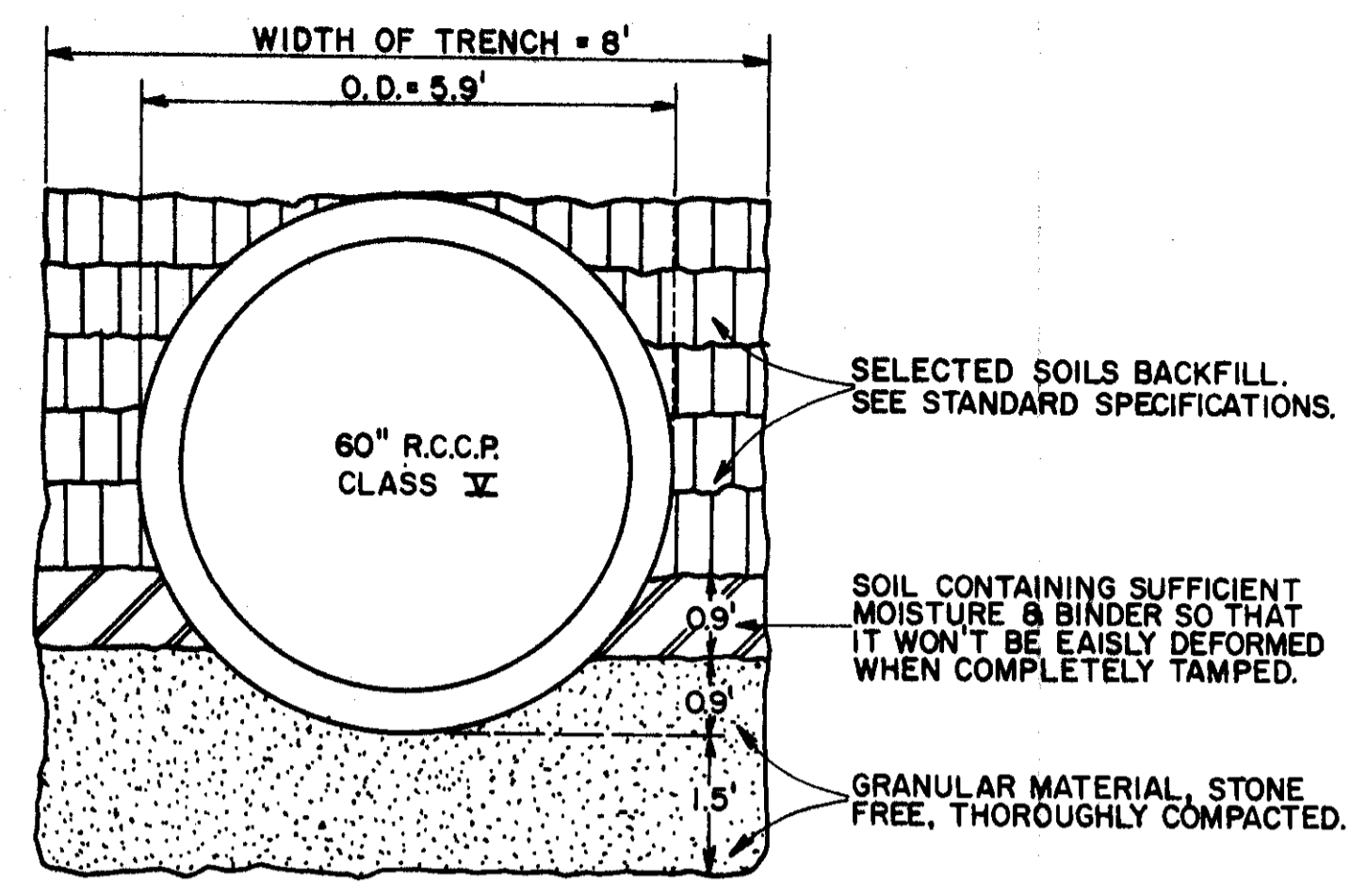

CLASS B BEDDING DETAIL FOR R.C.C.P. CLASS V AT STA. 42+87

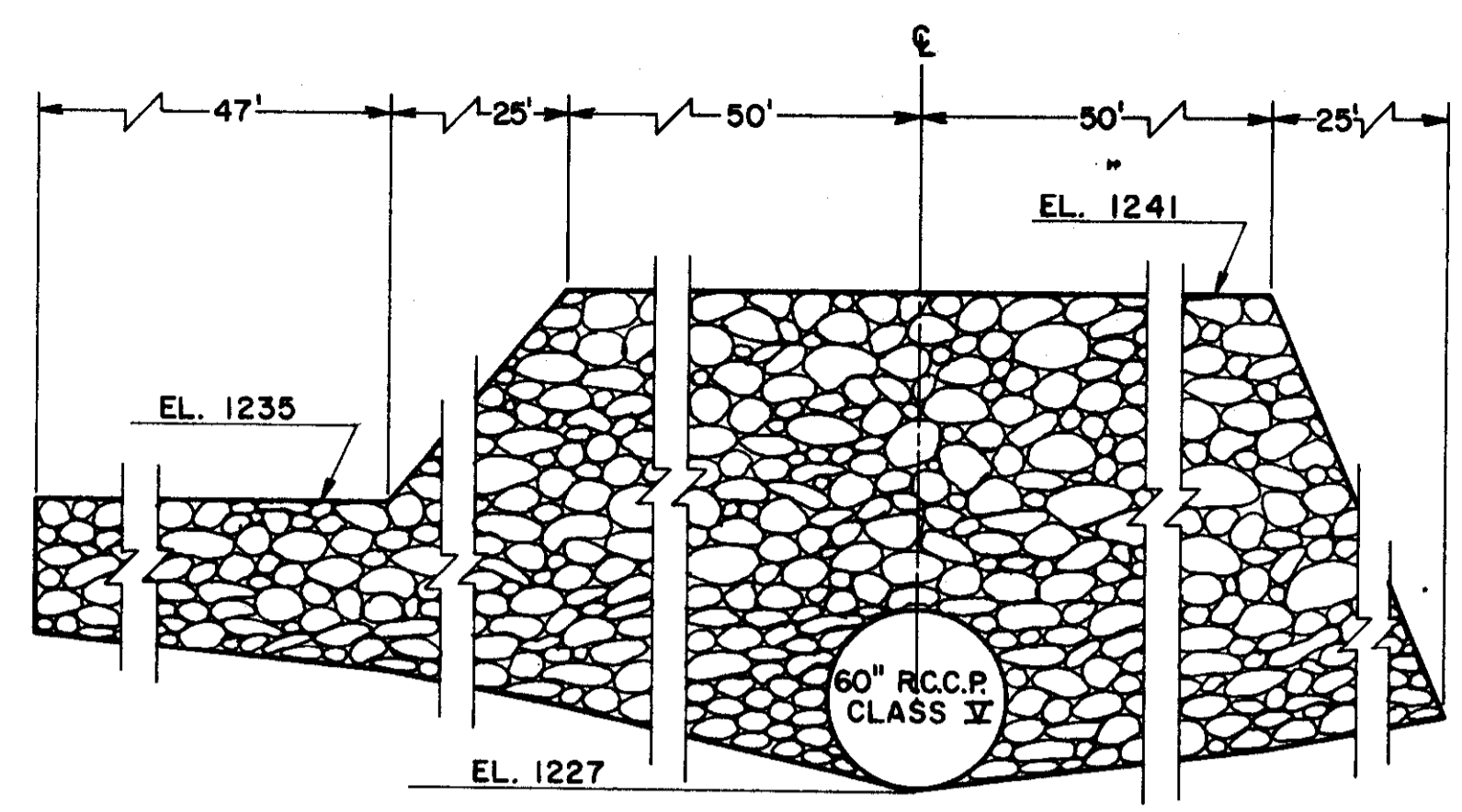

DETAIL OF RIPRAP SLOPE PROTECTION FOR INLET END OF 60" R.C.C.P. CLASS V AT STA. 42±58

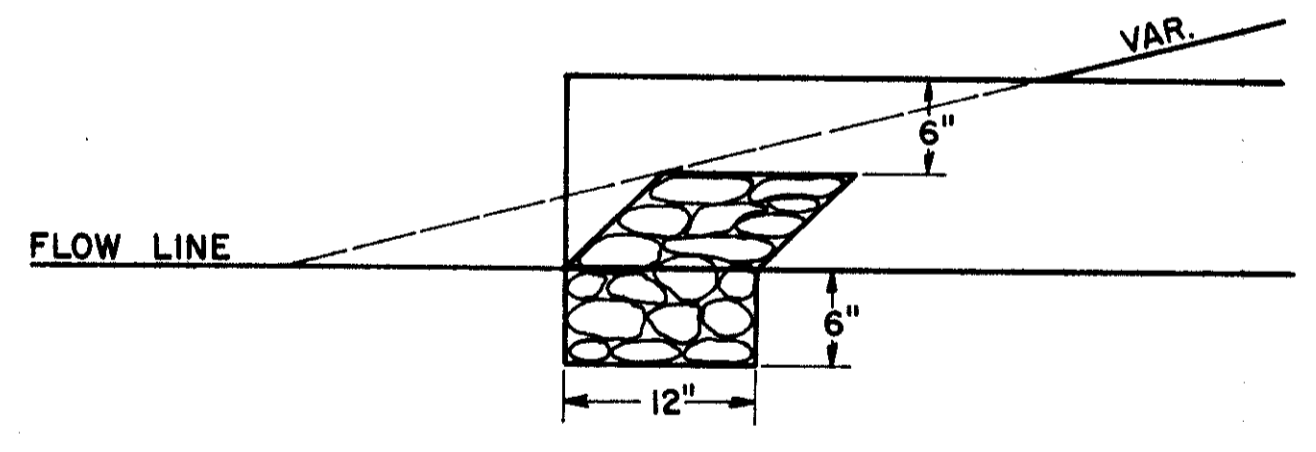

SIDE VIEW

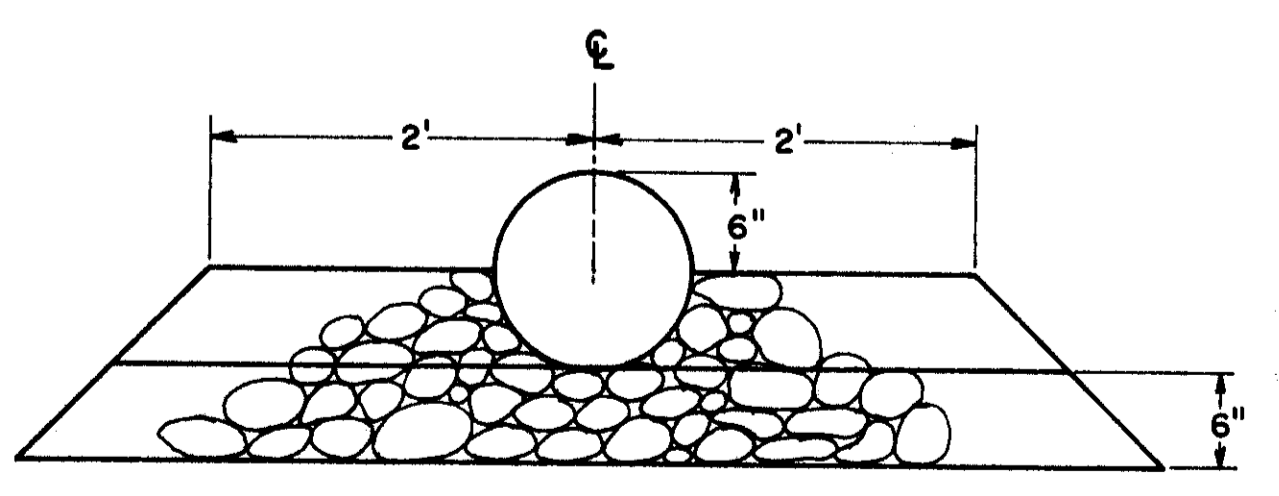

END VIEW

DETAIL OF MORTAR RUBBLE MASONRY ENDWALL FOR 12" PIPE

PRELIMINARY COPY

MAY 4 1988

DATE	10-85
BY	L.J.W.
PLANNED	N.L.D.
NOTED	NO. 5757
NO. 5757	

DATE	10-85
BY	L.J.W.
PLANNED	N.L.D.
NOTED	NO. 5757
NO. 5757	

BENCH MARKS			
NO.	STATION	DESCRIPTION	ELEV.
1	0+01	SPK. IN POWER POLE	24' RT. 1403.15
1A	9+50	SPK. IN POWER POLE	50' LT. 1402.15
2	12+A+70	SPK. IN POWER POLE	30' LT. 1391.24
3	20+00	SPK. IN TEL. POLE	600' LT. 1377.07
3A	29+00	SPK. IN 24" MAPLE	300' LT. 1345.39

B. P. R. DIVISION	PROJECT	SHEET NUMBER	TOTAL SHEETS
4	SO14(6)	5	

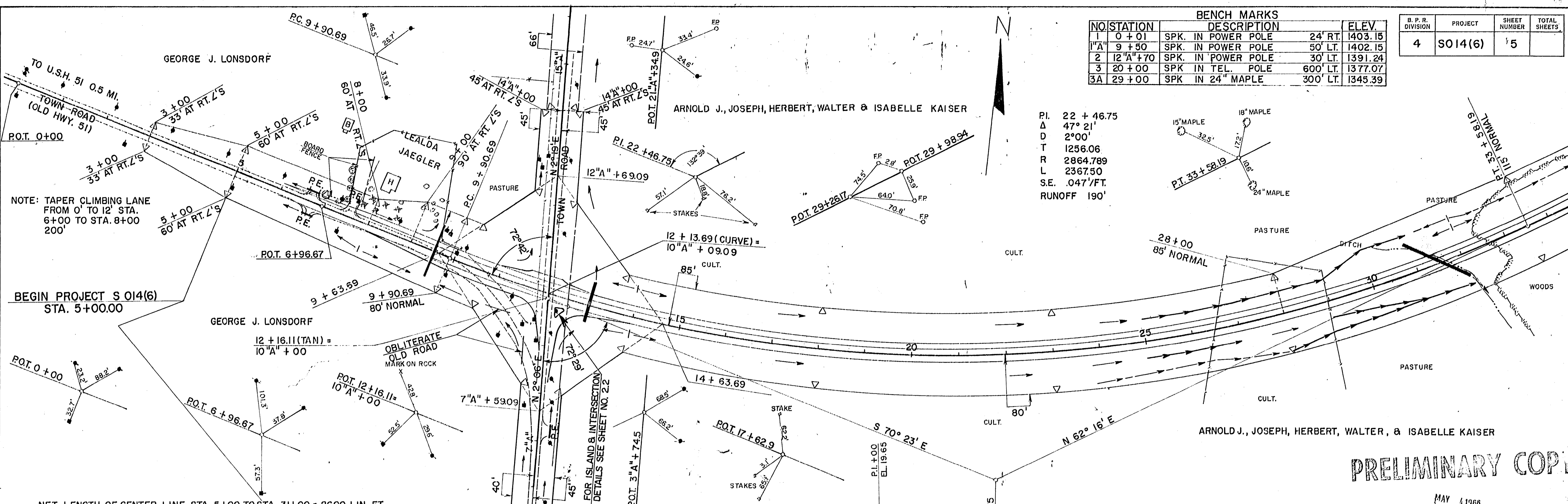

P.I. 22 + 46.75
 Δ 47° 21'
 D 2° 00'
 T 1256.06
 R 2864.789
 L 2367.50
 S.E. .047'/FT.
 RUNOFF 190'

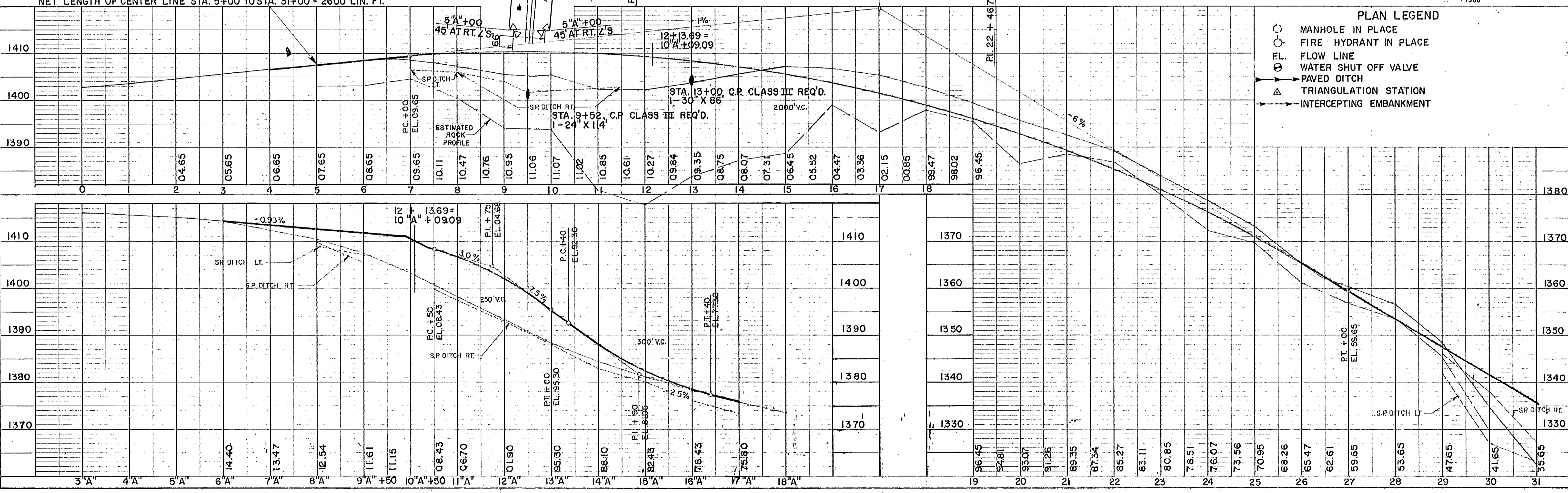
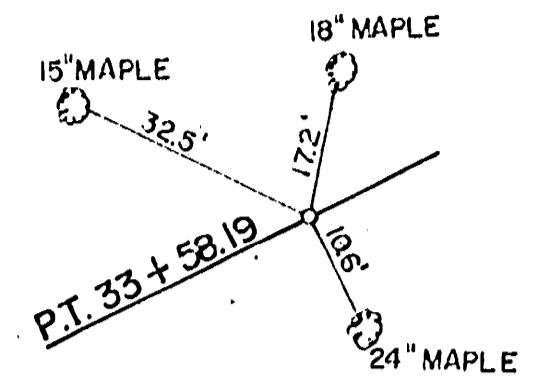

- PLAN LEGEND**
- MANHOLE IN PLACE
 - FIRE HYDRANT IN PLACE
 - FL. FLOW LINE
 - ⊗ WATER SHUT OFF VALVE
 - PAVED DITCH
 - △ TRIANGULATION STATION
 - INTERCEPTING EMBANKMENT

PRELIMINARY COPY

MAY 1966

PLAN
 SURVEYED BY L.J.W. N.L.D.
 DATE 10-55
 3-56
 NOTE BOOK PLOTTED
 ALIGNMENT CHECKED
 NO. 4767

PROFILE
 SURVEYED BY L.J.W. E.C.B.
 DATE 10-55
 3-56
 NOTE BOOK GRADES CHECKED
 B.M.S. NOTED
 NO. L.L. STRUCTURE NOTATION CHD.

NO	STATION	BENCH MARK DESCRIPTION	ELEV.
4	41 + 60	SPK. IN 20" ELM	150' RT. 1231.67
5	49 + 75	SPK. IN 8" MAPLE	100' LT. 1197.26
6	54 + 40	SPK. IN 6" MAPLE	25' LT. 1195.36
109	55 + 30	BRASS CAP IN CONC.	175' LT. 1196.78

B. P. R. DIVISION	PROJECT	SHEET NUMBER	TOTAL SHEETS
4	S014(6)	6	

PI. 59 + 66.29
 Δ 6° 40' 50"
 D 0° 50'
 T 401.29
 R 6875.49
 L 801.67
 S.E. NORMAL CROWN

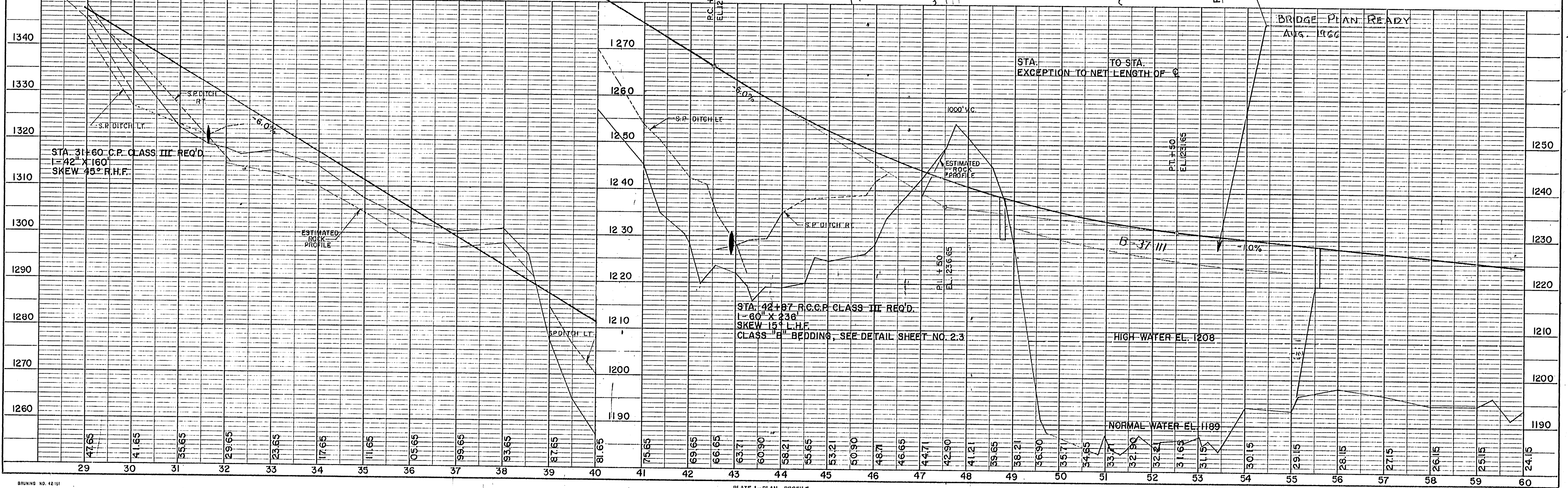
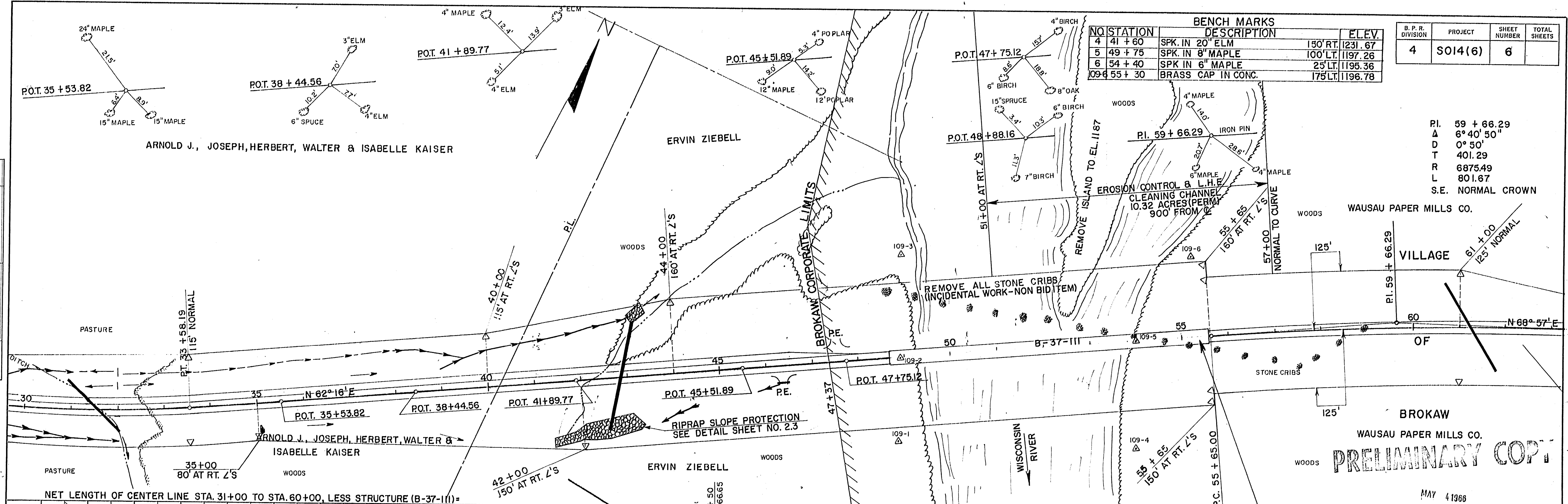

PLATE 1 - PLAN - PROFILE O. P. R. & R.E.
 MADE AND PRINTED IN U.S.A.

BENCH MARKS			
NO.	STATION	DESCRIPTION	ELEV.
7	64 + 65	N. BOLT ON HYD. COR. 4TH & EVEREST	1221.88

B. & R. DIVISION	PROJECT	SHEET NUMBER	TOTAL SHEETS
4	SO14(6)		

PLAN	SURVEYED	DATE
	PLOTTED	BY
	NOTE BOOK	L.J.W.
	NO. 47.67	N.L.D.
	ALIGNMENT CHECKED	
	BY	

PROFILE	SURVEYED	DATE
	GRADES CHECKED	BY
	NO. 1.1	N.L.D.
	STRUCTURE NOTATION	CH'ND

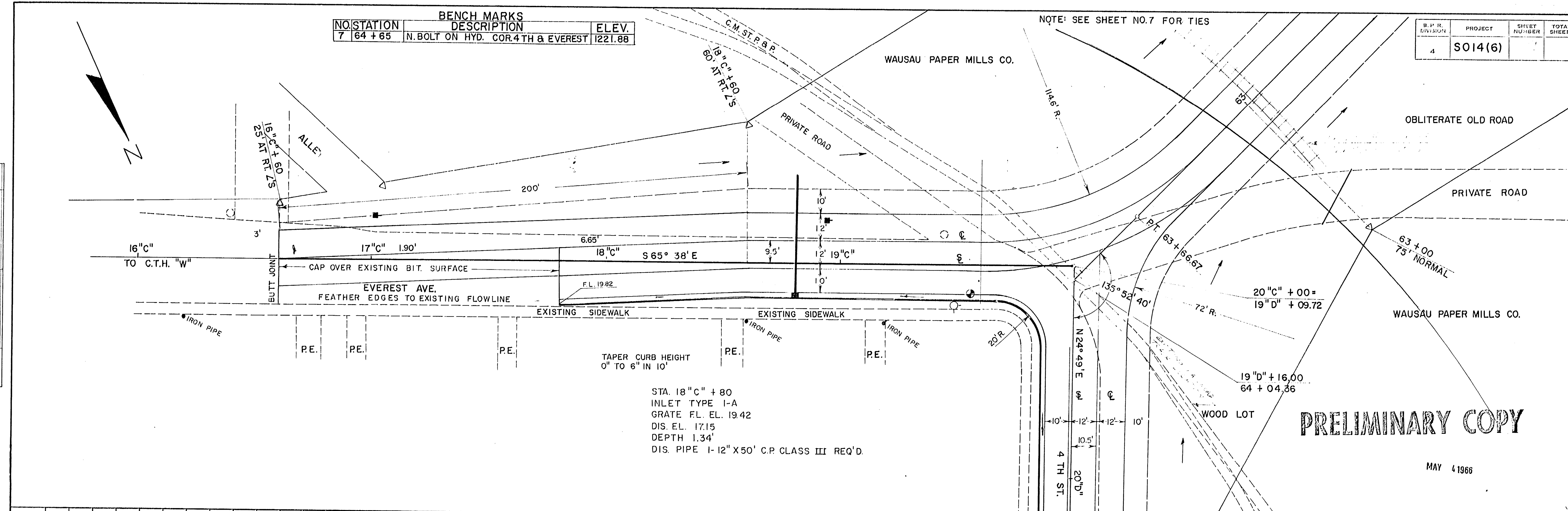

STA. 18 "C" + 80
 INLET TYPE 1-A
 GRATE F.L. EL. 19.42
 DIS. EL. 17.15
 DEPTH 1.34'
 DIS. PIPE 1-12" X 50' C.P. CLASS III REQ'D.

PRELIMINARY COPY

MAY 4 1966

